

05

Roadstar



Roadstar Luxury Motorhomes

At Lunar motorhomes we are delighted to have significantly increased our sales and production to help us to meet the ever-increasing demand for our product. This has been achieved by designing a product to meet the changing requirements of our customers whilst incorporating the most up to date equipment with state of the art technology. Sourcing equipment from top quality, household suppliers and utilising this to improve and enhance our product layouts is paramount to our success. Dometic fridges, Thetford toilets, Spinflo oven and hobs, Truma heaters, Technoform Italian furniture doors and Belgian designer fabrics are all top suppliers

used by Lunar to produce the Roadstar range. Being part of the Tirus group of companies, whose manufacturing facilities in Belgium, Holland, Sweden and the U.K. produce many thousands of caravans and motorhomes each year, gives us a combined knowledge and expertise in sourcing even the smallest component part.

Lunar have chosen the Fiat Ducato chassis cab with the 2.8JTD engine to provide the power for all the Roadstar models.



The spacious interior of the Roadstar 620



All our luxury motorhomes boast eye-catching graphics

This popular rear lounge model has subtle changes to the kitchen unit with a table storage facility and a new roof locker design. The contrasting shaped windows and the colour coded bumper and side skirts further enhance the stunning new exterior graphics. All Roadstar models still benefit from a one piece GRP roof section, rear end panel and high gloss impact resistant GRP sidewalls.



Roadstar 620

Roadstar 630



Stylish upholstery with smartly piped scatter cushions

The unique clever design of the Roadstar 630 provides a useful dressing area across the front from the shower to the wardrobe, a large rear lounge area and has an adventurous but convenient split kitchen. A large panoramic roof light, Omnivent roof fan, flyscreens and pleated blinds to all double glazed windows, 4 burner hob and full oven are only a fraction of the many features that are standard equipment in the Roadstar range.



Roadstar 630



Front exterior

Roadstar 720



The 720's practical, thoughtfully laid out kitchen area



The well appointed shower and washroom



Plenty of room in the storage, accessed from the outside



Rear exterior

A hugely impressive motorhome with a large separate shower and washroom layout at the rear, the Roadstar 720 combines space with a luxurious level of specification. The comfortable and attractive lounge layout is available in a choice of three soft furnishing schemes and converts quickly and easily into a sleeping area. The cleverly designed kitchen boasts a full oven, 4 burner hob unit, loads of storage space and the very latest 135 litre fridge with separate freezer compartment.

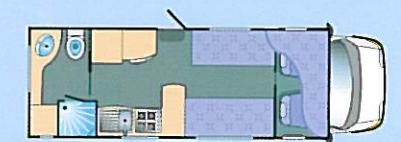

Roadstar 720

Roadstar 726



The spacious comfort and elegance of the rear lounge

One of the roomiest motorhomes built by Lunar, the superb 726 combines two separate seating areas, including a huge rear lounge which easily converts into a double bed and a front dinette with two lap and diagonal inertia reel seat belts to ensure child safety when travelling. An occasional table top to the rear drawer unit, designated TV viewing point and storage for both tables are some of the examples of our designers impeccable attention to detail.



Roadstar 726



Fully fitted kitchen

Roadstar 780



Ingeniously clever use of space with comfort in mind



The view seen by our competitors!

Flexible and uncompromising the Roadstar 780 offers six different front layouts from an offside sofa to a dinette, from a nearside cupboard unit to a lounge seat and all with a fixed rear bed. The fully equipped kitchen has a host of standard items including a full oven, omnivent fan, 4 burner hob and grill unit, 135litre fridge/freezer but still provides a more than adequate storage capacity.

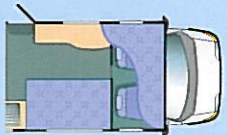

Roadstar 780S/SB

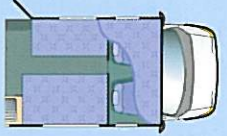

Roadstar 780SSB/TSB

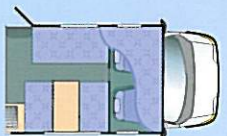

Roadstar 780NSB



Roadstar 780

Roadstar 786



The optional table adds luxury and practicality to our smart seating area



An astonishing amount of underfloor storage, accessed from both sides of the 780

The new flagship of the Roadstar range, this unique layout offers a separate shower cubicle in the rear toilet/shower area, a spacious front lounge with swivel drivers and passenger seats, a comfortable fixed bed and a large fully equipped centre kitchen. The attention to detail of our designers with the dual floor technology not only winterises the large fresh water tank and plumbing between the floors but also gives a vast amount of full width "basement" locker storage accessible from both sides of the 786 and 780.



Roadstar 786

Chassis Specification

- Fiat 127 BHP 2.8JTD common rail direct injection with turbo and intercooler
- Power Steering
- Twin parabola halogen headlights
- Twin arm extra wide wing mirrors
- Locking fuel filler cap
- Heated electric door mirrors
- Drivers seat armrest and lumbar adjustment
- Height adjustable drivers seat
- Digital clock and trip computer
- 12v. socket on facia
- Central locking + electric windows
- Radio with CD player
- Writing surface complete with bookrest and clipboard
- Camping car suspension system (up-rated springs and tyres)
- New stylish wheel trims
- Optional alloy wheels
- Removable cab carpets
- Al-Ko galvanised chassis (720,726,780 and 786)
- Standard Fiat chassis (620 and 630)

Exterior Specification

- Side reversing docking lights
- High gloss impacts resistant glass fibre sides and rear wall
- One-piece GRP roof and rear panel with high level brake light
- Colour co-ordinated GRP side skirts and front bumper
- Exterior access storage locker
- Vast full width basement lockers between the two floors.
- New one piece exterior door with flyscreen
- Mini garage storage in 780
- New spare wheel storage in 780
- Gas locker storage for two 7kgs bottles
- New fitted gas regulator
- Rear corner steadies
- New acrylic double glazed windows (excl. cab) with shaped side windows
- New flyscreen and pleated blinds to all windows (excl.cab)
- Large panoramic rooflight with flyscreen and pleated blind
- New shaped side windows in Luton overcab bed
- Fully insulated walls, floor and ceiling
- Insulation approved to EN1646-1 classification 2 for operation in low ambient temperatures
- Electrically operated foldaway step
- Automatic step retraction when ignition started

- Awning light
- Exterior 12v. socket and pump alongside water filler
- One key number to suit all conversion locks
- TV aerial and booster
- New exterior graphics and decals
- Roof rack and ladder

Kitchen Specification

- Easily operated lever action single pillar kitchen tap
- Stainless steel sink and drainer
- Colour-keyed thermostatically controlled oven, 4 burner hob and grill
- Flame failure device and spark ignition to hob, grill and oven
- Dometic 135litre gas/12v/230v. Fridge/freezer (720, 780, 786)
- Dometic 86 litre gas/12v/230v. Fridge with full width freezer compartment (620, 630, 726)
- Isolation taps for gas appliances
- Fresh water filter to kitchen tap
- Omnivent combined rooflight and powered extractor fan
- Semi-rigid fresh water pipes
- Plastic coated cup and plate rack

Bathroom specification

- Large washroom vanity unit with ample storage
- Separate taps serving the shower and wash hand basin
- Thetford cassette toilet with 12v. electronic flush
- Vanity storage cabinets
- Towel and toilet roll holders
- Bathroom window with flyscreen and blind
- Shower tray mat (excl.720, 786)
- Self priming pressure pump with surge damper

Electrical Specification

- Truma 3002 3kw gas heating system with ducted blown air
- Truma 2kw electric blown air heating
- Truma gas/230v water heating
- Low level doorstep light
- Remote doorway switch for one ceiling light
- 12v reading lights
- 12v TV socket
- Mains input to RCCD plus 230v sockets
- Mains electric charger/transformer
- Battery condition indicator and meter
- Internal and external digital temperature guide
- Auxiliary battery with split-charger relay (85amps)
- 12v digital clock

Internal Specification

- Flyscreen and blinds to all opening windows (excl. cab)
- Slatted bed box tops allowing easy access to underbed storage
- Drop flap access to underbed storage lockers
- Large handle grip at entrance door
- Dedicated table storage
- 2 Drawer chest of drawers with slide out top for occasional coffee table (620, 630 and 726 models)
- Italian designed stylish curved furniture doors
- Restyled kitchen roof lockers
- Hardwood edged heat resistant tabletops and work surfaces
- Swivel passenger seat base
- Swivel drivers seat base (720, 726SB, 780SB, 780SSB, 780TSB, 786)
- Free standing table
- Large fresh water tank 109 litres
- Waste water tank 73 litres
- Fresh and waste water tank gauges
- Water system drainage
- Bunk ladder to all over cab beds
- Speaker wires for radio fitted to rear lockers
- Road-Pro cable fitted as standard through roof panel for reversing camera

Soft Furnishing Specification

- Sprung interior base mattresses to all seating areas (not over cab)
- Choice of three soft furnishing schemes with Belgian designer fabrics and matching curtains
- Scatter cushions
- Trimmed cab seats with map pockets
- Over cab safety net
- Bound edge loose carpets
- Parquet style cushioned floor covering
- Removable cab carpet with heel pads
- Full-length cab curtains
- Insulated cab screens
- Easy action slide out bed conversion (720, 726SB, 780SB, 780TSB, 786)

Additional Specification

- Comprehensive three year warranty
- SMMT and National Caravan Council approved
- Compliance with European standards
- Two lap and diagonal inertia reel seat belts fitted (720E, 726, 780, 780NSB)

Roadstar features

Models	Roadstar 620	Roadstar 630	Roadstar 720	Roadstar 726	Roadstar 780	Roadstar 786
Overall Length	6.45m / 21'3"	6.45m / 21'3"	7.32m / 24'0"	7.32m / 24'0"	7.84m / 25'9"	7.84m / 25'9"
Overall Width	2.22m / 7'3"	2.22m / 7'3"	2.22m / 7'3"	2.22m / 7'3"	2.22m / 7'3"	2.22m / 7'3"
Overall Height	3.13m / 10'3"	3.13m / 10'3"	3.13m / 10'3"	3.13m / 10'3"	3.13m / 10'3"	3.13m / 10'3"
Internal Height	2.05m / 6'9"	2.05m / 6'9"	2.05m / 6'9"	2.05m / 6'9"	1.92m / 6'4"	1.92m / 6'4"
Mass in Running Order	2850kg*	2850kg*	3024kg	3084kg	3336kg	3255kg
Maximum Authorised Mass	3400kg	3400kg	3500kg	3500kg	3850kg	3850kg
Fresh Water Tank	109 litre	109 litre	109 litre	109 litre	109 litre	109 litre
Waste Water Tank	73 litre	73 litre	73 litre	73 litre	73 litre	73 litre
Designated Passenger Seats (with three point seat belts)	1	1	1	3	3	1
Overcab Double Bed	2.14m x 1.25m 7'0" x 4'1"	2.14m x 1.25m 7'0" x 4'1"	2.14m x 1.25m 7'0" x 4'1"	2.14m x 1.25m 7'0" x 4'1"	2.14m x 1.25m 7'0" x 4'1"	2.14m x 1.25m 7'0" x 4'1"
Double Bed	2.14m x 1.48m 7'0" x 4'10"	2.14m x 1.48m 7'0" x 4'10"	1.83m x 1.22m 6'0" x 4'0"	2.14m x 1.48m 7'0" x 4'10"	1.83m x 1.22m 6'0" x 4'0"	2.14m x 1.22m 7'0" x 4'0"
or Other Berths	2 Singles 1.88m x 0.75m 6'2" x 2'5"	2 Singles 1.88m x 0.75m 6'2" x 2'5"	1 Single 1.83m x 0.72m 6'0" x 2'4"	Double 1.83m x 1.26m 6'0" x 4'2"	Fixed Double 1.88m x 1.40m 6'2" x 4'7"	Fixed Bed 1.83m x 1.40m 6'0" x 4'7"
Single Berths			1 Single 1.75m x 0.68m 5'9" x 2'3"	2 Singles 1.88m x 0.75m 6'2" x 2'5"		

Mass in Running Order is equivalent to the unladen ex-works weight of the vehicle, plus 90% of the fuel, plus 75 kg for the driver

*ESTIMATED



'Arizona' fabric



'Coventry' Red fabric



'Soft' fabric



Fly screens and pleated blinds to all double-glazed windows



Omnivent, 3 way, 2 speed extractor fan



Side reversing docking light



Stylish wheel trims



Colour co-ordinated bumper

Three Year Warranty

The coachbuilt elements of all Roadstar models are covered by a comprehensive 3 year warranty, guarding against delamination and leakage in the main body, structure and flooring.

The warranty cover is provided by Lunar for the first 12 months and MG & B for the following 24 months and is subject to an annual chargeable service by an authorised Lunar dealer

Fiat Reliability and Quality

Lunar have selected the excellent Fiat Ducato 2.8JTD as a base vehicle for their Roadstar motorhomes because of its continued reliability and attractive modern styling. The Ducato has a 24 months manufacturers warranty and MG & B provide a further 12 months cover. Full details of this cover are outlined in our policy document available at all authorised Lunar motorhome dealerships.



Sherdley Road • Lostock Hall • Preston • Lancashire PR5 5JF
Telephone: 01772 337628 • Fax: 01772 627722

www.lunarcaravans.com



The contents of this brochure are as accurate as possible at the time of going to print - April 2004. Lunar Caravans Limited reserve the right to alter materials, specifications, price and model ranges as conditions demand. It should be noted that distributors and dealers are not the agents of Lunar Caravans Ltd and therefore are not authorised to bind the Company by any specific or implied undertaking or representation. ©2004 Lunar Caravans Ltd.

Designed and produced by Creative Marketing Solutions 015242 64940