

**YOUR 1ST CHOICE FOR
MORE CHOICE**

- ✓ OVER 300 CARAVANS ON SHOW
- ✓ INDOOR & SEASONAL OUTDOOR CAMPING DISPLAY
- ✓ AWNING DISCOUNT CENTRE
- ✓ ACCESSORIES SUPERMARKET
- ✓ 5 STAR SERVICE CENTRE & REPAIR WORKSHOPS
- ✓ FINANCE & INSURANCE (SUBJECT TO STATUS)

**GUARANTEED A
WARM WELCOME**

HIGHBRIDGE

Caravan and Camping Centre

OPEN 7 DAYS
A WEEK

01278 782725

A38, BRISTOL RD, HIGHBRIDGE, SOMERSET, TA9 4EX
www.highbridgecaravans.co.uk



 **LUNAR**

Lightweight touring technology for 2006.

- 2** The Lunar landscape in 2006.
- 3** Thoughtful features that make Lunar special.
- 5** Ariva 2 berth
Narrower and lighter than ANY of its rivals, Ariva has led the way in compact touring luxury since its introduction.
- 7** Zenith 4, 5 and 6 berth
A great value, lightweight with a choice of family berth options to meet every need.
- 9** Stellar 2 berth
Compact in size and easy to manage, yet amazingly roomy.
- 11** Quasar 2, 4, 5 and 6 berth
Exceptional value, light in weight and packed with quality features.
- 13** Lexon 2, 4 and 5 berth
The innovative Lexon uses its extra width and specially developed interior layout to spectacularly spacious effect.
- 15** Clubman 2 and 4 berth
The appeal of the Clubman's classic styling and craftsman built quality make them our much envied flagship range.
- 17** Delta 2 and 4 berth
The superb Delta series apply Lunar design and Clubman quality to create an innovative caravan with great looks and a specification to match.
- 19** Features
A complete breakdown of the impressive range of features for every caravan in the Lunar range.
- 21** Specification tables
- 26** Weightlessness
The story of Lunar's most renowned and unique feature.
- 27** Lunar 2006 at a glance



The 2006 Lunar landscape.

Building on over 35 years as the leaders in lightweight touring technology, Lunars 2006 caravan collection is simply superb.

New layouts, intelligent design and high quality fittings and furnishings are matched with smooth, external styling in a package that is famously much lighter than any of our rivals.

From the compact comfort of our Ariva right up to the luxurious twin-axled Delta, there's a Lunar that's ideal for every caravanner, each one great value, easier to tow and a real pleasure to own.

The 2006 range heralds the introduction of new larger fridges, bigger and better work surfaces and fresh new washrooms, plus a host of specification upgrades and new equipment for every caravan.

We are particularly proud of our cabinet work with its new curved doors... Attention to detail is everywhere, whilst the subtle curves and angles we use create spacious, pleasing, eminently comfortable interiors.

Of course this brochure can only offer you a taste of Lunar quality. With so many great reasons to choose Lunar it's time you paid a visit to one of our national network of dealers, and with 22 models in seven ranges to choose from we know there's a superb lightweight Lunar that's perfect for you.

Pictured: The superb kitchen area of the Delta 540 [A] typifies Lunar design and luxury, note the thicker worktops and smart new laminate finishes introduced for many models across the range in 2006. High quality fittings such as this stylish domestic style tap [B] are found in every Lunar. The flip and slide table on easy running ball bearings is a new introduction for every 2006 Lunar [C]. The new quick release Al-Ko spare wheel carrier is another invaluable, lightweight addition found on many Lunar models in 2006 [D]. A quality fitted microwave features in every Clubman and Delta [E], whilst Lunar's stylish alloy wheels [F] are a luxury that you'd have to pay extra for on your car!

Cutting weight without compromising on quality ...Even in the hidden detail, quality and lightness remain the watchwords; the Poplar ply and Obeche hardwood [G] used in every Lunar offer substantial weight savings over the heavier alternatives used by most manufacturers. Further information on Lunar's impressive lightweight credentials can be found at the back of this brochure.

Thoughtful features that make every Lunar special.

From the entry level Zenith, through the innovative wide bodied Lexon and up to the magnificent Deltas EVERY Lunar is special. Thoughtful attention to detail has always been at the core of the Lunar ideal.

For many 'light in weight' might mean cutting corners, in a Lunar we only cut the kilos by using high quality materials that are exceptionally strong, whilst putting special emphasis on use of top quality fixtures, fittings and features.

A full list of the features of each Lunar model can be found at the back of this brochure, however a visit to one of our national network of dealers is essential to fully appreciate the quality and detail that makes every Lunar model something special.

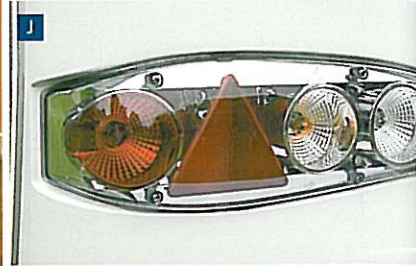

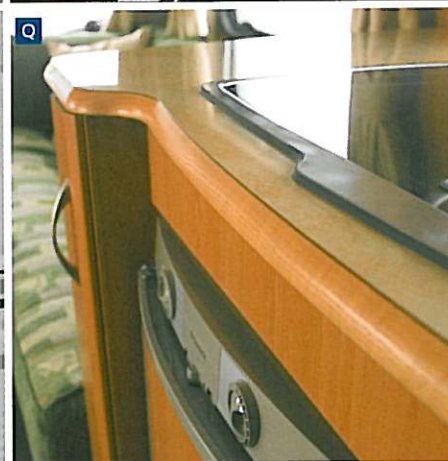
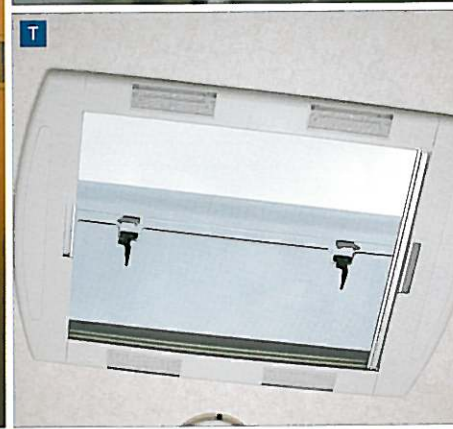

Opposite page

- A** CD Radio with MP3 player featured in Clubman and Delta models.
- B** Chunky, rugged locker hinges - solid quality that typifies Lunar fittings.
- C** The new door retaining catch is secure and practical.
- D** Beefy bedding supports ensure a comfortable night's sleep.
- E** High level spoiler mounted brake light, an important safety feature.
- F** 2006 sees the introduction of brighter, more spacious washrooms, an excellent example is that of the redesigned washroom of the Quasar EB and Lexon EB.
- G** Bed box storage, totally accessible with sliding tops and drop fronts.
- H** Easy slide drawers on every Lunar.
- I** Awning light with integral spotlight - a typically thoughtful, attractively designed and practical feature that's fitted to Clubmans and Deltas.
- J** Smart light clusters are a feature of most Lunar models.
- K** The craftsman made close fit curved wooden doors with high quality furniture handles featured in all Lunars.
- L** Innovative features, like the vegetable rack in Delta 640 and Clubman 475 CK and 530 models, make maximum use of a Lunars already ample storage space.



This page

- M** High quality shower units are a feature of every Lunar.
- N** The useful external mains socket fitted to every model, excluding the Ariva and Zeniths.
- O** Deltas and Clubmans feature a directable TV aerial as standard.
- P** This attractive frosted shower door lends a bright roominess to Lexon 640.
- Q** Lunar's graceful curved furniture pleases the eye the unique curved fridge door.
- R** Hitch cover, also showing the AKS stabiliser.
- S** The gas regulator which is a factory fitted standard item on EVERY Lunar.
- T** The slide and tilt sunroof is a popular feature across Lunar's ranges.
- U** The powerful 3 speed, 2 way roof extractor that's fitted to every model excluding the Ariva and Zeniths.



Ariva

Narrower and lighter than ANY of it's rivals, the luxurious Ariva is totally unique in its class, offering serious caravanning luxury in an easy to handle, lightweight body.

The Ariva's clever design utilises a classic rear-end kitchen layout with a large Dometic fridge featuring a full width freezer that's ideal for storing those little indulgences. Combining features like the attractive curved, integrated roof lockers that offer ample storage and the swivel toilet in the surprisingly large, light shower room, the Ariva delivers top specification in an amazingly spacious compact package.

For the adventurous tourer, this roomy model is also ideal for year-round caravanning. Ample insulation and a powerful gas/electric room heater with ducted blown air ensure the Ariva stays snug in the coldest weather.

Ariva in 2006

- Dometic 7 series fridge.
- Easily accessible water heater and room heater controls.
- Striking new green and silver exterior striping.
- New high quality furniture handles.
- Thicker, chunky work surfaces.
- New exterior door retaining catch.
- Stylish slimline electrical points.
- New bedside cabinet design featuring smooth gliding runners.





Zenith

Our great looking Zenith models are fantastic value for the whole family. With an excellent specification, the four, five and six berth layouts are all on single axles and readily towable by a variety of family saloon cars.

In this season's models, the work surfaces have been redesigned and enlarged, the high quality Dometic fridge, already a popular feature of other Lunars, has now also been utilised in the Zenith range. The bright, airy washroom areas also help make the new 2006 series more desirable than ever before.

The Zenith: Remarkable comfort and quality in the Four, the entry level model in a range that's already extremely popular with new touring enthusiasts [A]. Zenith Six [B] features fixed end bunks, making it a sure-fire winner with families with youngsters. The Zenith Four [C], focussing on the well lit, smart, practical kitchen layout that's ideal for the modern touring family.

Zenith in 2006

- Deep comfort soft furnishing construction and new fabric.
- Even bigger work surfaces.
- Attractive circular sink bowl with separate draining board.
- Awning light.
- Large tilt-and-slide sunroof.
- Gas and electric blown air heating system.
- Flyscreen for door.
- Shaped side windows.
- Smooth gliding domestic style drawer runners.
- Spark ignition gas hob.
- Built-in gas regulator.





Stellar

Lunars award winning Stellar was especially created to deliver an unrivalled and invaluable level of spaciousness in a luxurious caravan of an easily manageable wide bodied, compact size.

The Stellar has an attractive rear-offside kitchen set off by new 'Kirsch' coloured woodwork and wallboard that is complemented by the beautiful styling of the natural wood framed roof locker doors.

Building on this highly popular model a host of further features have been added in 2006 to deliver an ultra-high specification caravan that is the intelligent choice for discerning couples.

The Stellar: The compact, comfortable seating area [A]. The smart new co-ordinated master switches [B] for heating and lighting. The kitchen [C] is located at the rear of the Stellar with its redesigned locker layout and extra lighting is a perfect example of intelligent Lunar design know-how.

Stellar in 2006

- Dometic 7 series fridge featuring shaped door panel and an enlarged 81 litre capacity.
- Striking new green and silver exterior striping with new matching graphics.
- Attractive new 'Kirsch' furniture board.
- New high quality furniture handles.
- Thicker, chunky work surfaces with new laminate design.
- New kitchen locker area featuring open shelving.
- Additional light over kitchen work surfaces.
- New exterior door retaining catch.
- Stylish slimline electrical points.
- New bedside cabinet design featuring smooth gliding runners.
- 14" Alloy wheels.
- Spare wheel carrier.
- Receiver for Al-Ko Secure.





Quasar

Already into its third season, the Quasar's emphasis on providing more features, more value, more luxury and LESS weight has proved to be an outstanding success for Lunar.

The natural wood framed locker doors are complemented by the newly enlarged Dometic 93 litre fridge and AKS Stabiliser system that is standard across the range, as well as a host of other smart, intelligent features that are the hallmark of the classic Lunar caravan.

A key to Quasar's success has been the sheer variety of layouts on offer. Models range from 2 berth right up to 6 berths, single to twin axle, each one boasting the incredible lightness that puts every Lunar out in front.

2006 heralds the introduction of another great Quasar, the family oriented FB. Boasting six berths and a large end washroom with a separate shower, this layout is attractively priced and will be extremely popular. 2006 also welcomes new, larger washrooms, each with a separate shower compartment in the Quasar 525 and 615 - a sure-fire winner at bathroom rush hour in these excellent family-oriented models!

Quasar in 2006

- Dometic 7 series fridge featuring shaped door panel and enlarged 93 litre capacity.
- Striking new burgundy and silver exterior striping with new matching graphics.
- New high quality furniture handles.
- Thicker, chunky work surfaces with new laminate design.
- New soft furnishing construction and 'Ontario' fabric.
- New exterior door retaining catch.
- Stylish slimline electrical points.
- New bedside cabinet design featuring smooth gliding runners.
- 14" Alloy wheels.
- Spare wheel carrier.
- Spring assisted access to storage in fixed bed models.
- Receiver for Al-Ko Secure.
- New rear bedroom reading lights.

Quasar EB

- Shower door with matching wood infill panel and new shower tray in EB.
- Swivel Potti.

Quasar 525 and 615

- New wash hand basin in both the 525 and 615 models.
- Redesigned roomier washroom.
- Separate shower compartment.

The brand new Quasar FB

- This great model is brand new for 2006. Amongst its long and impressive list of features the twin axle design, stylish end washroom and ample 6 berth capacity are of special note.

Pictured: The Quasar 462 [A], a great value 2 berth offering luxurious comfort (note the real wood framing of the cabinetry) at a sensible price. Well laid out, quality washrooms [B] are a particular feature of Quasars. New for 2006, the 525 and 615 also have separate shower cubicles [C] that carry through the feeling of quality and style. The new Quasar FB 6 berth [D] offers fixed bunk comfort for the youngsters.





Lexon

Wider than most other caravans, the Lexon has developed into a range of unique layouts that fully maximise the additional space.

The Lexon EB remains a firm favourite among the fixed bed models, as does the twin-axled Lexon EW. However, the ultimate in spacious touring luxury has to be the Lexon 640 with its large walk around bed that gives a comforting sense of permanence.

In 2006 a combination of the new 'Kirsch' furniture board and co-ordinated laminates on the new thicker work surfaces add a warm ambience to this season's models, giving them an extra special appeal that welcomes you the moment you step inside. There are a host of other new features this year to further enhance the ever-popular Lexon range. Of particular note in several models is the additional space and light provided in the redesigned washroom area.

Pictured: The Lexon's wider body allows roomier layouts [A], the EB's fixed rear double bedroom features a redesigned separate washroom and shower. On closer inspection craftsmanship shines through [B] with quality soft furnishings, chunky colour co-ordinated worksurfaces and special touches like the curved face of the fridge door. The spacious feel resulting from increased width carries through to the welcoming seating area [C].

Lexon in 2006

- Dometic 7 series fridge featuring shaped door panel and an enlarged 93 litre capacity.
- Striking new green and silver exterior striping with new matching graphics.
- Attractive new 'Kirsch' furniture board.
- New high quality furniture handles.
- Thicker, chunky work surfaces with new laminate design.
- New soft furnishing construction and 'Castilla' fabric.
- New exterior door retaining catch.
- Stylish slimline electrical points.
- New bedside cabinet design featuring smooth gliding runners.
- 14" Alloy wheels.
- Spare wheel carrier.
- Spring assisted access to storage in fixed bed models.
- Receiver for Al-Ko Secure.
- New bedroom reading lights.

Lexon EB

- Shower door with matching wood infill panel and new shower tray.
- Swivel Potti.
- Redesigned roomier shower area.
- New bedroom reading lights.

Lexon 640

- New bedroom vanity.
- New shower door.
- New purpose-designed locker unit to accommodate microwave.

Lexon CS and DS

- Redesigned roomier washroom area.

Lexon EW

- New purpose-designed locker unit to accommodate microwave.





Clubman

The special combination of superb quality, style and traditional appeal has ensured that the Clubman has built an enviable and enduring reputation amongst caravanners.

The Clubman's magnificently styled, close fitting craftsman made curved wood framed locker fronts help make 2006 models stand out as particularly special.

Of course all the features that have made this caravan so popular over the years remain, every model features a big 93 litre Dometic fridge with a unique curved door. The clear rooflight, bright washrooms, smart one-piece front and the very latest MP3 audio equipment combine to make the Clubman a truly comfortable leisure home from home.

The Clubman 470 combines all the luxury of an end washroom with those of an end kitchen, whilst the 475CK and 530-4 are hugely successful conventional layouts, but even more roomy due to the extra space provided by their 2.28m body width.

Clubman in 2006

- Spare wheel carrier.
- New natural wood framed roof locker doors.
- Receiver for Al-Ko Secure.
- New high quality furniture handles.
- New exterior door retaining catch.
- Stylish slimline electrical points.
- New soft furnishing construction.
- New bedside cabinet design featuring smooth gliding runners.

Clubman 530-4

- Two reading lights added for side bunks.
- New built-in microwave.

Clubman 470-2

- Re-designed kitchen locker area offering improved storage and even better looks.





Delta

An undoubted design classic, the Delta represents the peak of modern caravanning technology. The impressive profile, sleek panels and stylish light clusters are combined with the fresh 'Kirsch' woodwork and matching new laminate of the 2006 range to take that styling to another level. The 2006 addition of new style natural wood framed doors completes the appeal of a special décor that is practical, skillfully designed, well built and irresistibly appealing.

Elegant furniture curves draw the eye past the enlarged work surfaces and increased storage to alight on pleasing details; the large 93 litre fridge; the microwave oven, the cutting edge sound system with CD, radio and MP3 playing functions.

The unique single axle Delta 540 has a tastefully improved kitchen roof locker area whilst the sliding door into the capacious rear washroom is a further enhancement. The ultra-stable twin-axle 640EW features a microwave, an onboard water tank and a fixed double bed for total comfort.

You'll be concerned about security, we've taken care of that too with the 'Concept Kel' remote security system fitted to every Delta. Concept Kel combines alarm and panic button features and handy remote light operation.

Pictured: The Delta is the pinnacle of Lunar lightweight luxury, the 2 berth 540 (A B C) with its deep soft furnishings, rear washroom and splendid 'cook's' kitchen featuring built-in microwave is a masterpiece of modern caravan design.

Delta in 2006

- Striking new burgundy and blue exterior striping with new matching graphics.
- New high quality furniture handles.
- New natural wood framed roof locker doors.
- Attractive new 'Kirsch' furniture board.
- New exterior door retaining catch.
- Stylish slimline electrical points.
- New bedside cabinet design featuring smooth gliding runners.
- Spare wheel carrier.
- Receiver for Al-Ko Secure.
- New deep comfort soft furnishing construction and new fabric.
- Thicker, chunky work surfaces with new laminate design.

Delta 540-2

- Major rear washroom re-design, incorporating sliding door.
- Re-designed kitchen locker area offering improved storage and even better looks.



Features of the 2006 Lunar ranges

Model range	Zenith	Ariva	Stellar	Quasar	Lexon	Clubman	Delta
Special features							
Clear rooflight in washroom and over fixed beds	-	●	●	●	●	●	●
Lunar quartz clock	●	●	●	●	●	●	●
Lunar entrance tray and doormat	-	●	●	●	●	●	●
Smoke alarm	●	●	●	●	●	●	●
One key number fits all locks	●	●	●	●	●	●	●
Low-level night time courtesy light	-	-	-	-	-	●	●
Quality radio/CD with two speakers and MP3 player	-	-	-	-	-	●	●
Fitted radio housing, aerial and two speakers	-	-	●	●	●	-	-
Fully adjustable and directional Status 530 TV aerial	-	○	○	○	○	●	●
Fixed omni-directional Status TV aerial	-	●	●	●	●	-	-
Courtesy entry switch	-	●	●	●	●	●	●
Tilt and slide sunroof	●	●	●	●	●	●	●
CRIS identity etched onto windows	●	●	●	●	●	●	●
Hidden unique identity tag	●	●	●	●	●	●	●
Remote controlled 'concept Kel' alarm system	-	-	-	-	-	-	●
New receiver for Al-Ko Secure	-	-	●	●	●	●	●
Exterior							
New exterior colours and graphics	●	●	●	●	●	-	●
Stylish GRP front panel with specially designed flush fit windows	-	-	-	-	-	●	●
Aerodynamic acrylic capped ABS front panel	●	●	●	●	●	-	-
Stylish new one piece GRP rear panel	-	-	-	-	-	●	●
Rear roof spoiler featuring high level brake light	-	-	●	●	●	●	●
Stylish wrapround rear light clusters	-	-	●	●	●	●	●
Double glazed windows fitted with blinds and flyscreens throughout	●	●	●	●	●	●	●
Fully adjustable window stays with night latch ventilation position	●	●	●	●	●	●	●
Two part exterior door	●	●	●	●	●	●	●
Aircraft style liner for exterior door including storage pocket	-	●	●	●	●	●	●
Flyscreen to exterior door	●	●	●	●	●	●	●
Al-Ko galvanised steel chassis with one action easy handbrake	●	●	●	●	●	●	●

Model range	Zenith	Ariva	Stellar	Quasar	Lexon	Clubman
Exterior continued						
AKS 3004 stabiliser	-	-	-	●	●	●
Separate entrance step	●	●	●	●	●	●
External battery locker	●	●	●	●	●	●
External near side locker compartment	-	-	-	●	●	●
New 14" Alloy wheels	-	-	●	●	●	●
Underfloor spare wheel carrier	N/A	N/A	●	●	●	●
Stylish wheel trims	●	●	-	-	-	-
Shaped side and rear windows	●	●	●	●	●	●
High gloss aluminium	●	●	●	●	●	●
Pressurised water system with semi-rigid piping	●	●	●	●	●	●
Mud flaps	●	●	●	●	●	●
Fully insulated walls, floor and ceiling to grade II classification	●	●	●	●	●	●
Upgrade for larger payload [selected models]	○	-	○	○	○	○
New exterior door retainer	-	●	●	●	●	●
Plumbing and electrical						
Repositioned controls and switches	●	●	●	●	●	●
Truma gas and electric flued room heater with ducted blown air	●	●	●	●	●	●
Truma gas and electric flued water heater, fully plumbed in	●	●	●	●	●	●
Isolation taps for all gas appliances	●	●	●	●	●	●
Awning light ('S' with additional spotlight)	●	●	●	●	●	●5
Colour co-ordinated main sockets (minimum of 2)	●	●	●	●	●	●
25 metre mains connection lead	●	●	●	●	●	●
230v mains reading lights	●	●	●	●	●	●
Adjustable 12v spot reading lights	●	●	●	●	●	●
External mains socket	-	-	●	●	●	●
External barbecue point	-	-	●	●	●	●
12v charger/mains transformer	●	●	●	●	●	●
Mains inlet with ELCB protection	●	●	●	●	●	●
On-board 65 litre water tank	-	-	-	-	-	-

Key: ● Fitted as standard ○ Fitted as optional extra - NOT fitted to this range

Model range	Zenith	Ariva	Stellar	Quasar	Lexon	Clubman	Delta
Furniture							
Larger extended work surface	●	–	●	●	●	●	●
Natural wood framed roof locker doors	–	●	●	●	●	●	●
Shaped 2 drawer chest with pull-out coffee table	●	●	●	●	●	●	●
Split front bed seats for easy bed make up	●	●	●	●	●	●	●
Roll-out slats for double bed make-up	●	●	●	●	●	●	●
Scatter cushions (S) and bolster cushions (B)	2B	2S/2B	2S/4B	2S/4B	2S/4B	2S/4B	2S/4B
Bed ventilation boards to improve airflow and reduce condensation	–	●	●	●	●	●	●
Drop-flap access to front bed box storage	–	●	●	●	●	●	●
Slide-to-side bed slats, allowing unobscured storage access	–	●	●	●	●	●	●
New 'Kirsch' cherry furniture board	–	–	●	–	●	–	●
Colour matched worktop laminates	●	●	●	●	●	●	●
Integrated, curved roof locker designs	●	●	●	●	●	●	●
Dedicated table storage locker	●	–	●	●	●	●	●
Large freestanding table	●	●	●	●	●	●	●
Colour co-ordinated fittings, including ceiling lights, switches etc.	●	●	●	●	●	●	●
Long front lounge seats (6'2"/1.88m)	●	–	●	NOT EB	●	●	●
Kitchen and bathroom							
3 speed, 2 way extractor/rooflight	–	–	●	●	●	●	●
4 burners, grill and oven with spark ignition and flame failure device	●	●	●	●	●	●	●
Circular stainless steel sink with separate draining board	●	–	–	–	–	–	–
Easy to use lever action tap	●	–	●	●	●	●	●
7 series Dometic power fridge with full width freezer	M	M	E	E	E	E	E
Halogen downlighters over kitchen	●	●	●	●	●	●	●
Easy slide drawer runners	●	●	●	●	●	●	●
Fitted eye level microwave oven	–	–	–	–	–	●	●
Shower with dedicated controls	–	●	●	●	●	●	●
Fitted cassette toilet	●	●	●	●	●	●	●
Large window in washroom (selected models)	●	●	●	●	●	●	●

Extended peace-of-mind warranty

Lunars are famously well built and reliable, but for total peace of mind every caravan receives a full factory-backed 3 year warranty (subject to an annual service and inspection and excluding items subject to normal wear and tear).

Each Lunar model has been certified by the National Caravan Council for compliance with stringent European Standards, British Standards AND the industry set Codes of Practice that specifically relate to health and safety issues.

The approvals process covers the testing and inspection of all critical areas of the product from fire safety, weights and dimensions through to gas, electrics and ventilation. In order to ensure continuing compliance with their stringent standards, the NCC also carry out unannounced spot inspections at the factory.

Every caravan carries the 'NCC Approved Caravan' badge that gives you the peace of mind knowledge that your caravan's legal and safe.

Touring caravans are designated by the model year which runs from 1 September to 31 August. The despatch of 2006 models commences on 1 September 2005.



Soft furnishing choice

Lunar have carefully selected the standard soft furnishings for each model range. However for a small additional fee you may choose any soft furnishing combination from the 2006 range for your caravan. It should be noted that options are subject to availability and sufficient advanced notice. Ask your local Lunar dealer who'll be able to provide full details on this option.

MTPLM upgrade choice

In some Lunar models (those marked * in the specifications tables) the MTPLM (Maximum Technical Permissible Laden Mass - the total amount your caravan can carry on the road) can be increased with minimal disruption. Ask your local Lunar dealer who'll be able to provide full details on this option.

Important information on the MRO

The stated Mass in Running Order, 'MRO', includes a manufacturer's tolerance that reflects the varying individual weights of component parts. It is anticipated that the stated figure will NEVER be exceeded in the standard ex-works specification.

Layout choice

The option of a 'L' front layout is available for most Lunar models (excluding Ariva, Zeniths and the Quasar EB). Selection of the 'L' option gives a long offside picture window and floor cabinet and a 2.01 x 1.23m (6'7" x 4'0") double bed.

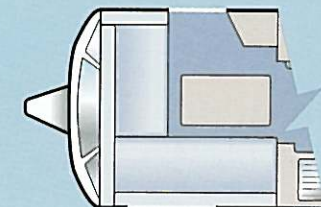

2006 Lunar specifications

Ariva

		Ariva
Internal body length		3.63m/11'11"
Overall length		5.17m/16'11"
Internal body width		1.90m/6'3"
Overall width		2.02m/6'7"
Maximum internal height		1.90m/6'3"
Overall height		2.65m/8'8"
Tyre size		185 R14
Coupling height		440mm/17"
Mass in running order		800 kg
Total user payload		200 kg
MTPLM		1000kg
Bed sizes	Double	1.90m x 1.43m 6'3" x 4'8"
	2 x Single	1.83m x 0.66m 6'0" x 2'2"
Awning guide (check with supplier)		790cm

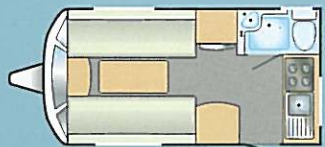

Ariva

Zenith

		Zenith Four	Zenith Five	Zenith Six
Internal body length		4.63m/15'3"	5.30m/17'5"	5.79m/19'0"
Overall length		6.10m/20'0"	6.82m/22'4"	7.26m/23'9"
Internal body width		2.04m/6'8"	2.04m/6'8"	2.04m/6'8"
Overall width		2.16m/7'1"	2.16m/7'1"	2.16m/7'1"
Maximum internal height		1.90m/6'3"	1.90m/6'3"	1.90m/6'3"
Overall height		2.48m/8'1"	2.48m/8'1"	2.48m/8'1"
Tyre size		175 R13 8 ply	175 R13 8 ply	175 R13 8 ply
Coupling height		440mm/17"	440mm/17"	440mm/17"
Mass in running order		945 kg	1005 kg	1060 kg
Total user payload		205 kg	235 kg	290 kg
MTPLM*		1150 kg*	1240 kg*	1350 kg
Bed sizes	Double	2.01m x 1.48m 6'7" x 4'10"	2.01m x 1.48m 6'7" x 4'10"	2.01m x 1.48m 6'7" x 4'10"
	2 x Single	1.88m x 0.69m 6'2" x 2'3"	1.88m x 0.69m 6'2" x 2'3"	1.88m x 0.69m 6'2" x 2'3"
Rear Sggle/Dble		2.01m x 0.62m 6'7" x 2'0"	2.01m x 1.29m 6'7" x 4'3"	2.04m x 0.61m 6'8" x 2'0"
Rear Top Bunk		1.98m x 0.53m 6'6" x 1'9"	1.98m x 0.56m 6'6" x 1'10"	
Side Single				1.83m x 0.65m 6'0" x 2'1"
Side Top Bunk				1.76m x 0.57m 5'10" x 1'11"
Rear Top Bunk				2.04m x 0.58m 6'8" x 1'11"
Awning guide (check with supplier)		875cm	950cm	1000cm



Zenith Four



Zenith Five

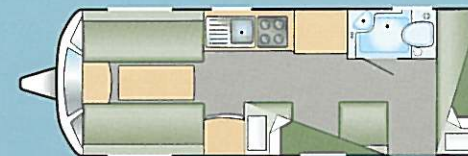

Zenith Six

Stellar

		Stellar
Internal body length		4.20m/13'9"
Overall length		5.60m/18'4"
Internal body width		2.16m/7'1"
Overall width		2.28m/7'6"
Maximum internal height		1.90m/6'3"
Overall height		2.65m/8'8"
Tyre size		185 R14
Coupling height		440mm/17"
Mass in running order		960 kg
Total user payload		240 kg
MTPLM*		1200kg*
Bed sizes	Double	2.10m x 1.48m 6'11" x 4'10"
	2 x Single	1.88m x 0.74m 6'2" x 2'5"
Awning guide (check with supplier)		839cm

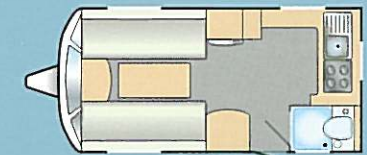

Stellar

Quasar

	Quasar 462	Quasar EB	Quasar 524	Quasar 525	Quasar 566	Twin Axle FB	Twin Axle 615
Internal body length	4.69m/15'5"	5.23m/17'1"	5.30m/17'5"	5.30m/17'5"	5.79m/19'0"	6.44m/21'1"	6.13m/20'1"
Overall length	6.16m/20'2"	6.70m/21'10"	6.82m/22'4"	6.82m/22'4"	7.26m/23'10"	7.82m/25'8"	7.64m/25'1"
Internal body width	2.04m/6'8"	2.04m/6'8"	2.04m/6'8"	2.04m/6'8"	2.04m/6'8"	2.04m/6'8"	2.04m/6'8"
Overall width	2.16m/7'1"	2.16m/7'1"	2.16m/7'1"	2.16m/7'1"	2.16m/7'1"	2.16m/7'1"	2.16m/7'1"
Maximum internal height	1.90m/6'3"	1.90m/6'3"	1.90m/6'3"	1.90m/6'3"	1.90m/6'3"	1.90m/6'3"	1.90m/6'3"
Overall height	2.65m/8'8"	2.65m/8'8"	2.65m/8'8"	2.65m/8'8"	2.65m/8'8"	2.65m/8'8"	2.65m/8'8"
Tyre size	185 R14 8 ply	185 R14 8 ply	185 R14 8 ply	185 R14 8 ply	185 R14 8 ply	175 R14	175 R14
Coupling height	440mm/17"	440mm/17"	440mm/17"	440mm/17"	440mm/17"	440mm/17"	440mm/17"
Mass in running order	990 kg	1090 kg	1070 kg	1090 kg	1145 kg	1265 kg	1250 kg
Total user payload	210 kg	210 kg	230 kg	260 kg	255 kg	335 kg	250 kg
MTPLM*	1200 kg *	1300 kg*	1300 kg*	1350 kg	1400 kg	1600 kg	1500 kg*
Bed sizes	Double	2.01m x 1.48m 6'7" x 4'10"	2.01m x 1.48m 6'7" x 4'10"	2.01m x 1.48m 6'7" x 4'10"	2.01m x 1.48m 6'7" x 4'10"	2.01m x 1.48m 6'7" x 4'10"	2.01m x 1.48m 6'7" x 4'10"
	or						
	2 x Single	1.88m x 0.69m 6'2" x 2'3"		1.88m x 0.69m 6'2" x 2'3"	1.88m x 0.69m 6'2" x 2'3"	1.88m x 0.69m 6'2" x 2'3"	1.88m x 0.69m 6'2" x 2'3"
Single			1.83m x 0.60m 6'0" x 2'0"		side single 1.83m x 0.60m side single 6'0" x 2'0"	side single 1.83m x 0.60m side single 6'0" x 2'0"	1.83m x 0.74m 6'0" x 2'5"
Side bunk					1.76m x 0.56m 5'10" x 1'10"	1.76m x 0.56m 5'10" x 1'10"	
Double		1.93m x 1.33m 6'4" x 4'4"		2.01m x 1.29m 6'7" x 4'3"			
Bunk			1.76m x 0.56m 5'10" x 1'10"	1.98m x 0.56m 6'6" x 1'10"	upper 1.76m x 0.58m upper 5'10" x 1'11"	1.74m x 0.64m 5'8" x 2'1"	1.83m x 0.64m 6'0" x 2'1"
					lower 1.76m x 0.60m lower 5'10" x 2'0"		
Awning guide (check with supplier)	890cm	930cm	940cm	940cm	1000cm	1055cm	1030cm

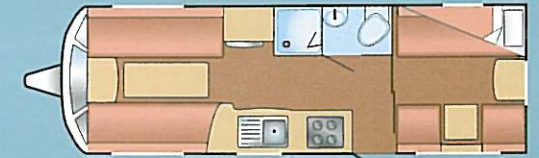

Quasar 615 Twin Axle

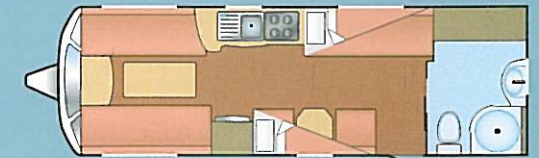

Quasar FB Twin Axle

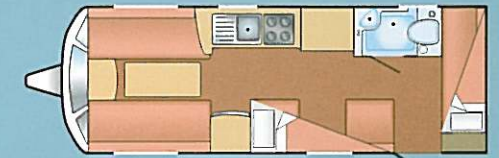

Quasar 566

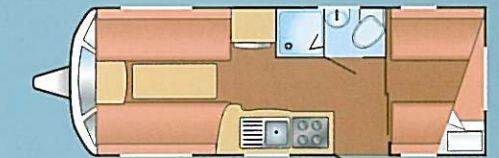

Quasar 525



Quasar 462



Quasar EB



Quasar 524

Lexon

		Lexon EB	Lexon CS	Lexon DS	Twin Axle EW	Twin Axle 640
Internal body length		5.56m/18'2"	5.80m/19'0"	5.80m/19'0"	6.44m/21'1"	6.44m/21'1"
Overall length		7.03m/23'1"	7.26m/23'10"	7.26m/23'10"	7.82m/25'8"	7.82m/25'8"
Internal body width		2.16m/7'1"	2.16m/7'1"	2.16m/7'1"	2.16m/7'1"	2.16m/7'1"
Overall width		2.28m/7'6"	2.28m/7'6"	2.28m/7'6"	2.28m/7'6"	2.28m/7'6"
Maximum internal height		1.90m/6'3"	1.90m/6'3"	1.90m/6'3"	1.90m/6'3"	1.90m/6'3"
Overall height		2.65m/8'8"	2.65m/8'8"	2.65m/8'8"	2.65m/8'8"	2.65m/8'8"
Tyre size		185 R14 8 ply	185 R14 8 ply	185 R14 8 ply	175 R14	175 R14
Coupling height		440mm/17"	440mm/17"	440mm/17"	440mm/17"	440mm/17"
Mass in running order		1170 kg	1180 kg	1190 kg	1340 kg	1275 kg
Total user payload		230 kg	220 kg	210 kg	260 kg	325 kg
MTPLM		1400 kg *	1400 kg *	1400 kg *	1600 kg	1600 kg
Bed sizes	Double	2.10m x 1.48m 6'11" x 4'10"	2.10m x 1.48m 6'11" x 4'10"	2.10m x 1.48m 6'11" x 4'10"	2.10m x 1.48m 6'11" x 4'10"	2.10m x 1.48m 6'11" x 4'10"
	2 x Single	1.88m x 0.74m 6'2" x 2'5"	1.88m x 0.74m 6'2" x 2'5"	1.88m x 0.74m 6'2" x 2'5"	1.88m x 0.74m 6'2" x 2'5"	1.88m x 0.74m 6'2" x 2'5"
	Bunk			2.10m x 0.56m 6'10" x 1'10"		
	Double	1.93m x 1.45m 6'4" x 4'9"	1.93m x 1.34m 6'4" x 4'5"	2.10m x 1.37m 6'10" x 4'6"	1.89m x 1.37m 6'2" x 4'6"	1.88m x 1.39m 6'2" x 4'7"
Awning guide [check with supplier]		970cm	990cm	990cm	1055cm	1055cm

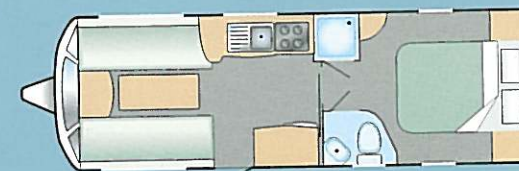

Lexon 640 Twin Axle

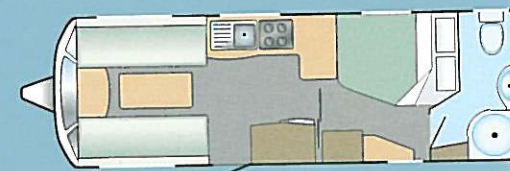

Lexon EW Twin Axle

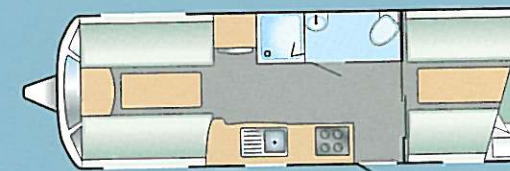

Lexon DS



Lexon EB

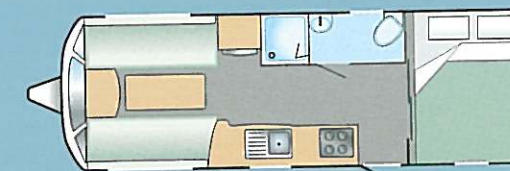

Lexon CS

Clubman

	Clubman 470-2	Clubman 475 CK	Clubman 530-4
Internal body length	4.80m/15'9"	4.80m/15'9"	5.30m/17'5"
Overall length	6.25m/20'6"	6.25m/20'6"	6.82m/22'4"
Internal body width	2.16m/7'1"	2.16m/7'1"	2.16m/7'1"
Overall width	2.28m/7'6"	2.28m/7'6"	2.28m/7'6"
Maximum internal height	1.90m/6'3"	1.90m/6'3"	1.90m/6'3"
Overall height	2.65m/8'8"	2.65m/8'8"	2.65m/8'8"
Tyre size	185 R14 8 ply	185 R14 8 ply	185 R14 8 ply
Coupling height	440mm/17"	440mm/17"	440mm/17"
Mass in running order	1110 kg	1080 kg	1150 kg
Total user payload	240 kg	220 kg	200 kg
MTPLM*	1350 kg *	1300 kg*	1350 kg
Bed sizes	Double	2.10m x 1.48m 6'11" x 4'10"	2.10m x 1.48m 6'11" x 4'10"
		or	or
	2 x Single	1.88m x 0.74m 6'2" x 2'5"	1.88m x 0.74m 6'2" x 2'5"
	Single		1.83m x 0.60m 6'0" x 2'0"
Bunk			1.76m x 0.56m 5'10" x 1'10"
Awning guide [check with supplier]	895cm	895cm	950cm

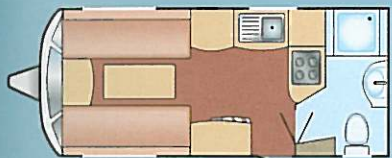

Clubman 470-2

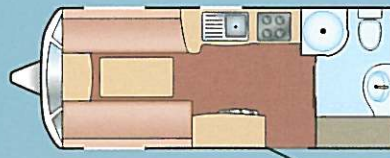

Clubman 475-CK

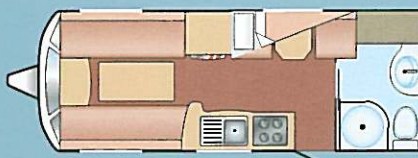

Clubman 530-4

Delta

	Delta 540-2	Twin Axle 640-EW	
Internal body length	5.52m/18'1"	6.44m/21'1"	
Overall length	6.90m/22'8"	7.82m/25'8"	
Internal body width	2.16m/7'1"	2.16m/7'1"	
Overall width	2.28m/7'6"	2.28m/7'6"	
Maximum internal height	1.90m/6'3"	1.90m/6'3"	
Overall height	2.59m/8'6"	2.59m/8'6"	
Tyre size	185 R14 8 ply	175 R14	
Coupling height	440mm/17"	440mm/17"	
Mass in running order	1200 kg	1440 kg	
Total user payload	250 kg	260 kg	
MTPLM*	1450 kg*	1700 kg	
Bed sizes	Double	2.10m x 1.48m 6'11" x 4'10"	2.10m x 1.48m 6'11" x 4'10"
		or	or
	2 x Single	1.88m x 0.74m 6'2" x 2'5"	1.88m x 0.74m 6'2" x 2'5"
Double		1.89m x 1.37m 6'2" x 4'6"	
Awning guide [check with supplier]	960cm	1060cm	

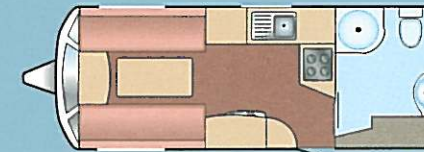

Delta 540-2



Delta 640-EW Twin Axle

Weightlessness

Lunars are of course best known for their weight... or rather LACK of it. In all the years we've led the way there has been no serious competition to our weight advantage from the ordinary caravan manufacturers.

How do we do it?... Well to the casual observer, apart from our obvious quality, there might seem little difference between a Lunar and the others... It's what lies beneath that makes the difference, we utilise only the lightest, strongest materials and pay meticulous attention to the smallest details.

As an example, check out the 'wooden' shaped profiles on an ordinary caravan - the same? Our's is the REAL THING; not the heavy wood effect MDF that most caravan manufacturers use; but special, expensive imported Obeche hardwood that's up to 30% lighter.

The story doesn't end there, Lunar has honed weights throughout our 35 years of caravan building. It's a skill which is second nature in our construction processes, shaving a few millimetres here and there within the framed furniture, selecting lightweight Poplar ply instead of the cheaper, heavier alternatives used by other manufacturers and gaining up to a 25% weight saving in the process.

Lightweight yes - and without compromising on strength, quality, durability, practicality OR good looks. As fuel costs spiral, now is the right time for a lightweight Lunar.



Lunar 2006 at a glance

Ariva		2 berth	total length 5.17m	MRO 800kg.	
Zenith	3 models;	Four Five Six	4 berth 5 berth 6 berth	total length 6.10m total length 6.82m total length 7.26m	MRO 945kg. MRO 1005kg. MRO 1060kg.
Stellar		2 berth	total length 5.60m	MRO 960kg.	
Quasar	7 models;	462 EB 524 525 566 FB 615	2 berth 4 berth 4 berth 5 berth 6 berth 6 berth 5 berth	total length 6.16m total length 6.70m total length 6.82m total length 6.82m total length 7.26m total length 7.82m total length 7.64m	MRO 990kg. MRO 1090kg. MRO 1070kg. MRO 1090kg. MRO 1145kg. MRO 1265kg. MRO 1250kg.
Lexon	5 models;	EB CS DS EW 640	4 berth 4 berth 5 berth 4 berth 4 berth	total length 7.03m total length 7.26m total length 7.26m total length 7.82m total length 7.82m	MRO 1170kg. MRO 1180kg. MRO 1190kg. MRO 1340kg. MRO 1275kg.
Clubman	3 models;	470-2 475 CK 530-4	2 berth 2 berth 4 berth	total length 6.25m total length 6.25m total length 6.82m	MRO 1110kg. MRO 1080kg. MRO 1150kg.
Delta	2 models;	540-2 640 EW	2 berth 4 berth	total length 6.90m total length 7.82m	MRO 1200kg. MRO 1440kg.



The contents of this brochure are correct at time of going to print, however Lunar Caravans reserve the right to alter materials, specification and prices without prior notification. It should be noted that distributors and dealers are not the agents of Lunar Caravans Limited and are therefore NOT authorised to bind the Company by any specific or implied undertaking or representation. ©2005 Lunar Caravans Limited.

Designed and produced by Carne Whitney 015396 23619.

The Lunar Owner's Club

When you choose Lunar you have a great opportunity to join the growing band of enthusiasts that enjoy all the benefits of joining the Lunar Owner's Club.

As a club member you will receive regular information packed newsletters with all the latest news on forthcoming events, letters from fellow members and the inside track on the new developments from Lunar Caravans themselves.

Every member is welcome at the Club's numerous exclusive rallies across the UK, you'll meet a host of new friends who share a common interest in caravanning in a Lunar. They can also offer a wealth of knowledge and expertise to help you enjoy lightweight touring at its very best.



Sherdley Road Lostock Hall Preston Lancashire PR5 5JF.
Tel 01772 337628 Fax 01772 627722

www.lunarcaravans.com

Authorised Lunar dealer:

