

**YOUR 1<sup>ST</sup> CHOICE FOR  
MORE CHOICE**

- ✓ OVER 300 CARAVANS ON SHOW
- ✓ INDOOR & SEASONAL OUTDOOR CAMPING DISPLAY
- ✓ AWNING DISCOUNT CENTRE
- ✓ ACCESSORIES SUPERMARKET
- ✓ 5 STAR SERVICE CENTRE & REPAIR WORKSHOPS
- ✓ FINANCE & INSURANCE (SUBJECT TO STATUS)

**GUARANTEED A  
WARM WELCOME**

**HIGHBRIDGE**

Caravan and Camping Centre

**OPEN 7 DAYS  
A WEEK**

**01278 782725**

A38, BRISTOL RD, HIGHBRIDGE, SOMERSET, TA9 4EX  
[www.highbridge-caravans.co.uk](http://www.highbridge-caravans.co.uk)

**2001 Range**

Ariva GTS

LX2000

Lexon

Solar Eclipse

Clubman

Delta

Stellar



**Building A Better Touring Future**

**LUNAR**

*We put you first*



The translation of the Lunar crest is 'Our product - our pride'... A personal statement made by our founding directors over thirty years ago and still at the core of Lunar's philosophy today. Since that time, Lunar has built a healthy reputation for its lightweight designs and innovation - a reputation further enhanced by the introduction of the superb year 2001 model ranges.

Many new layouts, clever and practical improvements, improved specifications... all these are apparent and the unique lightness of all Lunar products gives them a broad appeal to old and new caravanners alike. No-one else offers caravans which can be towed by small family cars and even our larger models are light enough to be towed by family saloons. Check out the Lunar 2001 range... You will be impressed.

## Building a better touring future...

### More caravan, less weight...

Designed to answer the demands of today's touring, Lunar's 2001 range sees the introduction of brand new models alongside our existing range all featuring a host of improvements. Both the Delta and Clubman ranges include stylish roof lockers and dedicated shower cubicles, whilst most ranges feature new longer single seats (1.88m) to further enhance the already comfortable lounge area.

New for 2001, the Stellar 400 is a wide bodied, two berth model with an excellent level of specification. A new addition to the Lexon series is the wide bodied EW which brings twin axled stability and a dedicated washroom to the already highly successful Lexon EB formula. Whilst a walk round bed is a major feature of the new Lexon 640.

### Setting future standards

At Lunar we are caravanners too, and our own special understanding of your needs has resulted in many practical advantages. Open one of the roof locker doors - you won't see any bare wood or painted edges. Only clean, smooth and professionally veneered edges... Then there's the pull out chopping board built into many kitchens, the low level courtesy light, the removable doormat and so many more features where Lunar quality shines through...



### Relaxation and pleasure

With the high level of standard equipment throughout the different ranges, we are sure there's a caravan to meet your needs...

The large Heki sunroof brings extra light to the living area and assists airflow on those warm summer days. The stereo CD player in Clubman and Delta models creates the right mood for relaxing in the newly restyled and extremely comfortable lounge, and the new lighting creates a special ambience as you settle down for the evening.

As a caravanner you are weight conscious, so you will appreciate the many years of experience and development which give Lunar the edge in saving every last kilogram. With an extended 'A' frame design providing a combination of maximum strength and minimum weight and even better stability, each chassis is galvanised for maximum durability.

By utilising materials which are light in weight yet strong in use, and by paying meticulous attention to manufacturing methods, we continue to improve our skills in lightweight construction year on year, without sacrificing either strength or quality.

### Lunar's extended warranty offers real touring peace of mind

All caravans receive a full twelve months warranty from the date of purchase - for no extra charge, but subject to an annual service and inspection, an extended warranty will cover the following major items, but not items subject to ordinary wear and tear.

#### 2nd Year Warranty

Body and Floor, against water ingress and delamination.  
Head, Shaft and Damper of the Coupling, the entire  
Axle assembly and all aspects of the Chassis, including corner steadies.

#### 3rd Year Warranty

Body and Floor, against water ingress and delamination.





## Ariva GTS

Classic touring luxury in true compact style...

Narrower and lighter than any of its rivals the luxurious Ariva GTS is totally unique in its class, offering real caravanning luxury in an easy to handle, lightweight body. The Ariva GTS' ingenious design with traditional rear-end kitchen layout gives a surprisingly roomy and spacious feel, without compromising either storage facilities or the high specification.

Ideal for year round caravanning, the gas/electric room heater has ducted blown air for all round comfort and the large fridge with its full width freezer is ideal for those little summer indulgences!

New features for the 2001 season are the Status television aerial, now fitted as standard, and the redesigned chassis which has reduced the overall length by 150mm making manoeuvring even easier with this compact, yet exceptionally comfortable model.

### Ariva GTS Features

#### Construction

- Galvanised steel chassis
- Fully insulated walls, roof and floor and double glazed windows
- Natural wood framed doors
- External width ONLY 2.02m (6'7")

#### Fixtures and Fittings

- Blinds and flyscreens to all windows
- Flyscreen to door
- Window in door
- Status TV aerial with 12v power point and TV socket
- Battery condition indicator
- 12amp charger / transformer with ELCB
- Pump warning light
- Remote switch for one ceiling light inside doorway
- 'Lunar' doormat

- Truma gas water heater with mains electric immersion heater
- Mains electric hook-up with 20 metre cable supplied
- 6' bed lockers designed for easy access, with hinged front flap
- One key for all lockable doors
- All windows and chassis marked with VIN details, plus hidden electronic tagging card
- Clock
- Awning light

#### Kitchen

- 4-burner enamelled hob/grill unit, all burners fitted with flame failure device
- Domestic style taps with easy on/off and mixer action
- Large fridge with full width freezer
- Oven, colour matched to kitchen suite
- Halogen downlighter

#### Bathroom

- Separate taps for vanity basin and shower control
- Fitted cassette toilet
- Large washroom window

#### Lounge, Bedroom and Dining Area

- Cocktail cabinet
- Domestic style interior sprung base mattresses
- Roof light with night blind and flyscreen
- Roll out slats for double bed make-up
- Truma fixed room heater with electric ultraheat and ducted blown air
- 2 12v reading lights
- 2 flush mounted mains sockets
- 2 drawer chest with pull-out coffee table

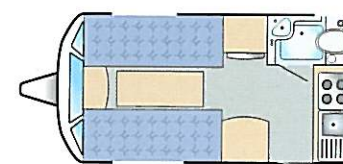

Ariva GTS, 2 berth







# LX2000

## The craftsman built tourer...

Since its introduction the LX2000 has developed into a truly outstanding caravan offering exceptional value for money. This attractively presented range of two berth and family caravans provides comprehensive levels of equipment that inspire compliments from caravanners, old and new alike.

The specification is all that can be expected from a year round tourer, including mains room heater and mains electric water heater and a large fridge with full width freezer for the summer months.

The new Heki sunroof, circular ceiling lights, attractive furniture fabrics and soft furnishings, plus the colour co-ordinated equipment help make the LX2000 as complete a package as you could wish for...

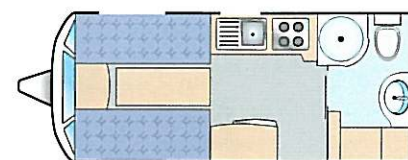

LX2000 462, 2 berth

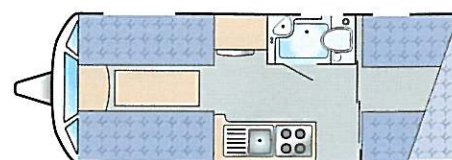

LX2000 525, 5 berth

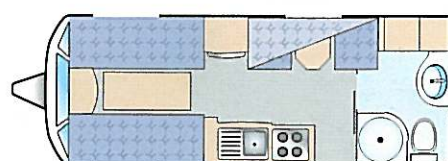

LX2000 524, 4 berth

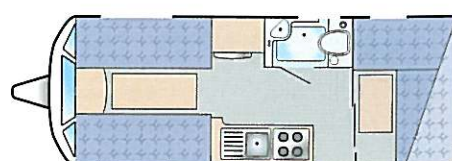

LX2000 525 L, 5 berth

## LX2000 Features

### Construction

- Fully insulated walls, roof and floor and double glazed windows
- Galvanised steel chassis
- Natural wood framed doors
- New rear panel with spoiler and high level brake light

### Fixtures and Fittings

- Isolation taps for gas equipment
- Truma gas water heater with mains electric immersion heater
- Blinds and flyscreens to all windows
- Flyscreen to door
- Remote light switch inside door for one ceiling light
- Awning light
- Pump warning light
- Status TV aerial with 12v power point and TV socket
- Window in stable door

- Comfortable attractively designed back and arm rests
- 12 amp charger/ transformer with ELCB
- New front roof lockers
- Mains electric hook-up with 20 metre cable supplied
- One key for all lockable doors
- All windows and chassis marked with VIN details, with hidden electronic tagging card
- 'Lunar' doormat
- Large Heki sunroof with blind and flyscreen

### Lounge, Bedroom and Dining Area

- New circular fluorescent lights
- Three mains sockets
- 2 12v and 2 mains reading lights
- 2 drawer chest with pull-out coffee table
- Domestic style interior sprung base mattresses to front and rear seats
- 6" bed lockers designed for easier access with hinged front flap

- Trumatic flued room heater with electric ultraheat and ducted blown air
- Cocktail cabinet

### Bathroom

- Fitted cassette toilet
- Separate taps serving the wash hand basin and shower
- Large washroom window

### Kitchen

- Large domestic style taps with easy on/off and mixer action
- Oven colour matched to kitchen suite
- Large fridge with full width freezer
- Colour keyed 4 burner hob with spark ignition and flame failure device
- Additional slide out work surface in kitchen
- Halogen downlighters





# Lexon

The wider touring concept that offers a unique layout and even more comfort.

The introduction of the Lexon heralded a new approach to caravanning. Wider than most other models, the extra space has enabled us to design a range of truly unique touring caravans that includes both family and two berth models. The Lexon is ideal for the family with its end kitchen layout, but the soaraway success story has been the Lexon EB which has a fixed bed as well as a capacious lounge area - ideal for those lazy summer days or social gatherings.

New for 2001, the twin-axled Lexon EW builds on the successful EB formula with the added luxury of a dedicated shower cubicle and washroom area at the rear. The ultimate in spacious touring luxury is the Lexon 640 EB with its large walk-round bed at the rear it provides a sense of comfortable permanence no matter where you are on holiday.

The unique Lexon range is a superb example of Lunar design know-how. Because they are lighter they can be towed by most family cars and feature a luxurious specification for maximum enjoyment.

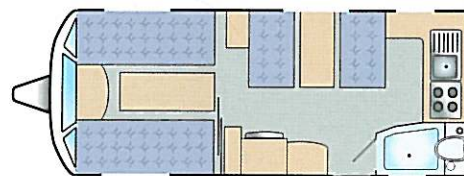

Lexon, 4 berth

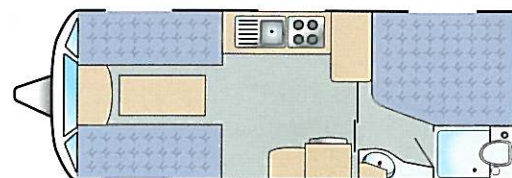

Lexon EB, 4 berth

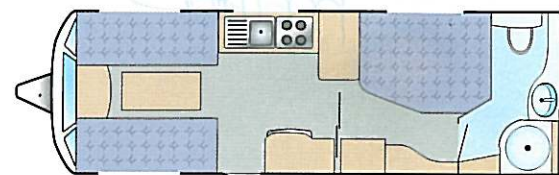

Lexon EW, 4 berth

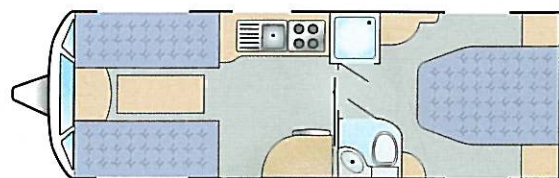

Lexon 640, 4 berth



## Lexon Features

### Construction

- Galvanised steel chassis
- Fully insulated walls, roof and floor and double glazed windows
- Natural wood framed doors
- ABS capped acrylic rear panel
- Spoiler
- High level brake light
- Window in stable door
- Mud flaps

### Kitchen

- Colour keyed 4 burner hob and thermostatically controlled oven with flame failure device and spark ignition
- Large fridge with full width freezer
- Domestic style taps with easy on/off mixer action
- Halogen downlighters
- Slide out additional work surface

### Fixtures and Fittings

- Isolation taps for gas equipment
- Truma water heater with mains electric immersion heater
- Blinds and flyscreens to all windows
- Flyscreen to door
- Remote switch for one ceiling light inside doorway
- Large Heki sunroof with blind and flyscreen
- Awning light
- 2 mains wall lights
- Exterior access to storage area in the Lexon EB, EW and 640
- Status TV aerial with 12v power point and TV socket
- Mains hook-up with 20 metre cable supplied
- Gas bottle tray with dedicated wheel brace and steady winder recesses

- 'Lunar' doormat
- All windows and chassis marked with VIN details, with hidden electronic tagging card
- 12v eyeball reading lights
- Front roof lockers

### Lounge, Bedroom and Dining Area

- New fluorescent roof lights
- Two drawer chest with flip-over coffee table
- Permanent double bed in Lexon EB, EW and 640
- Two 12v over bed reading lights
- Colour co-ordinated mattress, two pillows and pillow cases in the fixed bed arrangements
- Dedicated TV locker in Lexon EB and EW

- Three mains sockets
- Easy access bed lockers, with hinged front flap
- Domestic style interior sprung base mattresses to all beds
- Trumatic flued room heater with electric ultraheat and ducted blown air
- Cocktail cabinet
- Long front lounge seats, 1.88m (6'2")

### Bathroom

- Fitted cassette toilet
- Large washroom window





## Solar Eclipse Features

### Construction

- Galvanised steel chassis
- Fully insulated walls, roof and floor
- Fully double glazed windows
- Natural wood framed doors

### Fixtures and Fittings

- Trumatic flued room heater, with electric ultraheat heater and ducted blown air
- Truma water heater with mains electric immersion heater
- Status TV aerial with 12v power point and TV socket
- Blinds and flyscreens to all windows
- Flyscreen to door
- Mains electric hook-up with 20 metre cable supplied
- 12 amp charger / transformer with ELCB
- Easy access to bed locker storage
- One key for all lockable doors
- All windows and chassis marked with VIN details, with hidden electronic tagging card
- Large Heki sunroof with blind and flyscreen
- Window in stable door
- Awning light

### Kitchen

- 4-burner enamelled hob/grill unit, all burners fitted with flame failure device
- Large domestic style taps with easy on/off and mixer action
- Large fridge with full width freezer
- Oven, colour matched to the kitchen suite

### Bathroom

- Fitted cassette toilet
- Large washroom window

### Lounge, Bedroom and Dining Area

- Roll-out slats for double bed make-up
- 3 flush mounted mains sockets
- 2 bolster cushions
- 2 drawer chest with pull-out coffee table
- 2 12v and 2 mains reading lights
- Slatted bed box tops
- Domestic style interior sprung base mattresses to front seats
- Remote switch to one ceiling light inside doorway

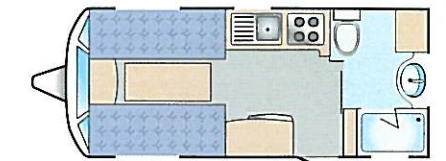

Solar Eclipse 462, 2 berth

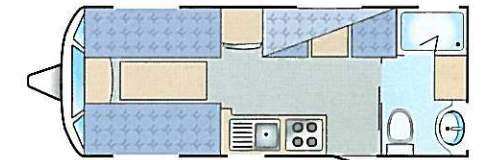

Solar Eclipse 524, 4 berth

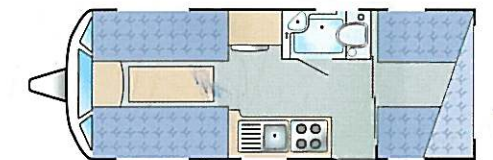

Solar Eclipse 525, 5 berth

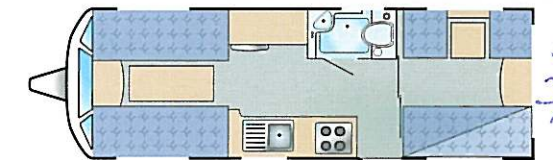

Solar Eclipse 615, 5 berth

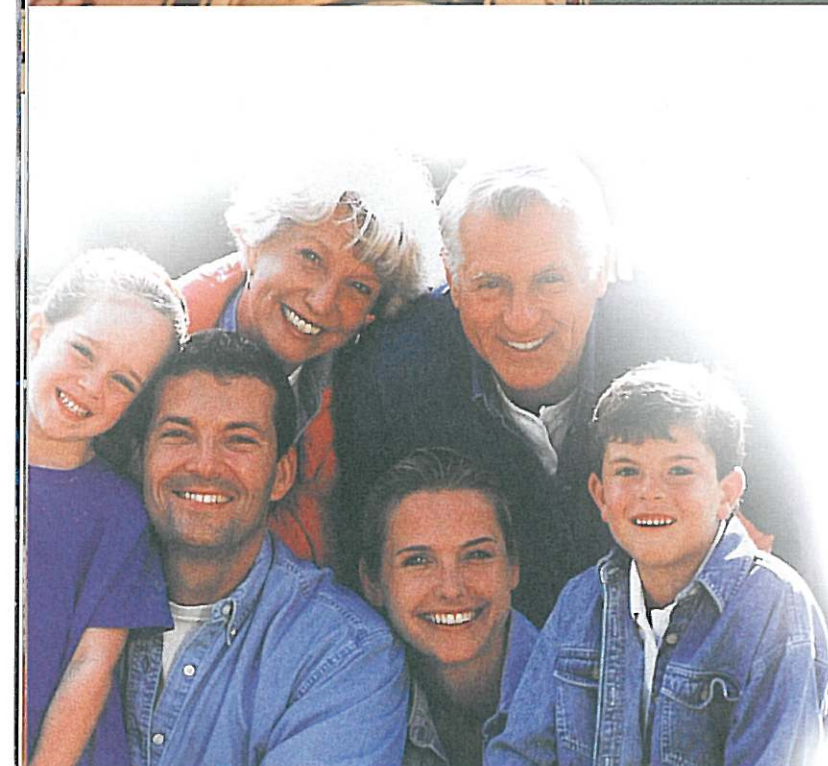

# Solar Eclipse

The brightly coloured soft furnishings of the Solar Eclipse are a perfect match for the high gloss "cherry" woodwork, with its new curved furniture sections creating a pleasing and relaxing environment in which to spend your caravanning holidays. Allied to the natural wood framed furniture doors there is a comprehensive list of features that will ensure the utmost comfort and enjoyment... a large fridge with a full width freezer, a large Heki rooflight, three mains sockets, four models representing great value for money and the Solar Eclipse 615 offering a unique family layout.





# Lunar - touring that's a great deal more enjoyable...

There are many extras fitted as standard across the range of Lunar caravans that will make your touring a great deal more enjoyable...



## Drinks cabinet.

An attractive addition in Lunar caravans (except Solar Eclipse), ideal for those relaxing evenings.

## Attention to detail.

A craftsman built Lunar caravan has NO bare wood or painted edges.

## Tough window fittings.

Strong, secure stays, hinges and locks, with night latches for ventilation.



Unique wide access to underbed storage.

## Supreme comfort.

Mattresses are either interior sprung or feature top quality foam filled.

## Laminate table and worktops.

Good looking, heat resistant and really hard wearing.

## Quality fittings.

Strong catches, rugged hinges and quality handles.

## Stereo Radio/CD player.

An attractive feature of both the Delta and Clubman ranges.

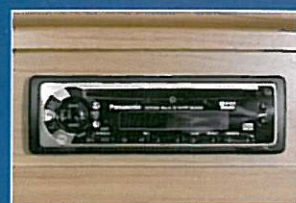

## Single key locking.

For added security and simplicity - no more handfuls of jangling keys!



## Upholstery, Carpets, Curtains.

Quality, hard wearing fabrics in attractive co-ordinated colours and beautiful patterns.

## Quality electrical fittings.

Switches, lights, power points and controls placed for ease of access and practicality.

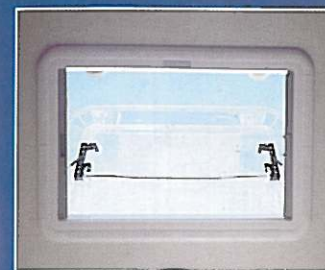

## Heki sunroof.

An attractive feature that floods the interior with natural sunlight. Fitted to all Lunar models except Ariva GTS.



## Shower/Washroom.

Lunar are proud of their carefully designed luxurious showers and bathrooms with their quality fittings and masses of storage space.

## Stacks of storage.

Large cupboards and wardrobes, loads of locker and shelf space for everything you need for a really enjoyable holiday.



## Quality hardwood.

Lunars are famous for their real wood luxury door frames.

## Re-designed aircraft style lockers.

Ample drop-fronted access for all those little nick-nacks in Delta and Clubman models.

## Downlighters and reading lights.

Extra bright Halogen lights where they're really needed.

## Double glazing.

Every window, door and rooflight is double glazed - for warmth in winter and cool in summer.

## Power points.

All models feature ample mains and 12 volt power points.

## Kitchen worksurfaces.

More than enough space to prepare a real banquet, many models feature an additional pull-out surface too!

## Warm as toast!

Every Lunar meets full grade 2 classification with insulated walls, floor and roof, double glazing and powerful heaters.

## Large oven and 4 burner hob.

Colour keyed with other fittings with a smoked glass lid.



## Underbed storage.

With handy storage basket fitted to Delta and Clubman models.



## Omnivent powered extractor fan.

Fitted throughout the Delta and Clubman ranges.



## Really large fridge.

Gas/electric, with full width freezer.

## Ease of access.

Lunar like to keep things easy and simple, all models feature snap-on battery connections.







# Clubman

Classic design that combines style and traditional quality with the latest features

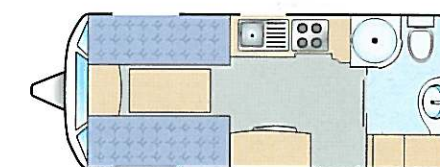

Clubman 475 CK, 2 berth

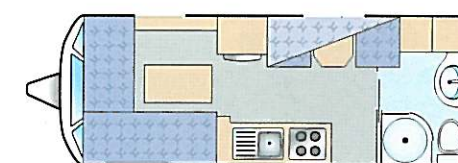

Clubman 530 L, 4 berth

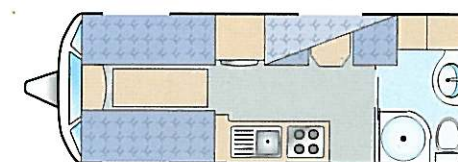

Clubman 530-4, 4 berth

## Clubman Features

### Construction

- Galvanised steel chassis
- Fully insulated walls, roof and floor and double glazed windows
- Natural wood framed doors
- ABS capped acrylic rear panel
- Rear spoiler
- High level brake light
- Window in stable door
- Mud flaps
- Newly designed aircraft style roof lockers
- One key for all lockable doors

### Fixtures and Fittings

- Isolation taps for gas appliances
- Truma water heater with mains electric immersion heater
- Blinds and flyscreens to all windows
- Flyscreen to door
- Remote switch for one ceiling light inside the doorway
- Large Heki sunroof with blind and flyscreen

- Mains hook-up with 20 metre cable supplied
- Awning light
- 12v and new mains reading lights
- Exterior access to bed locker storage
- Status TV aerial with 12v power point and TV socket
- 'Lunar' doormat
- New front roof lockers
- Low level courtesy light
- Barbecue point
- Three mains sockets
- External mains socket
- All windows and chassis marked with VIN details, with hidden electronic tagging card

### Bathroom

- Fitted cassette toilet with electric flush
- Large washroom window

### Lounge, Bedroom and Dining Area

- New fluorescent roof lights
- Comfortable attractively designed back and arm rests
- Two drawer chest with flip-over coffee table
- Domestic style interior sprung base mattresses
- Easy access bed lockers with hinged front flap
- Cocktail cabinet with interior light
- Truma flued room heater with electric ultraheat and ducted blown air
- Stereo CD player/Radio with twin speakers
- Wire storage basket in front bed box

### Kitchen

- Colour keyed 4 burner hob and oven with flame failure device and spark ignition
- Large fridge with full width freezer
- Domestic style taps with easy on/off mixer action
- Omnivent 12v powered extractor/rooflight
- Extra slide out work surface

The Clubman boasts an indefinable mix of quality and traditional appeal that has proved so elusive to others, yet has remained the basis for the Clubman's continuing success over many years.

The new models feature stylish exteriors enhanced by an aerodynamically designed spoiler with a high level brake light and matched with a superb interior with aircraft style lockers and natural wood framed doors. The Clubman's comprehensive specification has been extended with the introduction of the new front roof lockers and the large, circular rear end shower compartments.

If you are looking for opulent luxury then the Clubman, with its three very traditional and very appealing models, simply cannot be bettered.

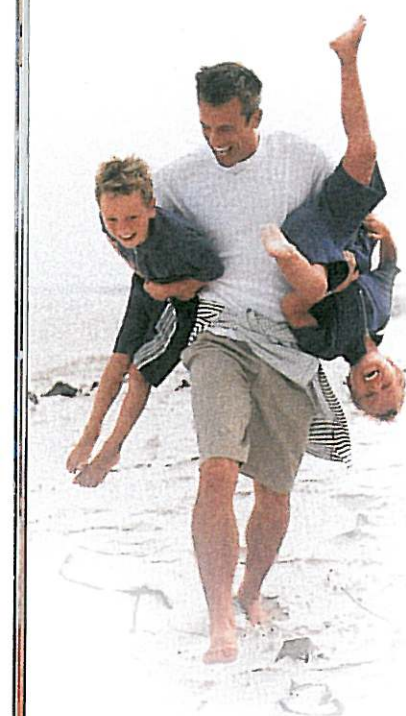





### Delta Features

#### Construction

- Galvanised steel chassis
- Fully insulated walls, roof and floor and double glazed windows
- Natural wood framed doors
- ABS capped acrylic rear panel
- GRP rear spoiler with high level brake light
- Window in stable door
- Mud flaps
- Aircraft style roof lockers
- One key for all lockable doors
- 2.28m wide body

#### Fixtures and Fittings

- Blinds and flyscreens to all windows
- Flyscreen to door
- Barbecue point
- Awning light
- External mains socket
- Large Heki sunroof with blind and flyscreen
- Remote switch for one ceiling light inside doorway
- 12v and mains reading lights
- Low level courtesy light
- Exterior access to storage area
- Status TV aerial with 12v power point and TV socket
- Truma water heater with mains electric immersion heater
- Mains hook-up with 20 metre cable supplied
- Gas bottle tray with dedicated wheel brace and steady winder recesses
- 'Lunar' doormat
- Isolation taps for gas appliances
- Inboard 60 litre (13 gallon) water tank
- All windows and chassis marked with VIN details, with hidden electronic tagging card
- New front roof lockers

#### Kitchen

- Halogen downlighting over cooker area
- Extra slide out work surface
- Colour keyed 4 burner hob with flame failure device and spark ignition
- Colour co-ordinated thermostatically controlled oven
- Large fridge with full width freezer
- Domestic style taps with easy on/off mixer action
- Omnivent 12v powered extractor/rooflight
- 610-4 MODEL FEATURES AN EYE LEVEL MICROWAVE OVEN

#### Bathroom

- Fitted cassette toilet with electric flush
- Halogen downlighting above mirror
- Large washroom window

#### Lounge, Bedroom and Dining Area

- New fluorescent roof lights
- Domestic style interior sprung base mattresses to all beds
- Three mains sockets
- Easy access bed lockers with hinged front flaps
- Cocktail cabinet with interior light
- Trumatic flued room heater with electric ultraheat and ducted blown air
- Stereo CD player/Radio with twin speakers
- 2 drawer chest with pull out coffee table
- Wire storage basket in front bed box

A luxurious design with an exceptional specification to meet every touring need

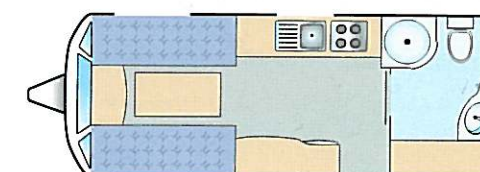

Delta 520-2, 2 berth

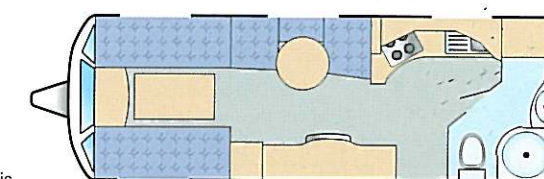

Delta 610-3, 3 berth

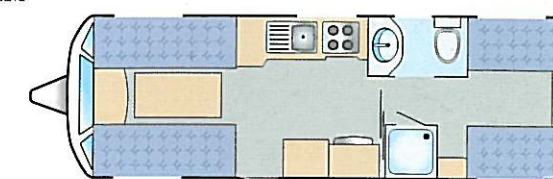

Delta 610-4, 4 berth

## Delta

The beautifully finished natural wood grained doors, the redesigned aircraft style roof lockers and the superb combination of American Cherry woodwork and the luxuriant soft furnishings are immediately obvious quality features that have made the Delta a model that every caravanner would be proud to own.

As with every Lunar range there is so much more of course... The Delta's specification is superb, designed to match the roomy interiors that result from a 2.28m wide body. The unique 610-4 features an eye level microwave oven, whilst the 610-3 and 520-2 models are as roomy as any caravanner could wish for. With the Heki sunroof flooding the interior with natural sunlight and the quality CD/radio cassette playing in the background relaxation in a Delta is a total experience.

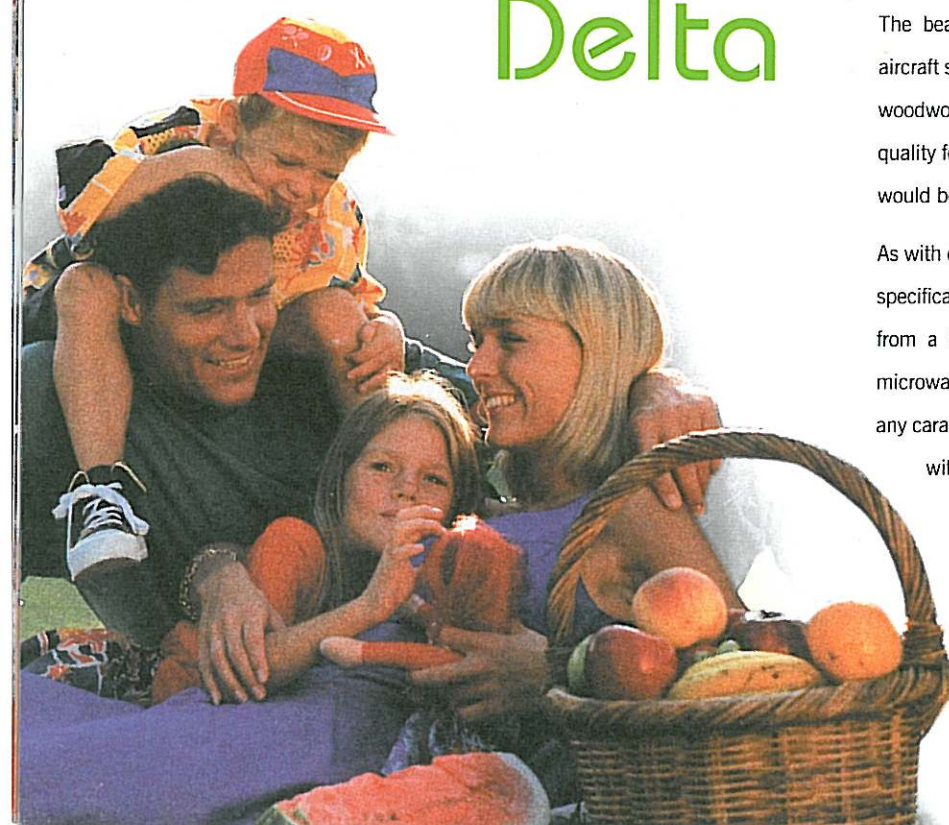





# Stellar 400

## Luxury caravanning for the touring couple

Created in response to the need for comfortable, spacious caravans that are of an easily manageable size, Lunar's new Stellar 400 offers masses of usable space despite being short in length - a result of a slightly wider 2.28m body design.

The use of an attractive rear-offside kitchen has allowed Lunar to make full use of the roomy interior which features rich high gloss cherry woodwork and fabulous new soft furnishings. Constructed with a high level of specification that allows year-round touring in total comfort, the Stellar is *the* choice for discerning couples.



### Stellar 400 Features

#### Construction

- Galvanised steel chassis
- Fully insulated walls, roof and floor
- Fully double glazed windows
- Natural wood framed doors
- Window in stable door

#### Bathroom

- Fitted cassette toilet

#### Fixtures and Fittings

- Trumatic flued room heater, with electric ultraheat heater and ducted blown air
- Truma water heater with mains electric immersion heater
- Status TV aerial with 12v power point and TV socket
- Blinds and flyscreens to all windows
- Flyscreen to door
- Mains electric hook-up with 20 metre cable supplied

- 12 amp charger / transformer with ELCB
- Easy access to bed locker storage
- One key for all lockable doors
- All windows and chassis marked with VIN details, with hidden electronic tagging card
- Large Heki sunroof with blind and flyscreen
- Awning light

#### Kitchen

- 4-burner enamelled hob/grill unit, all burners fitted with flame failure device
- Large domestic style taps with easy on/off and mixer action
- Large fridge with full width freezer
- Oven, colour matched to the kitchen suite

#### Lounge, Bedroom and Dining Area

- Roll-out slats for double bed make-up
- 3 flush mounted mains sockets
- 2 bolster cushions
- 2 drawer chest with pull-out coffee table
- 2 12v and 2 mains reading lights
- Slatted bed box tops
- Domestic style interior sprung base mattresses to front seats
- Remote switch to one ceiling light inside doorway

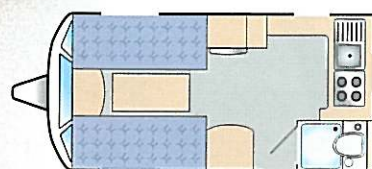

Stellar 400, 2 berth

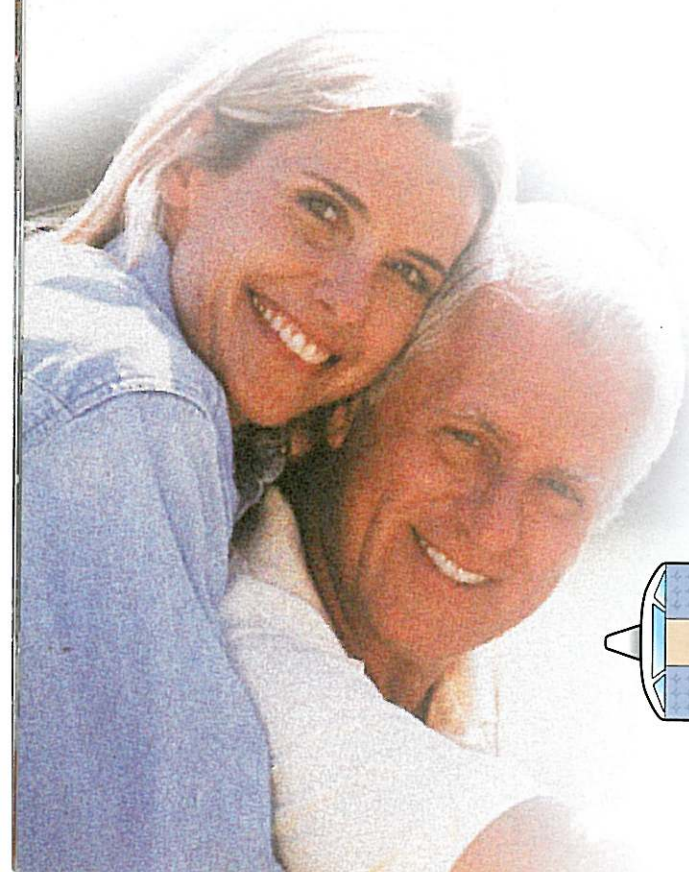



# Lunar 2001 specifications

\* MTPLM - Most models can have the MTPLM (maximum technical permissible laden mass) increased with minimal disruption. Contact your nearest Lunar Caravans dealer for further information.

## Delta

Model	Delta 520-2	Delta 610-3	Delta 610-4
Internal Body Length	5.30m 17'5"	6.10m 20'0"	6.26m 20'6"
Overall Length	7.06m 23'6"	7.88m 25'10"	7.88m 25'10"
Internal Body Width	2.16m 7'1"	2.16m 7'1"	2.16m 7'1"
Overall Width	2.28m 7'6"	2.28m 7'6"	2.28m 7'6"
Maximum Internal Height	1.90m 6'3"	1.90m 6'3"	1.90m 6'3"
Overall Height	2.65m 8'8"	2.65m 8'8"	2.65m 8'8"
Tyre Size	155 R 13 78	155 R 13 78	155 R 13 78
Coupling Height	440mm 17"	440mm 17"	440mm 17"
Mass in Running Order	1130 kg.	1180 kg est.	1260 kg
Total User Payload	320 kg	320 kg	340 kg
MTPLM*	1450 kg	1500 kg	1600 kg
Bed Sizes Double	2.10m x 1.48m 6'11" x 4'10"	2.10m x 1.48m 6'11" x 4'10"	2.10m x 1.48m 6'11" x 4'10"
	or	or	or
Single	Two 1.88m x 0.74m 6'2" x 2'5"	Two 1.88m x 0.74m 6'2" x 2'5"	Two 1.88m x 0.74m 6'2" x 2'5"
Single		1.83m x 0.74m 6'0" x 2'5"	
Double			2.10m x 1.33m 6'11" x 4'4"
Awning - ground to ground	970 cm	1050 cm	1050 cm

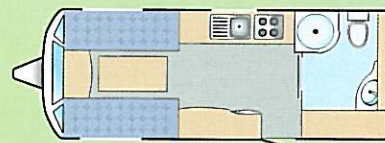

Delta 520-2, 2 berth

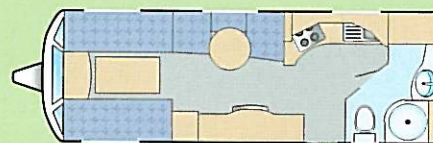

Delta 610-3, 3 berth

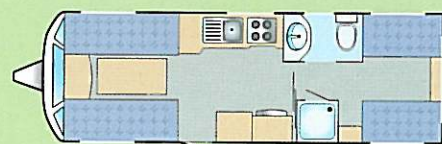

Delta 610-4, 4 berth

## Solar Eclipse

Model	Solar Eclipse 462	Solar Eclipse 524	Solar Eclipse 525	Solar Eclipse 615
Internal Body Length	4.67m 15'5"	5.33m 17'6"	5.33m 17'6"	6.10m 20'0"
Overall Length	6.35m 20'10"	6.99m 22'11"	6.99m 22'11"	7.95m 26'1"
Internal Body Width	2.04m 6'8"	2.04m 6'8"	2.04m 6'8"	2.04m 6'8"
Overall Width	2.16m 7'1"	2.16m 7'1"	2.16m 7'1"	2.16m 7'1"
Maximum Internal Height	1.90m 6'3"	1.90m 6'3"	1.90m 6'3"	1.90m 6'3"
Overall Height	2.65m 8'8"	2.65m 8'8"	2.65m 8'8"	2.65m 8'8"
Tyre Size	175 R 13 94	175 R 13 94	175 R 13 94	155 R 13 78
Coupling Height	440mm 17"	440mm 17"	440mm 17"	440mm 17"
Mass in Running Order	855 kg est.	945 kg est.	945 kg	1080 kg
Total User Payload	235 kg	255 kg	255 kg	320 kg
MTPLM*	1090kg	1200 kg	1200 kg	1400 kg
Bed Sizes Double	2.01m x 1.48m 6'7" x 4'10"	2.01m x 1.48m 6'7" x 4'10"	2.01m x 1.48m 6'7" x 4'10"	2.01m x 1.48m 6'7" x 4'10"
	or	or	or	or
Single	Two 1.88m x 0.69m 6'2" x 2'3"	Two 1.88m x 0.69m 6'2" x 2'3"	Two 1.88m x 0.69m 6'2" x 2'3"	Two 1.88m x 0.69m 6'2" x 2'3"
Single		1.83m x 0.69m 6'0" x 2'3"		1.83m x 0.69m 6'0" x 2'3"
Double			2.01m x 1.29m 6'7" x 4'3"	
Bunk		1.78m x 0.56m 5'10" x 1'10"	1.98m x 0.56m 6'6" x 1'10"	1.70m x 0.56m 5'7" x 1'10"
Awning - ground to ground	900 cm	965 cm	965 cm	1050 cm

## Clubman

Model	Clubman 475CK	Clubman 530-4	Clubman 530 L
Internal Body Length	4.82m 15'10"	5.33m 17'6"	5.33m 17'6"
Overall Length	6.44m 21'1"	6.95m 22'10"	6.95m 22'10"
Internal Body Width	2.04m 6'8"	2.04m 6'8"	2.04m 6'8"
Overall Width	2.16m 7'1"	2.16m 7'1"	2.16m 7'1"
Maximum Internal Height	1.90m 6'3"	1.90m 6'3"	1.90m 6'3"
Overall Height	2.65m 8'8"	2.65m 8'8"	2.65m 8'8"
Tyre Size	175 R 13 94	175 R 13 94	175 R 13 94
Coupling Height	440mm 17"	440mm 17"	440mm 17"
Mass in Running Order	950 kg	1020 kg est.	995 kg
Total User Payload	250 kg	280 kg	315 kg
MTPLM*	1200 kg	1300 kg	1300 kg
Bed Sizes Double	2.01m x 1.48m 6'7" x 4'10"	2.01m x 1.48m 6'7" x 4'10"	2.01m x 1.37m 6'7" x 4'6"
	or	or	or
Single	Two 1.88m x 0.69m 6'2" x 2'3"	Two 1.88m x 0.69m 6'2" x 2'3"	
Single		1.83m x 0.69m 6'0" x 2'3"	1.83m x 0.69m 6'0" x 2'3"
Bunk		1.78m x 0.56m 5'10" x 1'10"	1.78m x 0.56m 5'10" x 1'10"
Awning - ground to ground	905 cm	963 cm	963 cm



Clubman 475 CK, 2 berth



Clubman 530-4 L, 4 berth



Clubman 530-4, 4 berth

## Lunar Owner's Club

When you choose a Lunar caravan you have the opportunity to join the growing band of enthusiasts who enjoy all the benefits of the Lunar Owner's Club. As a club member you will be sent regular newsletters containing all the latest information on upcoming events, reviews, letters from fellow members and news from Lunar Caravans itself.

You'll be made very welcome at all the numerous rallies which take place across the country by people sharing a common interest in Lunar caravanning. They can also offer you a wealth of knowledge and expertise to help enjoy your future touring even more.

There are a wide variety of activities on offer to Owner's Club members including fruit picking, summer fairs, trips to major caravan and leisure shows, country walks, wine making, photography and a host of other exciting games and competitions for all the family.

Perhaps more importantly however, when you become a Lunar Owner's Club member you join a big happy family made up of new friends just like you who share a real interest in the freedom of luxury, lightweight touring at its very best.





## LX2000

Model	LX2000 462		LX2000 524		LX2000 525		LX2000 525 L	
Internal Body Length	4.67m	15'5"	5.33m	17'6"	5.33m	17'6"	5.33m	17'6"
Overall Length	6.35m	20'10"	6.99m	22'11"	6.99m	22'11"	6.99m	22'11"
Internal Body Width	2.04m	6'8"	2.04m	6'8"	2.04m	6'8"	2.04m	6'8"
Overall Width	2.16m	7'1"	2.16m	7'1"	2.16m	7'1"	2.16m	7'1"
Maximum Internal Height	1.90m	6'3"	1.90m	6'3"	1.90m	6'3"	1.90m	6'3"
Overall Height	2.65m	8'8"	2.65m	8'8"	2.65m	8'8"	2.65m	8'8"
Tyre Size	175 R 13 94		175 R 13 94		175 R 13 94		175 R 13 94	
Coupling Height	440mm	17"	440mm	17"	440mm	17"	440mm	17"
Mass in Running Order	900 kg		979 kg		1005 kg est.		1010 kg est.	
Total User Payload	240 kg		285 kg		295 kg		290 kg	
MTPLM*	1140 kg		1264 kg		1300 kg		1300 kg	
Bed Sizes Double	2.01m x 1.48m		2.01m x 1.48m		2.01m x 1.48m		2.01m x 1.48m	
	6'7"x 4'10"		6'7"x 4'10"		6'7"x 4'10"		6'7"x 4'10"	
	or		or		or		or	
Single	Two 1.88m x 0.69m		Two 1.88m x 0.69m		Two 1.88m x 0.69m		Two 1.88m x 0.69m	
	6'2" x 2'3"		6'2" x 2'3"		6'2" x 2'3"		6'2" x 2'3"	
Single			1.83m x 0.69m					
			6'0" x 2'3"					
Double					2.01m x 1.29m		2.01m x 1.29m	
					6'7"x 4'3"		6'7"x 4'3"	
Bunk			1.78m x 0.56m		1.98m x 0.56m		1.98m x 0.56m	
			5'10"x 1'10"		6'6"x 1'10"		6'6"x 1'10"	
Awning - ground to ground	900 cm		965 cm		965 cm		965 cm	



LX2000 462, 2 berth

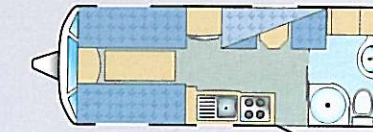

LX2000 524, 4 berth

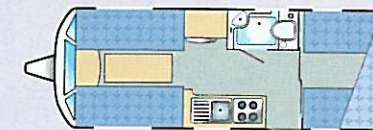

LX2000 525, 5 berth

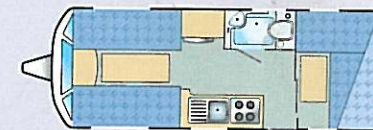

LX2000 525 L, 5 berth

## Stellar 400

Model	Stellar 400	
Internal Body Length	4.20m	13'9"
Overall Length	5.82m	19'1"
Internal Body Width	2.16m	7'1"
Overall Width	2.28m	7'6"
Maximum Internal Height	1.90m	6'3"
Overall Height	2.65m	8'8"
Tyre Size	175 R 13 94	
Coupling Height	440mm	17"
Mass in Running Order	860 kg	
Total User Payload	240 kg	
MTPLM*	1100 kg	
Bed Sizes Double	2.10m x 1.48m	
	6'11"x 4'10"	
	or	
Single	Two 1.88m x 0.74m	
	6'2" x 2'5"	
Awning - ground to ground	851 cm	

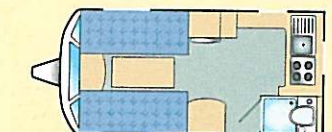

Stellar 400, 2 berth

## Lexon

Model	Lexon		Lexon EB		Lexon EW		Lexon 640	
Internal Body Length	5.24m	17'2"	5.56m	18'2"	6.44m	21'1"	6.44m	21'1"
Overall Length	6.91m	22'8"	7.23m	23'8"	8.06m	26'5"	8.06m	26'5"
Internal Body Width	2.16m	7'1"	2.16m	7'1"	2.16m	7'1"	2.16m	7'1"
Overall Width	2.28m	7'6"	2.28m	7'6"	2.28m	7'6"	2.28m	7'6"
Maximum Internal Height	1.90m	6'3"	1.90m	6'3"	1.90m	6'3"	1.90m	6'3"
Overall Height	2.65m	8'8"	2.65m	8'8"	2.65m	8'8"	2.65m	8'8"
Tyre Size	175 R 13 94		175 R 13 94		155 R 13 78		155 R 13 78	
Coupling Height	440mm	17"	440mm	17"	440mm	17"	440mm	17"
Mass in Running Order	1030 kg est.		1010 kg		1230 kg		TBA	
Total User Payload	310 kg		330 kg		330 kg		TBA	
MTPLM*	1340 kg		1340 kg		1560 kg		1600 kg	
Bed Sizes Double	2.10m x 1.48m		2.10m x 1.48m		2.10m x 1.48m		2.10m x 1.48m	
	6'11"x 4'10"		6'11"x 4'10"		6'11"x 4'10"		6'11"x 4'10"	
	or		or		or		or	
Single	Two 1.88m x 0.74m		Two 1.88m x 0.74m		Two 1.88m x 0.74m		Two 1.88m x 0.74m	
	6'2" x 2'5"		6'2" x 2'5"		6'2" x 2'5"		6'2" x 2'5"	
Double	1.83m x 1.19m		1.93m x 1.47m		1.88m x 1.47m		1.88m x 1.32m	
	6'0"x 3'11"		6'4"x 4'10"		6'2"x 4'10"		6'2"x 4'4"	
Awning - ground to ground	955 cm		985 cm		1060 cm		1060 cm	

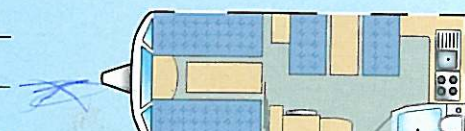

Lexon, 4 berth



Lexon EB, 4 berth



Lexon EW, 4 berth



Lexon 640, 4 berth

## Ariva GTS

Model	Ariva GTS	
Internal Body Length	3.63m	11'11"
Overall Length	5.14m	16'10"
Internal Body Width	1.90m	6'3"
Overall Width	2.02m	6'7"
Maximum Internal Height	1.90m	6'3"
Overall Height	2.65m	8'8"
Tyre Size	175 R13 94	
Coupling Height	440mm	17"
MRO	730 kg	
User Payload	220 kg	
MTPLM*	950 kg	
Bed Sizes Double	1.90m x 1.43m	
	6'3"x 4'8"	
	or	
Single	Two 1.83m x 0.66m	
	6'0" x 2'2"	
Awning - ground to ground	780 cm	

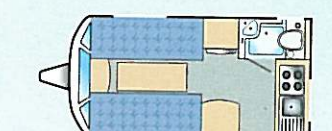

Ariva GTS, 2 berth



At Lunar Caravans we are now well into our third decade of manufacturing lightweight top quality touring caravans, the year 2001 heralds the introduction of the most extensive and comprehensive ranges ever.

The now famous Lunar crest carrying the Latin for "Our product - Our pride", sums up a philosophy that has consistently produced award winning, lightweight touring caravans with innovative features that are the envy of our competitors. Our ongoing programme of re-investment in our factory premises, the very latest technology and the new Lunar Caravans range - our best ever - ensures that our reputation for building quality caravans will continue into the future...



## Lunar Caravans Limited

Sherdley Road, Lostock Hall, Preston, Lancashire PR5 5JF

Tel: 01772 337628 Fax: 01772 627722

Visit our Website: [www.lunarcaravans.com](http://www.lunarcaravans.com)

The contents of this brochure are as accurate as possible at the time of going to print. Lunar Caravans Ltd reserve the right to alter materials, specifications, price and model ranges as conditions demand.  
This brochure does not constitute an offer. © 2000 Designed and Produced by 2Mi Limited 015242 72888



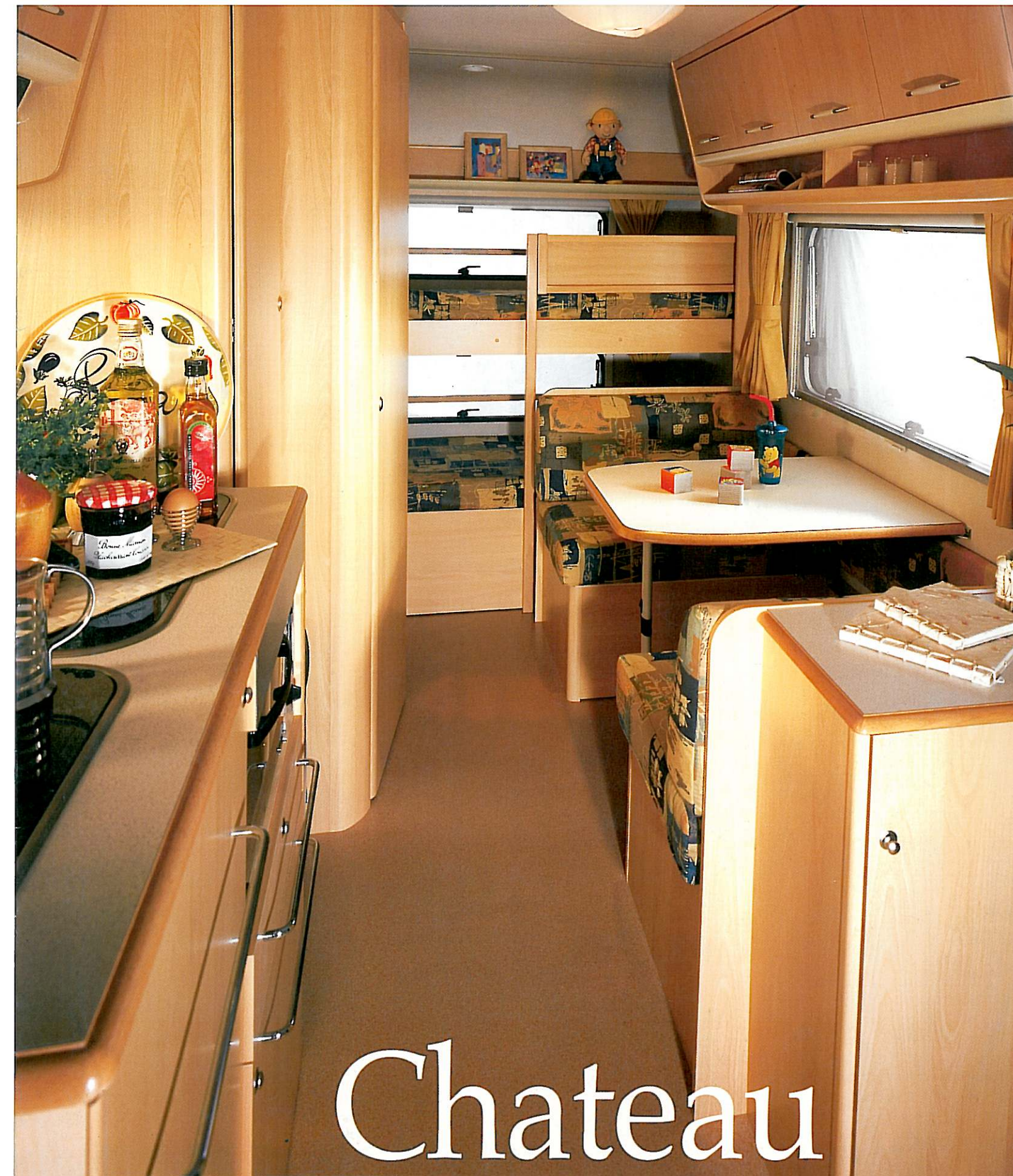

# Chateau

Combining innovation with classic continental style

2001

**LUNAR**  
WE PUT YOU FIRST



# Chateau

Combining innovation with classic continental style...

Lunar's Chateau range combines all that's best from its European pedigree with a variety of enhancements to suit the UK market, such as the VERY British three window front.

The sturdy exterior features an uncluttered 'A' frame section which, because it is longer than usual, gives superb touring stability, whilst the gas locker storage has such easy access that even the water container is readily accessible.

A keen pricing policy ensures that the three family layouts offer unrivalled value for money, creating the opportunity for all caravanners to afford a high quality brand new model with a comprehensive specification to suit today's needs.

## Chateau specifications include

- 12v reading lights
- TV aerial point
- Truma gas and electric water heater, plumbed to both the kitchen and the washroom
- Truma flued room heater
- Smoke alarm
- One key number to suit all locks
- Isolation taps for gas appliances
- Rugged furniture hinges and handles
- Awning light
- 12v charger/mains transformer
- Electrolux gas and electric fridge with freezer compartment
- Blinds and flyscreens to all windows
- 3 burner hob
- Separate grill
- 2 x mains sockets
- 12v reading lights at children's bunks
- Mains electric exterior connection
- Two part exterior door
- Exterior door features sturdy easy-grip handle
- Al-Ko galvanised steel chassis
- External battery locker
- Gas bottle storage with recess for steady winder
- Fully insulated: Walls to 26mm  
Floor to 39mm  
Ceiling to 40mm
- Fitted cassette toilet
- Bed ventilation boards to improve airflow and reduce condensation
- Free-standing, easy fold main dining table in the Chateau 500
- Long 'A' frame 'suitable for a cycle rack for the more energetic'
- Easy clean vinyl flooring
- Large cutlery tray
- Kitchen waste bin



Front cover: Chateau 500  
Inside spread: Chateau 400





# Chateau Range

Model	Chateau 400	Chateau 450	Chateau 500
Internal Body Length	4.06m 13'4"	4.40m 14'5"	4.96m 16'3"
Overall Length	6.01m 19'8"	6.30m 20'8"	6.91m 22'8"
Internal Body Width	2.06m 6'9"	2.06m 6'9"	2.06m 6'9"
Overall Width	2.20m 7'2"	2.20m 7'2"	2.20m 7'2"
Maximum Internal Height	1.90m 6'3"	1.90m 6'3"	1.90m 6'3"
Overall Height	2.57m 8'5"	2.57m 8'5"	2.57m 8'5"
Tyre Size (5 stud)	165 R 13 C 8	165 R 13 C 8	175 R 14 C 8PR
Coupling Height	440mm 17"	440mm 17"	440mm 17"
Mass in Running Order	880 kg	935 kg	1030 kg
Total User Payload	220 kg	250 kg	240 kg
MTPLM*	1100 kg	1185 kg	1270 kg
Bed Sizes	Double	2.02m x 1.38m 6'7"x 4'6"	2.02m x 1.38m 6'7"x 4'6"
	Single		1.82m x 0.8m 6'0" x 2'7"
	Bunk	1.68m x 0.64m 5'6" x 2'1"	Two 1.89m x 0.65m 6'2" x 2'2"
	Double	1.98m x 1.38m 6'6"x 4'6"	2.02m x 1.13m 6'7"x 3'8"
Awning - ground to ground	850cm	876cm	925cm

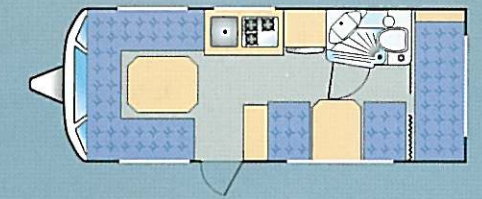
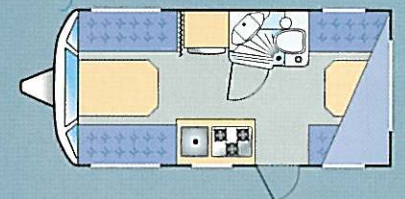
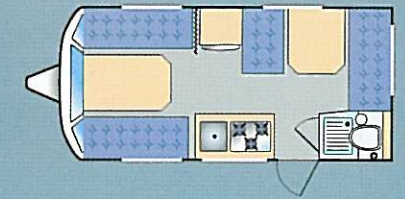

Chateau 450 and 500



All Chateau models



All Chateau models

**LUNAR**  
WE PUT YOU FIRST

## Lunar Caravans Limited

Sherdley Road • Lostock Hall • Preston • Lancashire • PR5 5JF

Telephone: 01772 337628 • Facsimile: 01772 627722

Website: [www.lunarcaravans.com](http://www.lunarcaravans.com)

The contents of this brochure are as accurate as possible at the time of going to print. Lunar Caravans Ltd reserve the right to alter materials, specifications, price and model ranges as conditions demand. This brochure does not constitute an offer. ©2001 Lunar Caravans Ltd.

Designed and produced by Creative Marketing Solutions 015242 63820.