



Above: Vogue 600



Above: Vogue 470



Above: Vogue 600

Exteriors offer one-piece, thick gauge, high gloss, aluminium sidewalls, 6'5" headroom and on some models, 7'6" wide bodyshells, while alloy wheels and a Status 530 directional TV aerial come as standard.

Abbey warranty cover for your peace of mind

Complete customer satisfaction is always a top priority at Abbey and the quality ethos extends to the after sales service and market-leading manufacturer's warranty package that comes with every new Abbey caravan. This is designed to give customers confidence in the latest generation of touring caravans.

Six-year bodyshell integrity guarantee

The guarantee extends to the following items:-

Body leaks and delamination: water ingress through any permanently sealed seam joints or delamination of panels and floor, being part of the original manufacturer's construction.

The manufacturer will honour the guarantee for 72 months from the date of purchase, provided that the caravan has had an Annual Service including a damp meter test, within 90 days before or 60 days after each anniversary of the original date of purchase (or hire purchase). The sixth Annual Service must, however, be carried out before the expiry of the 72 month period from the original date of purchase (or hire purchase).

Three-year SuperSure manufacturer's warranty

The manufacturer will honour the warranty for 36 months from the date of purchase (or hire purchase), provided that the caravan has had an Annual Service within 90 days before or 60 days after each anniversary of the original date of purchase (or hire purchase). The third Annual Service must, however, be carried out before the expiry of the 36 month period from the original date of purchase (or hire purchase).

In the first 12 months the warranty will cover:

Faults arising from a manufacturing defect but not those which are a result of normal wear and tear or those which relate to replacement light bulbs.

Also not covered under the first year are faults resulting from accidental damage or damage caused by misuse of any component part of the caravan.

In the years two and three the warranty will cover:

- 1 Original components of the caravan including permanently fitted equipment forming part of the manufacturer's original specification.*
- 2 Water ingress and body delamination.

* There are certain exclusions. For the full terms and conditions of these warranties please refer to the warranty section in the Owner's, Service and Warranty Handbook, or check the details on our website.

Details of your nearest authorised Abbey Service Centre can be obtained by contacting the Swift Group Customer Care Department on 01482 875740 or enquiring on our website: www.abbeycaravans.co.uk



All Abbey models have been certified by the National Caravan Council for compliance with stringent European Standards, British Legislation and industry set Codes of Practice specifically relating to health and safety issues.

The approval process covers the testing and inspection of critical areas of the product from fire safety, weights and dimensions, to gas, electrics and ventilation. Every Abbey caravan carries the "NCC Approved Caravan" badge.

The NCC also conduct unannounced inspections at the Swift Group factory to ensure continued compliance. NCC Approval gives you peace of mind that your caravan is legal and safe..



Leaders in Leisure

Abbey Caravans,
Dunswell Road, Cottingham,
East Yorkshire HU16 4JX.

Tel: 01482 847332 Fax: 01482 841042

email: enquiry@swiftleisure.co.uk

website: www.abbeycaravans.co.uk

A MEMBER OF THE SWIFT GROUP

ABBHEY VOGUE



Your Local Dealer

This brochure does not constitute an offer by Swift Group Limited (Swift). Swift reserves the right to alter specifications and prices at any time as materials and conditions demand. Distributors and dealers sell Abbey products on their own account and not as agents of Swift. Accordingly, they have no authority to bind Swift or to make any representation or undertaking whatsoever on behalf of Swift.

All props are for photographic purposes only and are not included in the specification.
Issued August 2007.



ABBEEY VOGUE

The trend setting Abbey Vogue range welcomes two new spacious twin-axle layouts, a four-berth with island bed and a family size six-berth, making a total of 10 superb layouts and ensuring an excellent choice for couples and families.



Refined
and stylish
interiors

Add contemporary styling, high specification and affordable pricing, and this immensely popular range has so much to offer.

Key features include shower cubicles or separate shower areas in all models and, in twin axles, a 40-litre underfloor, insulated fresh water tank.



Above: Radio/CD/MP3 Player (optional extra)

Above: Microwave (optional extra)

Above: Insulated Water Tank (twin axle models)



Left: Vogue 620

Above: Vogue 520

Specification

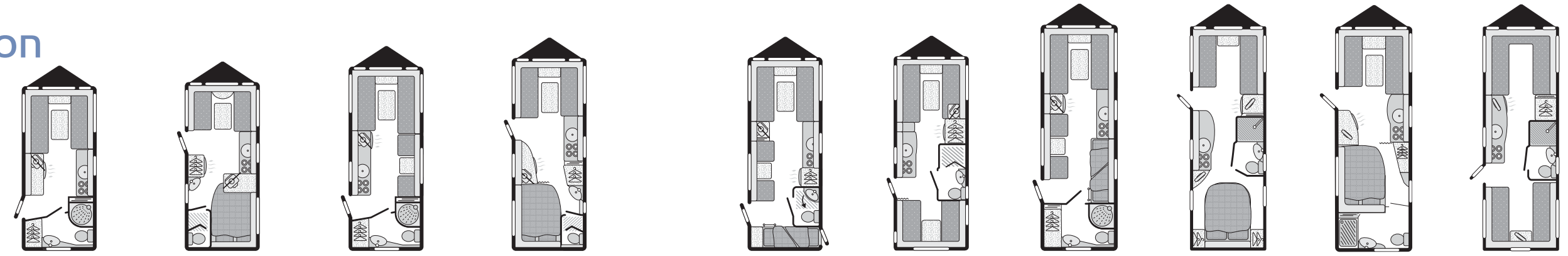

MODEL	460	470	520	495	540	530	600	610	620	650
Berths	2	4	4	4	6	5	6	4	4	6
Number of Axles	1	1	1	1	1	1	2	2	2	2
Internal Length (at bed box height)	4.67m/15'4"	4.74m/15'7"	5.23m/17'2"	5.50m/18'1"	5.50m/18'1"	5.60m/18'4"	6.27m/20'7"	6.27m/20'7"	6.27m/20'7"	6.27m/20'7"
Overall Width	2.23m/7'4"	2.23m/7'4"	2.23m/7'4"	2.29m/7'6"	2.23m/7'4"	2.23m/7'4"	2.23m/7'4"	2.29m/7'6"	2.29m/7'6"	2.29m/7'6"
Overall Height (including TV aerial)	2.70m/8'10"	2.70m/8'10"	2.70m/8'10"	2.70m/8'10"	2.70m/8'10"	2.70m/8'10"	2.70m/8'10"	2.70m/8'10"	2.70m/8'10"	2.70m/8'10"
Headroom (max)	1.95m/6'5"	1.95m/6'5"	1.95m/6'5"	1.95m/6'5"	1.95m/6'5"	1.95m/6'5"	1.95m/6'5"	1.95m/6'5"	1.95m/6'5"	1.95m/6'5"
Overall Length	6.35m/20'10"	6.42m/21'1"	6.91m/22'8"	7.18m/23'7"	7.18m/23'7"	7.28m/23'11"	7.95m/26'1"	7.95m/26'1"	7.95m/26'1"	7.95m/26'1"
Mass in Running Order (including tolerance)*	1118kg/22.0cwt	1112kg/21.9cwt	1222kg/24.1cwt	1254kg/24.7cwt	1269kg/25.0cwt	1273kg/25.1cwt	1430kg/28.1cwt	1435kg/28.2cwt**	1435kg/28.2 cwt	1440kg/28.3cwt**
Essential Habitation Equipment Payload	68kg/1.3cwt	68kg/1.3cwt	68kg/1.3cwt	68kg/1.3cwt	68kg/1.3cwt	68kg/1.3cwt	104kg/2.0cwt	104kg/2.0cwt	104kg/2.0cwt	104kg/2.0cwt
Personal Effects Payload	104kg/2.0cwt	125kg/2.5cwt	130kg/2.6cwt	133kg/2.6cwt	153kg/3.0cwt	144kg/2.8cwt	160kg/3.1cwt	140kg/2.8cwt	140kg/2.8cwt	160kg/3.1cwt
Optional Equipment Payload	5kg/0.1cwt	5kg/0.1cwt	5kg/0.1cwt	5kg/0.1cwt	10kg/0.2cwt	5kg/0.1cwt	6kg/0.1cwt	6kg/0.1cwt	6kg/0.1cwt	6kg/0.1cwt
Maximum Technical Permissible Laden Mass	1295kg/25.4cwt	1310kg/25.8cwt	1425kg/28.1cwt	1460kg/28.7cwt	1500kg/33.0cwt	1490kg/29.3cwt	1700kg/33.3cwt	1685kg/33.1cwt**	1685kg/33.1cwt	1710kg/33.5cwt**
Awning A/A Dimension†	8.88m/29'2"	8.95m/29'4"	9.44m/31'0"	9.71m/31'10"	9.71m/31'10"	9.81m/32'2"	10.48m/34'5"	10.48m/34'5"	10.48m/34'5"	10.48m/34'5"
Tyre Size	195/70 r14 96	195/70 r14 96	175 r14 99	175 r14 99	175 r14 99	175 r14 99	175/65 r14 82	175/65 r14 82	175/65 r14 82	175/65 r14 82
Alternative Tyre Size	175 R14 99	175 R14 99								

BED SIZES	460	470	520	495	540	530	600	610	620	650
Front Double	208cm x 180cm/6'10" x 5'11"	208cm x 134cm/6'10" x 4'5"	208cm x 180cm/6'10" x 5'11"	213cm x 159cm/7'0" x 5'3"	208cm x 180cm/6'10" x 5'11"	208cm x 180cm/6'10" x 5'11"	208cm x 180cm/6'10" x 5'11"	213cm x 167cm/7'0" x 5'6"	213cm x 167cm/7'0" x 5'6"	213cm x 190cm/7'0" x 6'3"
or One Single	180cm x 72cm/5'11" x 2'4"		190cm x 72cm/6'3" x 2'4"	167cm x 72cm/5'6" x 2'4"	180cm x 72cm/5'11" x 2'4"	180cm x 72cm/5'11" x 2'4"	180cm x 72cm/5'11" x 2'4"	167cm x 72cm/5'6" x 2'4"	167cm x 72cm/5'6" x 2'4"	190cm x 72cm/6'3" x 2'4"
and One Single	190cm x 72cm/6'3" x 2'4"		180cm x 72cm/5'11" x 2'4"	159cm x 72cm/5'3" x 2'4"	180cm x 72cm/5'11" x 2'4"	190cm x 72cm/6'3" x 2'4"	190cm x 72cm/6'3" x 2'4"	190cm x 72cm/6'3" x 2'4"	190cm x 72cm/6'3" x 2'4"	190cm x 72cm/6'3" x 2'4"
Rear Double		188cm x 138cm/6'2" x 4'6"		192cm x 138cm/6'4" x 4'6"		208cm x 124cm/6'10" x 4'1"		186cm x 134cm/6'1" x 4'5"	190cm x 137cm/6'3" x 4'6"	213cm x 178cm/7'0" x 5'10"
Rear Bunk						190cm x 56cm/6'3" x 1'10"				
Side Single (offside)			180cm x 70cm/5'11" x 2'4"							189cm x 71cm/6'2" x 2'4"
Side Single (nearside)					180cm x 70cm/5'11" x 2'4"		180cm x 70cm/5'11" x 2'4"			178cm x 71cm/5'10" x 2'4"
Side Bunk (offside)			176cm x 59cm/5'9" x 1'11"							176cm x 59cm/5'9" x 1'11"
Side Bunk (nearside)					178cm x 59cm/5'10" x 1'11"		176cm x 59cm/5'9" x 1'11"			164cm x 59cm/5'5" x 1'11"
Rear Fixed Lower Bunk					180cm x 62cm/5'11" x 2'1"					
Rear Fixed Upper Bunk					184cm x 60cm/6'0" x 2'0"					
Side Fixed Lower Bunk							180cm x 56cm/5'11" x 1'10"			
Side Fixed Upper Bunk							180cm x 58cm/5'11" x 1'11"			

† Note on awning sizes: Due to the varying awning designs and sizes the awning sizes given are approximate only. Specific awning sizes must be confirmed by your dealer or the awning manufacturer prior to purchase.

†† Double bed size is quoted with wrap round seating.

* MRO includes microwave oven and radio/CD options.
** Estimated weight.

Body and Exterior Equipment

- Overall body width 2.23m/7'4" or 2.29m/7'6" (see specification table)
- AL-KO galvanised steel chassis with Euro-Axle
- AL-KO Euro overrun device with two-way assisted handbrake
- AL-KO AKS 3004 Stabiliser
- Hitch and A-frame cover with plug ties
- 14" Alloy wheels
- Spare wheel (steel) and underslung carrier
- Moulded front panel with three opening windows and door with gas struts
- Moulded rear panel with rear light clusters and high-level brake light
- One-piece, high gloss, thick gauge aluminium sidewalls
- Heki large tilting panoramic roof window with flynet and blind

- Fully double-glazed opening windows (no single-glazed cold areas) with silver finished edges
- Exterior two-part door with interior moulded liner, window, blind and waste bin
- Exterior access battery box with mains electric inlet (battery not included)
- Flush fitting awning light
- Fixing points for rear-mounted cycle rack
- 25mm 'sandwich' sidewalls with HD polystyrene insulation core
- 32mm semi-'sandwich' roof with HD polystyrene insulation core
- 44mm 'sandwich' floor with Styrofoam insulation core

Living Area

- Internal headroom 1.95m/6'5"
- Large upper lockers with spaceframe construction

- Seat bases with spaceframe construction, full front access and space for larger items
- Fixed beds with aluminium frames to maximise strength and storage space
- Hinged seat and bed tops supported in open position for easy access
- Mattresses and seat cushions supported by beech slats for extra comfort
- Sprung interior mattresses, seat and backrest cushions
- Seat and backrest ventilation boards
- Long front beds 1900mm (6'3") (model specific)
- Chest of drawers with occasional table (except 470)
- Solid ash worktop edges
- Free-standing table with dedicated storage location
- 2 x scatter cushions
- 2 x bolster cushions

- Twin curtain track for improved hanging and ease of use
- Removable carpets over woodblock effect vinyl flooring
- Analogue clock

Kitchen

- Microwave oven locker (optional built-in microwave oven)
- 107 litre fridge with curved door, electronic ignition and single energy and temperature controls
- Recessed stainless steel bowl
- Removable drainer with dedicated storage
- Food grade nylon chopping board with dedicated storage
- Chrome finish brass pillar tap with long spout
- Stoves thermostatic oven and separate grill
- Stoves dual fuel hob with 800W electric hotplate and 3 gas burners with electronic ignition and flame failure protection

- Glass hob lid with safety cut-out feature
- Moulded cutlery drawer on smooth steel runners

Washroom

- Washbasin and mirror-wall pivot to create dry area for toilet, washbasin, mirror, towels etc and area for showering in 540
- Shower cubicles in the 460, 520, 600, 610, 620 and 650
- Shower separated by bi-fold doors in the 470 and 495
- Thetford cassette toilet with independent tank and manual flush
- Chrome finish brass shower and washbasin mixer taps
- Multi-directional rooflight with flyscreen

Fittings and Equipment

- Omni-vent extractor fan and rooflight

- Cassette flyscreens and blinds on all windows
- Full height door flyscreen
- Multi-directional clear rooflight with flyscreen and blind
- Gas regulator for Propane and Butane mounted on front bulkhead
- Isolation taps for gas appliances
- Smoke alarm
- Entrance step
- Removable entrance mat
- Domestic style cabinet hinges

Heating and Plumbing

- Dual fuel gas and 800W mains electric storage water heater
- Dual fuel 3kW gas and 2kW electric space heater
- Blown air system ducted to living, sleeping and washroom areas
- Areas under seats and beds warmed by blown air system
- Grade 2 classification for heating and thermal insulation

- 40 litre underfloor insulated fresh water tank (twin axle models only)
- Wheeled waste water tank (twin axle models only)
- In-board semi-rigid fresh water pipes
- In-board water pump with self priming and pressure regulating accumulator
- Large bore underslung rigid waste pipes

Electrical

- Fully protected mains electric system with two 230V sockets
- 18 Amp switchmode charger/transformer
- 12V control panel with battery state meter, tank level indicator, car/caravan battery switch and water pump switch
- Solar panel connection provision
- Status 530 directional TV/FM aerial and booster

- Radio/CD housing, aerial, speakers and wiring (Radio/CD/MP3 player optional)
- TV station with 230V, 12V and coax aerial sockets
- 230V mains lights over front seating
- Halogen ceiling lights in living and washroom areas
- Halogen adjustable downlights in lounge/sleeping areas
- Fluorescent light in kitchen
- 25 metre mains hook-up cable

Safety and Security

- CRIS identity number etched to windows and caravan chassis
- Concealed security data chip within caravan construction
- Single key for all locks
- All models comply with British and European safety standards