

# Luxury from Lunar 2009 Motorhome Range

Your Authorised Lunar Dealer:

Updated Information:

**The Lunar Owner's Club** When you choose Lunar you have a great, exclusive opportunity to join the growing band of enthusiasts that enjoy all the special benefits of being a Lunar Owner's Club member.

As a Owner's Club member you will receive regular information-packed newsletters with all the latest news on forthcoming events, letters from fellow members and the inside track on the new developments from Lunar Caravans themselves.

Every member is welcome at the Club's numerous exclusive rallies across the UK, you'll meet a host of new friends who share a common interest in enjoying a caravan or a motorhome holiday in a Lunar. These seasoned veterans can also offer a wealth of knowledge and expertise to help you enjoy touring at its VERY BEST.

For further information and details on how to join please visit [www.lunarownersclub.net](http://www.lunarownersclub.net)



*Live a Lunar Life*

[www.lunarcaravans.com](http://www.lunarcaravans.com)

Sherdley Road, Lostock Hall, Preston, Lancashire PR5 5JF Tel: 01772 337 628 Fax: 01772 627 722 Email: [sales@lunarcaravans.com](mailto:sales@lunarcaravans.com)



## Contents

**02 - Lunar Motorhomes**  
The 2009 Star range

**03 - The Lunar Landscape**  
40 Years of Excellence

**04 - Roadstar 900**  
The twin axle flagship of the Lunar range

**06 - Roadstar**  
Seven models of the Luxurious Roadstar range with optional layouts as well as a host of standard equipment

**10 - Goldstar**  
The new fixed bed 650 and the popular 620 offer amazing value for money

**12 - Moonstar**  
Exceptional value these two models are packed with quality features

**14 - Telstar/Xstar/Fivestar**  
The appeal of these Renault based models is the one piece low profile roof and the narrow 7 feet body width of the Telstar and Xstar

**16 - Chassis & Engine Details**  
Lunar use two award winning chassis cabs the Fiat and the Renault for the base units to all our Motorhomes

**18 - Features at a Glance**

**Important Note:** Whilst the contents of this brochure are correct at time of going to print, Lunar Caravans reserve the right to alter materials, specification and prices without prior notification. It should be noted that distributors and dealers are not the agents of Lunar Caravans Limited and are therefore NOT authorised to bind the Company by any specific or implied undertaking or representation.

Please note that the props and bedding featured in the pictures within this brochure are for display purposes only and are NOT included within the purchase price of the motorhome.

The information and images contained in this brochure are strictly copyright ©2008 Lunar Caravans and may not be reproduced in any way without express permission.



# Lunar Motorhomes 2009



*Live a Lunar Life*

## The Lunar Landscape

Lunar are now entering their 40th season of producing quality leisure vehicles and the wealth of experience in our design team with our uncompromising attitude to build a quality product, our meticulous attention to detail and the use of the very best equipment ensure that the new 2009 product continue to set a benchmark for others to follow. Comfortable, practical, economical, luxurious and affordable can all be used to describe the 2009 range of Lunar Motorhomes.

Lunar was established in 1969 by co-founders Brian Talbot and Ken Wilcock, both of whom worked as joiners for Knowsley Caravans, before setting up Lunar.

In 1969, inspired by the moon landing mission Brian and Ken chose 'Lunar' as the name of their caravan manufacturing business. Initially based at Earnshaw Bridge, Farington, near Preston, Lunar then moved to a former mill site in Lostock Hall. In 1971 they renovated the Lostock Hall site using their own joinery and building skills to incorporate a storage area and manufacturing plant and in 1975 Lunar ventured into the holiday home and motorhome markets to complement its touring caravan range.

In 2000 Lunar was purchased from Brian Talbot and Ken Wilcock by the Tirus Group who already had a number of caravan and motorhome manufacturing plants in Europe. It remained under their ownership until November 2007 when a management buyout secured the company's return to British ownership.

Now freed from its European shackles Lunar has already invested in new facilities and looks forward to many more years of successful manufacturing.

# 2009 Roadstar 900



The Roadstar has been the flagship of the Lunar motorhome ranges for many years and the twin axle 900 more than lives up to this Star billing. Offering all the space you would ever need in a motorhome, the Roadstar 900 has the added luxury of a full end washroom and two dedicated fixed single beds with luxurious thick sprung mattresses. With two seat belts at the front dinette and a unique swivel to transform the dinette into a L shaped seating area the 900 is perfect for every eventuality.

The host of features that are standard in the 900 include, rear twin axle, cab air conditioning, cruise control, a gas/electric hob unit, special mood lighting in the over-cab bed area, LED reading lights, fully fitted flush awning incorporated in the exterior design, all-fibre side panels giving the benefit of robust good looks that are complimented by the superb new alloy wheels together with the smart exterior graphics. Optional soft furnishing schemes are available including a fabulous cream leather.



## Key Features

- Aluminium Fibre Side Panels
- One Piece Roof Panel
- Hinged Gas Locker Storage
- Exterior access locker doors with large storage area
- Integral awning
- Roof Rack and Ladder
- Luxurious Sprung Mattress
- New High Quality Belgian Furnishing Fabrics
- Duel Fuel Hob Unit
- Microwave Oven
- Color Keyed Thermostatically Controlled Oven Hob & Grill
- 3 Way Fridge ( Gas / 12V / 230V) 175L
- Webasto Diesel / Mains Heating with Blown Air Ducting
- Mains Electric Charger / Transformer
- LED Reading lights
- Ceramic Domestic Style Swivel Toilet - Electronic Flush
- Cab Air Conitioning
- Cruise Control



A Stylish new furniture handles across all Roadstar models

B The Roadstar 900 rear view showing the kitchen and sleeping areas

C The front lounge area featuring the stunning optional leather upholstery

D Luxurious Washroom with ceramic toilet

E The rear twin single beds

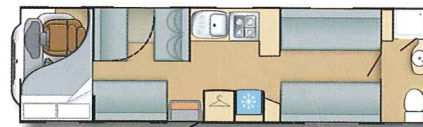

Roadstar 900

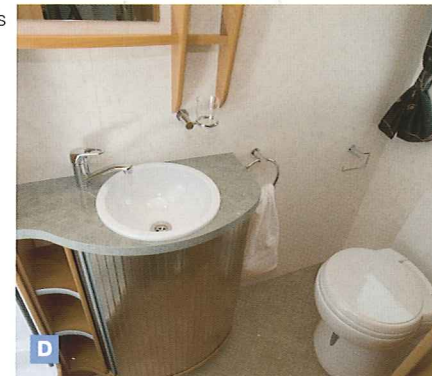

# 2009 Roadstar Range

The seven layouts of the single axle Roadstar range ooze quality, comfort and luxury at every turn as well as offering the very best of the most popular layouts

The Roadstar 726 has a large rear lounge area, central toilet/shower room, front kitchen and offside front dinette. The front dinette has two forward facing seat belts and the swivel arrangement unique to Lunar that converts the dinette into L shape seating.

A fixed bed with a new aluminium frame and luxurious thick sprung mattress, is a new feature of all Roadstar models the 780 having an optional front layout of lounge seats or a full dinette with two lap and diagonal inertia reel seat belts a centre kitchen and a half garage at the rear.

The ever popular Roadstar 786 continues with its completely separate rear shower, toilet and vanity unit, offside fixed bed and kitchen and front lounge seats with swivel driver and passenger seats. A half dinette at the front including two lap and diagonal inertia reel seat belts is available on both the 786 and 800.

The Roadstar 800 with a separate shower unit, separate toilet compartment and a large island bed now boasts the 175 litre separate fridge/freezer and the Webasto diesel/mains electric heating as standard.

The feast of standard equipment in the Roadstar models include, a new Thetford ceramic toilet (except 726), cab air conditioning, cruise control, an integral awning, dual fuel hob unit, microwave oven, full oven and grill, dual fuel heating and water heating, electric foldaway step and swivel driver and passenger seats. Subtle changes including, domestic style toilet door and handle, new silver furniture handles and socket surrounds, taps and vanity units, an over-cab pre-formed trim, new entrance door and lower furniture doors and LED reading lights means that the Roadstar range will meet the challenge of the coming season.



A

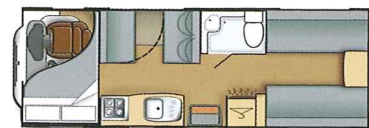

Roadstar 726

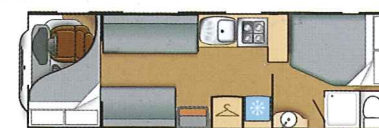

Roadstar 780 TSB



Roadstar 786 HD

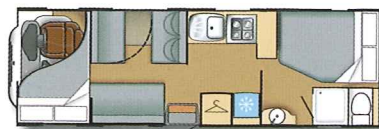

Roadstar 780



Roadstar 786

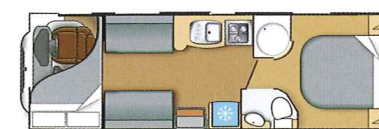

Roadstar 800



Roadstar 800 HD

*Live a Lunar Life*

- A The front seating area of the Roadstar 786 – pictured here with 'Sarah' upholstery.
- B The Roadstar 780 pictured in 'Karamba' upholstery
- C High quality exterior doors are a feature on all Roadstar models
- D Stylish alloy wheels
- E Eye-catching over-cab bed window



B



C

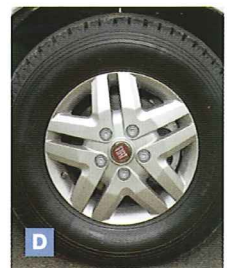

D



E

## 2009 Roadstar Range



**A** New furniture door handles

**B** Dual fuel Hob with separate Oven and Grill

**C** Full size fridge/freezer now in the Roadstar 800

**D** The Roadstar 800 featuring the very popular island bed layout

**E** Washrooms now featuring the new Thetford Ceramic toilet on 800/786 and 780 models

**F** Roadstar 786 rear with spacious offside fixed bed and rear washroom.



### Key Features

- Aluminium Fibre Side Panels
- One Piece Roof Panel
- Hinged Gas Locker Storage
- Double floor for extra insulation and storage
- Integral awning
- Roof Rack and Ladder
- Luxurious Sprung Mattress
- New High Quality Belgian Furnishing Fabrics
- Dual Fuel Hob Unit
- Microwave Oven
- Color Keyed Thermostatically Controlled Oven Hob & Grill
- 3 Way Fridge ( Gas / 12V / 230V) 175L - 780,786 and 800 Only
- Webasto Diesel / Mains Heating with Blown Air Ducting on Roadstar 800 and 800HD Models
- Mains Electric Charger / Transformer
- Ceramic Domestic Style Swivel Toilet - Electronic Flush on 800/786 and 780 models
- Cab Air Conditioning
- Cruise Control

# 2009 Goldstar Range

The Goldstar 620 is joined for 2009 by an all new Goldstar 650 which features a rear offside fixed bed, separate shower/toilet room and a half dinette at the front that easily converts into a double bed. Two lap and diagonal inertia reel seat belts and a swivel drivers and passenger seats enable this compact model to cater easily for a family of four.

The 620 has two long rear lounge seats with a central chest of drawers with occasional table and also boasts a separate shower within the toilet room and a central kitchen unit.

The standard features not only include all those mentioned under the Moonstar but also a colour co-ordinated white bumper, rear spoiler with high level brake light, a choice of two top quality Belgian upholstery fabrics with matching curtains, mood lighting in the over-cab bed area, an easily adjustable bracket for a flat screen TV and a microwave in the kitchen. Modern silver furniture handles with matching 230volt socket surrounds, taps and bathroom fittings, an over-cab lining trim and a domestic toilet door and handle are new features for 2009

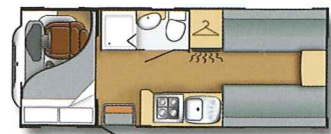

Goldstar 620

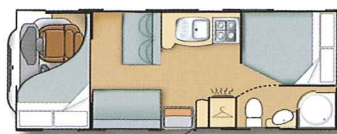

Goldstar 650

- A** Microwave as standard on both Goldstar models
- B** Goldstar soft furnishings in 'Italy' upholstery
- C** Stylish bathroom fittings
- D** The brand new Goldstar 650 with offside fixed bed
- E** Stylish spot reading lights
- F** TV compartment with bracket for a flatscreen TV



## Key Features

- Hinged Gas Locker Storage
- Double Floor for extra Insulation and storage of wiring
- Flyscreens and Blinds to all Opening Windows ( Ex Cab )
- Swivel Passenger Seat Base
- New High Quality Belgian Furnishing Fabrics
- Sprung Mattress for Fixed Bed
- Microwave Oven
- Color Keyed Thermostatically Controlled Oven Hob & Grill
- TV Compartment with bracket for Flat Screen TV
- Mains Electric Charger / Transformer



# 2009 Moonstar Range

The Moonstar range has two extremely popular and practical layouts, a 570 and 580. The 570 has a rear kitchen, an offside front dinette with two lap and diagonal inertia reel seat belts and a rearward seat that will easily swivel to form a comfortable L shape lounge. A long nearside settee and a rear corner toilet/shower room complete this original layout based on a traditional theme.

A large rear lounge area, a central chest of drawers with an occasional table top and a centre kitchen and toilet/shower room is the layout of the 580.

A host of features are standard in the Moonstar including a unique double floor for added insulation and unobtrusive snag free neat installation of the pipe work and wiring. A robust exterior door with two locking catches, one top and one bottom, gives added security, complete with a window and blind. For ease of use the Moonstar has a large slide out gas locker that will accommodate a 13kg and a 6kg gas bottle. A large hidden storage space behind the driver and passenger seat utilises what would otherwise be dead space and epitomises the attention to detail of our design team.

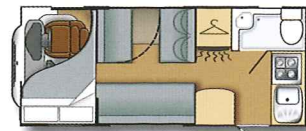

Moonstar 570

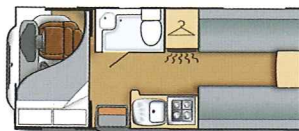

Moonstar 580

## Key Features

- Hinged Gas Locker Storage
- Double Floor for extra insulation and storage of wiring
- Flyscreens and Blinds to all Opening Windows (Ex Cab)
- New High Quality Belgian Furnishing Fabrics
- Color Keyed Thermostatically Controlled Oven Hob & Grill
- Truma 3002 3Kw Gas heating System with Blown Air Ducting
- Mains Input to RCCD
- Mains Electric Charger / Transformer



- A** Moonstar 570 kitchen area with separate oven and grill, integrated sink and drainer and 97L fridge
- B** Separate Oven and Grill with a elegant silver finish
- C** Spot reading lights
- D** Rear view of the Moonstar 570 featuring soft furnishings in 'Barney Green' upholstery.
- E** Rear view of the optional wrap around seating in the Moonstar 580
- F** The compact yet practical bathroom

# 2009 Telstar/Xstar/Fivestar

Stylish, robust and compact this range of Star models is built on the award winning Renault chassis cab. The meticulously designed interiors have fully fitted kitchens with thermostatically controlled gas ovens and curved fronted Dometic gas/electric fridges for starters. With high specification these low profile, coach built Motorhomes must be seen to be appreciated.

The spaciousness of the compact Telstar and Xstar belie their narrow 7' wide body.

The rear lounge and central chest of drawers with occasional table top of the Xstar and front offset lounge seats of the Telstar offer two of the most popular layouts for two people. Supporting new graphics and a new stunning soft furnishing scheme for 2009 these Renault based vehicles are further enhanced by subtle changes throughout.

The Fivestar fixed rear bed now has an aluminium frame and has been raised to allow a larger exterior access locker door to be fitted.



- A** The L-shaped swivel front seating area of the Fivestar.
- B** Stylish alloy wheels
- C** The driver seat and L-shaped front seating pictured here in the Fivestar

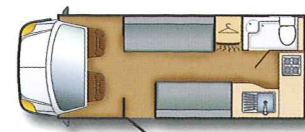

Telstar

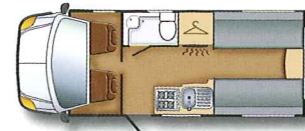

Xstar

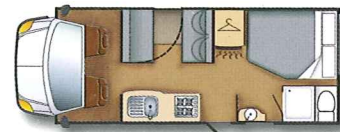

Fivestar



E

## Key Features

- One Piece Roof Panel
- Low Profile Model
- Swivel Passenger Seat Base
- Swivel Driver Seat Base
- New High Quality Belgian Furnishing Fabrics
- Color Keyed Thermostatically Controlled Oven Hob & Grill
- Truma 3002 3Kw Gas heating System with Blown Air Ducting
- Mains Electric Charger / Transformer
- Optional GT Pack- including DVD, AM/FM Radio, 10.5" flat screen colour TV, Digital Freeview Box, 3.5m Awning and a Microwave Oven



H

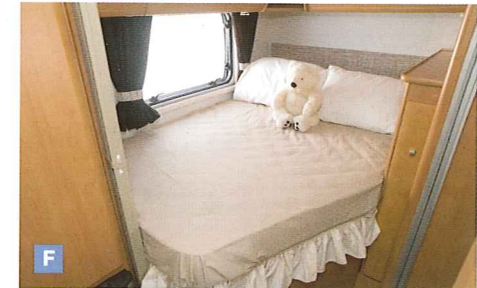

F



G

**D** Elegant rear light clusters

**E** Front lounge of the Fivestar with 'Kylie' upholstery

**F** The rear fixed bed of the Fivestar now with an aluminium bed frame

**G** The vast working area of the Telstar kitchen

**H** Soft furnishings in 'Kylie' upholstery

**I** The washroom area in the Telstar

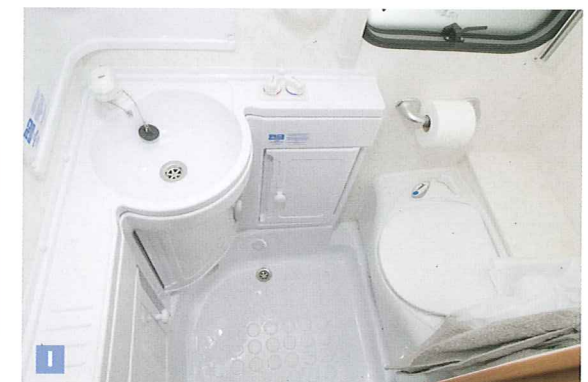

I





*Live a Lunar Life*

# 2009 Lunar - Chassis & Engine Details

	Roadstar 900	Roadstar Range	Goldstar Range	Moonstar Range	Fivestar/Xstar & Telstar
FIAT 100 2,2 Multijet 5 Speed	-	-	-	○	-
FIAT 130 2,3 Multijet 6 Speed	-	-	●	●	-
FIAT 160 3.0 Multijet 6 Speed	●	●	○	○	-
RENAULT 120 2.5 dci 6 Speed	-	-	-	-	●
RENAULT 150 2.5 dci 6 Speed	-	-	-	-	○
Automatic Gearbox	○	○	Optional on 160 engine	Optional on 160 engine	○
Cab Air Conditioning	●	●	○	○	○
Power Assisted Steering	●	●	●	●	●
Four Disc Brakes	●	●	●	●	●
ABS and Drivers Airbag	●	●	●	●	●
Heated Electric Door Mirrors	●	●	●	●	●
Central Locking and Electric Windows	●	●	●	●	●
Extended Wing Mirrors	●	●	●	●	●
Lockable Fuel Filler Cap	●	●	○	○	-
Alloy Wheels	●	●	○	○	-
Spare Wheel and Carrier	●	●	●	●	●
Colour Co-ordinated Bumpers	●	●	●	○	●
Twin Rear Axle	●	-	-	-	-
Cruise Control	●	●	○	○	○

● = STANDARD ○ = OPTIONAL - = NOT AVAILABLE

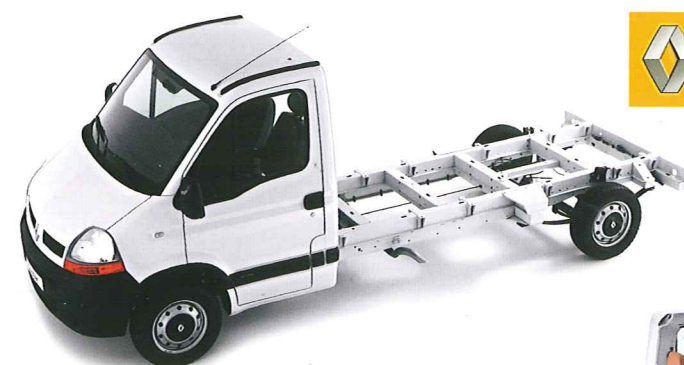

FIAT ENGINE & GEARBOXES	100 MULTIJET 100BHP (250NM)	130 MULTIJET 130BHP (320NM)	160 MULTIJET 157BHP (400NM)
DISPLACEMENT	2198	2287	2999
TYPE	4-IN-LINE CYLINDER DIESEL, MULTIJET DIRECT INJECTION, TURBOCHARGER WITH INTERCOOLER		
GEARBOX	5 SPEEDS	6 SPEEDS	6 SPEEDS
TIMING SYSTEM	CHAIN DRIVE DOUBLE OVERHEAD CAMSHAFT HYDRAULIC TAPPETS 4 VALVES PER CYLINDER	BELT DRIVE DOUBLE OVERHEAD CAMSHAFT CHAIN CAM-TO-CAM HYDRAULIC TAPPETS 4 VALVES PER CYLINDER	CHAIN DRIVE DOUBLE OVERHEAD CAMSHAFT CHAIN CAM-TO-CAM HYDRAULIC TAPPETS 4 VALVES PER CYLINDER
MAX POWER OUTPUT AT RPM	100BHP (74KW) 2900	130BHP (95.5KW) 3600	157BHP (115.5KW) 3500
PEAK TORQUE AT RPM	25.5KGM (250NM) 1500	32.6KGM (320NM) 2000	40.8KGM (400NM) 1700
RENAULT ENGINE & GEARBOXES	dCi 100 100BHP (260NM)	dCi 120 120BHP (300NM)	dCi 150 150BHP (320NM)
DISPLACEMENT	2463	2463	2463
TYPE	TURBOCHARGED 4-IN-LINE CYLINDER DIESEL, COMMON RAIL DIRECT INJECTION		
GEARBOX	6 SPEED MANUAL QUICKSHIFT 6	6 SPEED MANUAL QUICKSHIFT 6	6 SPEED MANUAL QUICKSHIFT 6
TIMING SYSTEM	BELT DRIVE DOUBLE OVERHEAD CAMSHAFT HYDRAULIC TAPPETS 4 VALVES PER CYLINDER	BELT DRIVE DOUBLE OVERHEAD CAMSHAFT HYDRAULIC TAPPETS 4 VALVES PER CYLINDER	CHAIN DRIVE DOUBLE OVERHEAD CAMSHAFT HYDRAULIC TAPPETS 4 VALVES PER CYLINDER
MAX POWER OUTPUT AT RPM	100BHP (74KW) 3500	120BHP (88KW) 3500	150BHP (107KW) 3500
PEAK TORQUE AT RPM	26.5KGM (260NM) 1500	30.6KGM (300NM) 1500	32.6KGM (320NM) 1500

## Warranty

Lunars are famously well built and reliable, but for total piece of mind all Lunar Star Motorhomes are supplied with a six year body shell integrity warranty. The conversion has a one year manufacturers warranty with an additional two years insured warranty with MB&G (Subject to an annual service and inspection and excluding items subject to normal wear and tear). The fiat chassis cab has a three year pan European warranty and the Renault has a two year manufacturers warranty with a third year insured warranty with MB&G

Each Lunar model has been certified by the **NATIONAL CARAVAN COUNCIL** for compliance with stringent European Standards, British Standards AND the industry set Codes of Practice that specifically relate to health and safety issues.

The approvals process covers the testing and inspection of all critical areas of the product from fire safety, weights and dimensions through to gas, electrics and ventilation. In order to ensure Lunar's continuing compliance with their stringent standards, the NCC also carry out unannounced spot inspections at the Company's Preston factory.

Every motorhome carries the NCC Approved badge that gives you the peace of mind in the knowledge that your motorhome is both fully legal AND safe.

## Soft Furnishings

Lunar have carefully selected several soft furnishing schemes for each of their ranges and any of these schemes can be specified in any range subject to availability and a small fee. In addition to this there is a luxurious leather option available.

## MRO Information

The stated Mass in Running Order, 'MRO', includes a manufacturer's tolerance that reflects the varying individual weights of component parts. It is anticipated that the stated figure will NEVER be exceeded in the standard ex-works specification.

# 2009 Features at a Glance



	Roadstar 900	Roadstar Range	Goldstar Range	Moonstar Range	Telstar Xstar Fivestar
<b>Exterior Features</b>					
High Gloss Impact Resistant GRP Side Rear & Roof Panels	-	-	●	●	●
Aluminium Fibre Side Panels	●	●	-	-	-
One Piece Roof Panel	●	●	-	-	●
Gas Storage Locker for 1x 13Kg & 1x 6Kg Gas Bottle	●	●	●	●	2 x 7KG
Hinged Gas Locker Storage	●	●	●	●	-
High Level Break Light	●	●	●	●	●
Rear Corner Stedies	●	●	-	-	○
Acrylic Double Glased Windows ( Ex Cab )	●	●	●	●	●
Large Panoramic Roof Light + Pleated Blinds and Flyscreen	●	●	●	●	●
Fully Insulated walls, floor & Ceiling	●	●	●	●	●
Double Floor for Extra Insulation and Wiring	●	●	●	●	○
Exterior 12v Socket and Pump alongside water filler	●	●	●	●	●
Integral awning	●	●	-	-	-
Individual Rear Road Lights	●	●	●	●	●
Intergrated Lower Step with light	●	●	●	●	●
Roof Rack and Ladder	●	●	○	○	○
One Piece Exterior Door with Window and Blind	●	●	●	●	-
One number Key to Fit All Conversion Locks	●	●	●	●	●
Colour Co-ordinated side and Rear Skirts	●	●	●	●	●
Fitted Gas Regulator	●	●	●	●	●
Awning	●	●	-	-	○
Exterior Access Locker Door	●	●	●	●	●
Full Compliance with NCC Conformaty Standards	●	●	●	●	●
Cruise Control	●	●	○	○	○
<b>Interior Features</b>					
Low Profile Model	-	-	-	-	●
Overcab Bed Model	●	●	●	●	-
Blinds to Cab Windows	○	○	○	○	○
Flyscreens and Blinds to all Opening Windows ( Ex Cab )	●	●	●	●	●
Framed Rosewood Furniture Doors	●	●	●	●	●
Swivel Passenger Seat Base	●	●	●	○	●

## Interior Features (Cont.)

	Roadstar 900	Roadstar Range	Goldstar Range	Moonstar Range	Telstar Xstar Fivestar
Swivel Driver Seat Base	●	●	● in 650/ ○ in 620	○	●
Fixed Cab Rooflight with Pleated Blinds	-	-	-	-	●
Large Grip Handle to Exterior Door	●	●	●	●	●
Drop Flap Access to Underbed Storage	●	●	●	●	●
Unique Swivel Seating at Front Dinette	●	726 & 780	-	570	Fivestar
LED Reading lights	●	●	-	-	-
<b>Soft Furnishings</b>					
Bound Edge Loose Lounge Carpet	●	●	●	●	●
Removable Cab Carpets With Heel Pads	●	●	●	●	●
Luxurious Sprung Mattress	●	●	-	-	-
New High Quality Belgian Furnishing Fabrics	●	●	●	●	●
Sprung Mattress for Fixed Bed	-	-	●	-	●
<b>Kitchen</b>					
Dual Fuel Hob Unit	●	●	○	○	○
Microwave Oven	●	●	●	○	○
Cutlery Drawer	●	●	●	●	●
Isolation Taps for Gas Appliances	●	●	●	●	●
Color Keyed Thermostatically Controlled Oven Hob & Grill	●	●	●	●	●
Ridged Waste Water Pipes	●	●	●	●	●
Stainless Steel Sink	●	●	●	●	●
3 Way Fridge ( Gas / 12V / 230V) 81L	-	-	-	-	Xstar
3 Way Fridge ( Gas / 12V / 230V) 93L	-	-	-	-	Telstar, Fivestar
3 Way Fridge ( Gas / 12V / 230V) 97L	-	-	●	●	-
3 Way Fridge ( Gas / 12V / 230V) 104L	-	726	-	-	-
3 Way Fridge ( Gas / 12V / 230V) 175L	●	780,786, 800,786HD 780TSB 800HD	-	-	-
Thick Laminated Worktops	●	●	●	●	●

Roadstar 900 Roadstar Range Goldstar Range Moonstar Range Telstar Xstar Fivestar

	Roadstar 900	Roadstar Range	Goldstar Range	Moonstar Range	Telstar Xstar Fivestar
<b>Washroom</b>					
Large Washroom Unit with Storage	●	●	●	●	●
Separate Shower / Toilet Compartment	●	786, 786HD, 800, 800HD	620	-	Fivestar
Washroom Window with Flyscreen & Blind	●	●	●	●	●
Theford Cassette Toilet With Electronic Flush	●	All except 726	●	-	Fivestar
Ceramic Domestic Style Swivel Toilet - Electronic Flush	●	All except 726	-	-	-
Theford Cassette Toilet With Manual Flush	-	726	-	●	Telstar, Xstar

	Roadstar 900	Roadstar Range	Goldstar Range	Moonstar Range	Telstar Xstar Fivestar
<b>Heating Systems</b>					
Truma Gas/ 230V Water Heating	●	●	●	●	●
Truma 3002 3Kw Gas heating System with Blown Air Ducting	-	All except 800, 800HD	● in 620	●	●
Truma 2Kw Electric Blown Heating	-	All except 800, 800HD	● in 620	●	●
Webasto Diesel / Mains Heating with Blown Air Ducting	●	800, 800HD	-	-	-
Truma Combi Boiler with blown heating	-	-	650only	-	-
Cab Air Conditioning	●	●	○	○	○

	Roadstar 900	Roadstar Range	Goldstar Range	Moonstar Range	Telstar Xstar Fivestar
<b>Electrical</b>					
TV Compartment with bracket for Flat Screen TV	●	●	●	-	-
12V Reading Lights	●	●	●	●	●
12V TV Sockets	●	●	●	●	●
Mains Input to RCCD	●	●	●	●	●
230V Mains Sockets	●	●	●	●	●
Mains Electric Charger / Transformer	●	●	●	●	●
Auxiliary Battery with Split Charger Relay	110AMP	110AMP	110AMP	110AMP	85AMP
Awning Light	●	●	●	●	●
Electric Control Panel with Battery/ Water Level Indicators	●	●	●	●	●
GT Pack	-	-	-	-	○
Mood Lighting in the over Cab Bed	●	●	●	-	-

● = STANDARD ○ = OPTIONAL - = NOT AVAILABLE

