

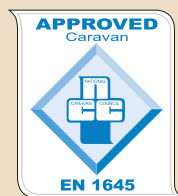

All models are covered by a six-year bodyshell integrity guarantee and come with a three-year SuperSure manufacturer's warranty - See [www.sterlingcaravans.co.uk](http://www.sterlingcaravans.co.uk) for more details

See [www.sterlingcaravans.co.uk](http://www.sterlingcaravans.co.uk) for more model pictures, the gallery is constantly updated as more models are available



This brochure does not constitute an offer by Swift Group Limited (Swift). Swift reserves the right to alter specifications and prices at any time as materials and conditions demand.

Distributors and dealers sell Sterling products on their own account and not as agents of Swift.

Accordingly, they have no authority to bind Swift or to make any representation or undertaking whatsoever on behalf of Swift.

All props are for photographic purposes only and are not included in the specification

Issued September 2009



# Sterling Europa



Sterling Caravans, Dunswell Road, Cottingham, East Yorkshire HU16 4JX.

Tel: 01482 847332 Fax: 01482 841042

email: [enquiry@swiftgroup.co.uk](mailto:enquiry@swiftgroup.co.uk)

[www.sterlingcaravans.co.uk](http://www.sterlingcaravans.co.uk)

A MEMBER OF THE SWIFT GROUP







# Sterling Europa

With its cool new Scandinavian influenced interior the new Europa range is designed for those that enjoy contemporary living. Spacious interiors, with popular layouts, offer class-leading headroom with modern new fabrics and re-styled furniture in 'Oregon pine' with ebony accents.

Inside, stylish front lockers have recessed mains lights and rooflights provide good natural light and ventilation. Comfortable seating and easy storage is based on beech slat seat bases with sprung hinged tops. Washrooms have the latest Thetford toilet and lined showers. Three mains sockets and two TV points cater for modern entertainment needs.







Streamlined exteriors have one-piece, thick gauge aluminium sidewalls with completely new graphics, a one piece rear panel, alloy wheels and shock absorbers for a smoother ride.

Restyled kitchens have new appliances with a built in microwave oven, stainless steel effect electronic ignition fridge, Thetford oven and dual fuel hob and a unique new granite-look sink. For better storage on the move kitchen lockers now have positive catches. New to the range is the 545, which shares the same layout as the bestselling 550 but has a wrap around rear dinette in place of the fixed bed.





## Specification

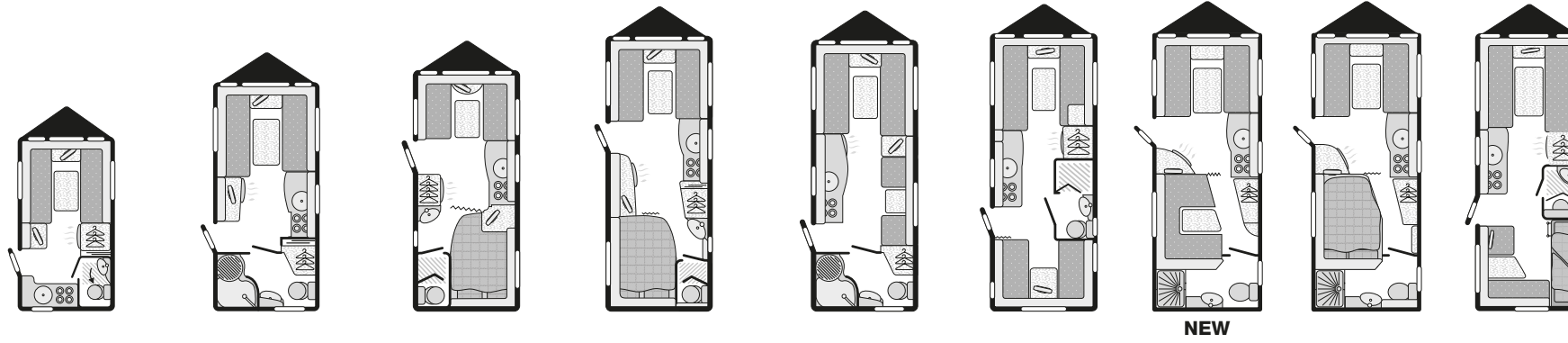

	390	460	470	495	520	530	545	550	565
Berths	2	2	4	4	4	5	4	4	6
Number of Axles	1	1	1	1	1	1	1	1	1
Internal Length (at bed box height)	3.83m/12'7"	4.59m/15'1"	4.74m/15'7"	5.50m/18'1"	5.44m/17'10"	5.60m/18'4"	5.60m/18'4"	5.60m/18'4"	5.50m/18'1"
Overall Width	2.23m/7'4"	2.23m/7'4"	2.23m/7'4"	2.29m/7'6"	2.23m/7'4"	2.23m/7'4"	2.29m/7'6"	2.29m/7'6"	2.23m/7'4"
Maximum Internal Headroom	1.95m/6'5"	1.95m/6'5"	1.95m/6'5"	1.95m/6'5"	1.95m/6'5"	1.95m/6'5"	1.95m/6'5"	1.95m/6'5"	1.95m/6'5"
Overall Height (inc. TV Aerial)	2.70m/8'10"	2.70m/8'10"	2.70m/8'10"	2.70m/8'10"	2.70m/8'10"	2.70m/8'10"	2.70m/8'10"	2.70m/8'10"	2.70m/8'10"
Overall Length	5.52m/18'1"	6.28m/20'7"	6.43m/21'1"	7.19m/23'7"	7.12m/23'4"	7.29m/23'11"	7.29m/23'11"	7.29m/23'11"	7.19m/23'7"
Mass in Running Order (inc. tolerance)	1026kg/20.2cwt	1118kg/22.0cwt	1127kg/22.2cwt	1269kg/25.0cwt	1250kg/24.6cwt	1263kg/24.9cwt	1280kg/25.2cwt	1283kg/25.3cwt	1258kg/24.8cwt
Essential Habitation Equipment Payload	68kg/1.3cwt	68kg/1.3cwt	68kg/1.3cwt	68kg/1.3cwt	68kg/1.3cwt	68kg/1.3cwt	68kg/1.3cwt	68kg/1.3cwt	68kg/1.3cwt
Personal Effects Payload	96kg/1.9cwt	104kg/2.0cwt	125kg/2.5cwt	133kg/2.6cwt	132kg/2.6cwt	144kg/2.8cwt	134kg/2.6cwt	134kg/2.6cwt	153kg/3.0cwt
Optional Equipment Payload	10kg/0.2cwt	10kg/0.2cwt	10kg/0.2cwt	10kg/0.2cwt	10kg/0.2cwt	10kg/0.2cwt	10kg/0.2cwt	10kg/0.2cwt	10kg/0.2cwt
Maximum Technical Permissible Laden Mass	1200kg/23.6cwt	1300kg/25.6cwt	1330kg/26.2cwt	1480kg/29.1cwt	1460kg/28.7cwt	1485kg/29.2cwt	1492kg/29.4cwt	1495kg/29.4cwt	1489kg/29.3cwt
Awning A/A Dimension	8.20m/26'11"	8.91m/29'3"	9.08m/29'9"	9.82m/32'3"	9.75m/32'0"	9.87m/32'5"	9.87m/32'5"	9.87m/32'5"	9.82m/32'3"
Tyre Size	175 R14 99	175 R14 99	175 R14 99	185 R14 102	185 R14 102	185 R14 102	185 R14 102	185 R14 102	185 R14 102

## Bed sizes

Front Double	2.08m x 1.90m/6'10" x 6'3"	2.08m x 1.80m/6'10" x 5'11"	2.08m x 1.34m/6'10" x 4'5"	2.13m x 1.59m/7'0" x 5'3"	2.08m x 1.80m/6'10" x 5'11"	2.08m x 1.80m/6'10" x 5'11"	2.13m x 1.59m/7'0" x 5'3"	2.13m x 1.59m/7'0" x 5'3"	2.08m x 1.80m/6'10" x 5'11"
Or Front Single (nearside)	1.90m x 0.72m/6'3" x 2'4"	1.90m x 0.72m/6'3" x 2'4"		1.67m x 0.72m/5'6" x 2'4"	1.80m x 0.72m/5'11" x 2'4"	1.90m x 0.72m/6'3" x 2'4"		1.67m x 0.72m/5'6" x 2'4"	1.80m x 0.72m/5'11" x 2'4"
And Front Single (offside)	1.90m x 0.72m/6'3" x 2'4"	1.80m x 0.72m/5'11" x 2'4"		1.59m x 0.72m/5'3" x 2'4"	1.90m x 0.72m/6'3" x 2'4"	1.80m x 0.72m/5'11" x 2'4"		1.59m x 0.72m/5'3" x 2'4"	1.90m x 0.72m/6'3" x 2'4"
Rear Double			1.88m x 1.37m/6'2" x 4'6"	1.92m x 1.38m/6'4" x 4'6"		2.08m x 1.29m/6'10" x 4'3"	1.89m x 1.37m/6'2" x 4'6"	1.89m x 1.37m/6'2" x 4'6"	
Side Single					1.80m x 0.70m/5'11" x 2'4"				1.70m x 0.75m/5'7" x 2'6"
Side Bunk					1.78m x 0.59m/5'10" x 1'11"				
Side Fixed Bunks (3)									1.83m x 0.58m/6'0" x 1'11"
Rear Bunk						1.90m x 0.59m/6'3" x 1'10"			

**Bed sizes:** Please note that double bed sizes are quoted with wrap round seating

**Awning sizes:** Due to the varying awning designs and sizes the awning sizes given are approximate only. Specific awning sizes must be confirmed by your dealer or the awning manufacturer prior to purchase.

## Features

### Key features

- Class leading headroom of 1.95m (6'5")
- Overall body width 2.23m/7'4" or 2.29m/7'6" (see specifications)
- One-piece, thick gauge, high gloss aluminium sidewalls
- High security entrance lock for peace of mind
- Shock absorbers giving more stable, smooth towing
- Door flyscreen with easy concertina action
- Class leading front locker design with recessed mains lights
- Positive catches on kitchen locker doors
- Beech slat seat and bed bases with sprung hinged tops for extra comfort and easy access
- Upper lockers and seat bases with spaceframe construction
- Three mains sockets
- 2nd TV point near front or rear chest (except 545 and 550)
- Radio/CD/MP3 player with iPod connection
- **New** Granite-lock GRP kitchen sink
- Built-in, ventilated microwave oven with digital controls

- Dual fuel hob with 800W electric hotplate
- Electronic ignition, digital control 107 litre fridge with metallic door finish
- Showers with gloss plastic lined walls
- Thetford C250 toilet with electric flush and 18 litre wheeled waste tank
- High capacity in-board pump with chrome finish brass taps for reliable, high performance water supply
- Separate shower mixers with adjustable head positions

### Key options

- AL-KO ATC trailer control system
- HAL Locate GPS tracking system
- AL-KO Secure wheel lock

### Additional features

#### Exterior

- Stylish one-piece rear panels
- Exclusive alloy wheels
- 13-pin 'Jaeger' 12V car connector
- AL-KO galvanised steel chassis with Euro-Axle
- AL-KO Euro overrun device with two-way assisted handbrake
- Receiver for optional AL-KO Secure wheel lock
- AKS 3004 Stabiliser
- Steel spare wheel and carrier
- Status 530 directional TV aerial
- Gas regulator for Propane and Butane mounted on front bulkhead
- Moulded front panel with three opening windows and door with gas strut
- Fully double-glazed opening windows (no single-glazed cold areas) with silver finished edges
- Exterior two-part door with interior moulded liner, window, blind and waste bin
- Exterior access battery box with mains electric inlet (battery not included)
- Entrance step
- Flush fitting awning light

- 25mm 'sandwich' sidewalls with HD polystyrene insulation core
- 32mm semi-'sandwich' roof with HD polystyrene insulation core
- 44mm 'sandwich' floor with Styrofoam insulation core

#### Interior

- Heki large tilting panoramic roof window with flynet and blind
- Cassette flyscreens and blinds on all windows
- **New** Multi-directional clear rooflights in kitchens and bedrooms
- Twin curtain track for improved hanging and ease of use
- Sprung interior mattresses, main seat and backrest cushions
- Fixed beds with aluminium frames to maximise strength and storage space
- Seat and backrest ventilation boards
- Long front beds 1.90m (6'3") (model specific, see specifications)
- Two scatter cushions
- Two bolster cushions
- Removable carpets over woodblock effect vinyl flooring
- Removable entrance mat
- Thick washroom doors with domestic style locks and handles

- Deep worktops with matching edges
- Removable drainer with dedicated storage
- Food grade nylon chopping board with dedicated storage
- Moulded cutlery drawer on smooth-action steel runners

#### Equipment

- **New** Thetford thermostatic oven and separate grill
- Glass hob lid with safety cut-out feature
- Dual fuel gas and 800W mains electric storage water heater
- Dual fuel (3kW gas and 2kW mains) central heating with electronic ignition
- Blown air ducted to living, sleeping and washroom areas
- Areas under seats and beds warmed by blown air system
- Grade 2 classification for heating and thermal insulation
- Isolation taps for gas appliances
- Fully protected mains electric system
- Two TV stations with 230V, 12V and coax aerial sockets (except 545 and 550)
- 230V socket in kitchen area

- 20 Amp switchmode charger/transformer
- 12V control panel with battery state meter, car/caravan battery switch and water pump switch
- Solar panel connection provision
- 230V mains lights over front seating and washroom areas
- Halogen adjustable downlights in lounge/sleeping areas
- Fluorescent light in kitchen
- 25 metre mains hook-up cable

#### Safety and Security

- Higher tyre ratings - 10% load margin at 130kph (law permitting)
- Smoke alarm
- CRIS identity number etched to windows and caravan chassis
- Concealed security data chip within caravan construction
- All models comply with British and European safety standards

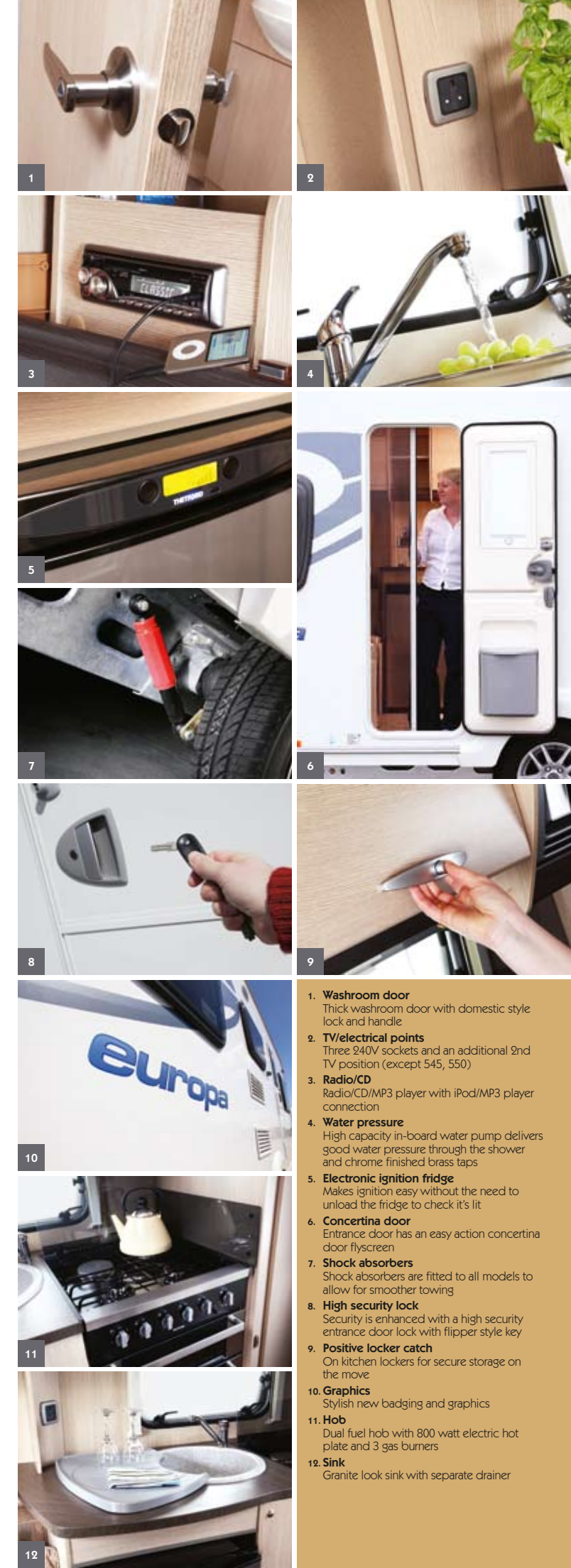

- 1. Washroom door**  
Thick washroom door with domestic style lock and handle
- 2. TV/electrical points**  
Three 240V sockets and an additional 2nd TV position (except 545, 550)
- 3. Radio/CD**  
Radio/CD/MP3 player with iPod/MP3 player connection
- 4. Water pressure**  
High capacity in-board water pump delivers good water pressure through the shower and chrome finished brass taps
- 5. Electronic ignition fridge**  
Makes ignition easy without the need to unload the fridge to check it's lit
- 6. Concertina door**  
Entrance door has an easy action concertina door flyscreen
- 7. Shock absorbers**  
Shock absorbers are fitted to all models to allow for smoother towing
- 8. High security lock**  
Security is enhanced with a high security entrance door lock with flipper style key
- 9. Positive locker catch**  
On kitchen lockers for secure storage on the move
- 10. Graphics**  
Stylish new badging and graphics
- 11. Hob**  
Dual fuel hob with 800 watt electric hot plate and 3 gas burners
- 12. Sink**  
Granite look sink with separate drainer