



LUNAR
We put you first
1 9 9 7



SOLAR
...the new star from Lunar



SOLAR

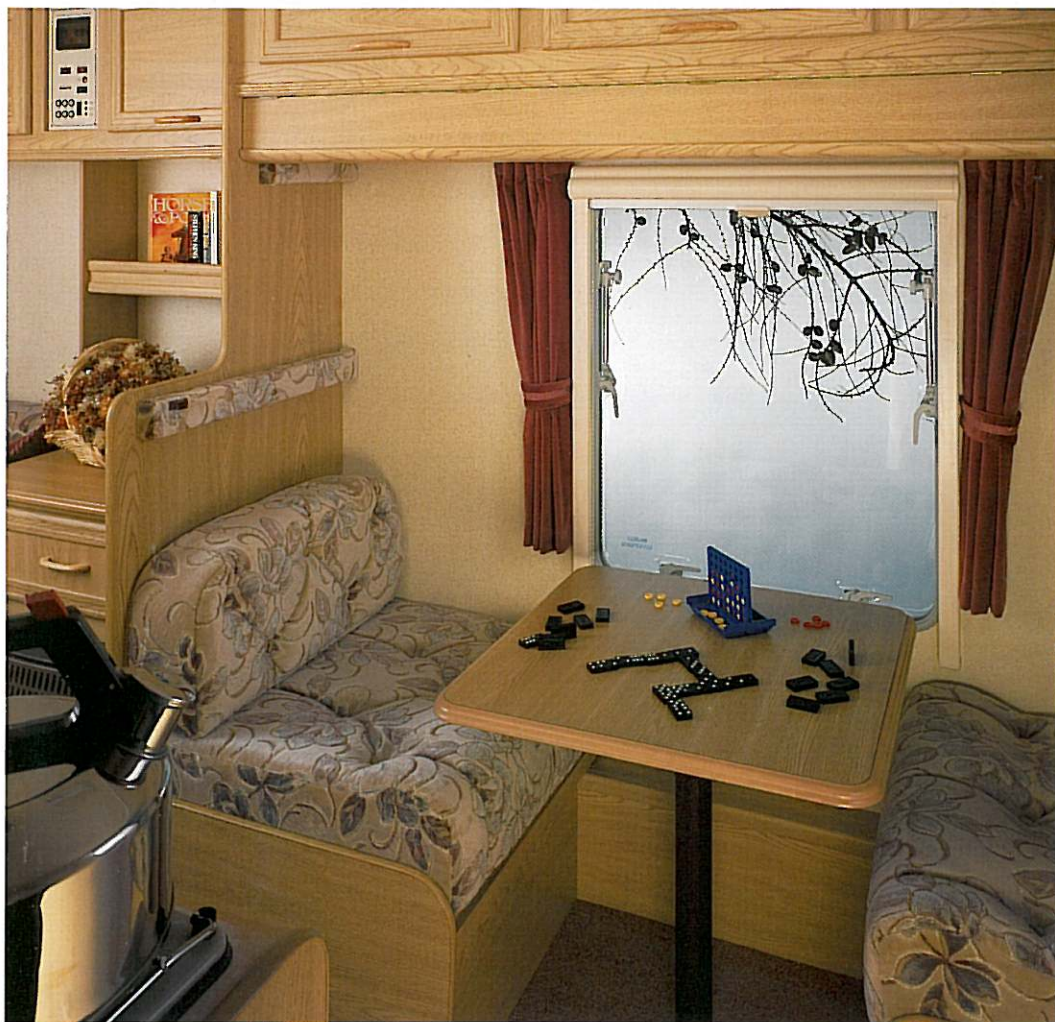

The use of CAD/CAM design equipment combined with a natural flair has resulted in Solar, the exciting new range of caravans from Lunar. The Solar range represents superb value with an impressive array of equipment complemented by an attractive exterior livery finished in rich Royal Maroon and Buckskin.

An unbeatable level of standard specification includes flyscreens and blinds to all opening windows, two mains sockets, Carver 3600 flued room heater, oven and four burner gas hob, a large gas and electric Electrolux fridge and a fitted shower compartment.

Make Solar your choice for all the comforts of home on the open road...



All photographs featured in this brochure have been taken in the Solar 524.

Five Superb Models



Solar 462



Solar 464



Solar 465

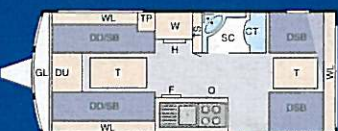

Solar 505



Solar 524

Key

- BB - Battery Box
- C - Cupboard
- CL - Crockery Locker
- CT - Cassette Toilet
- DDB- Dinette/Double Bed with Bunk Over
- DSB- Dinette/Single Bed with Bunk Over
- DU - Drawer Unit
- ECU - Electrical Control Unit
- F - Fridge
- GL - Gas Bottle Locker
- H - Heater
- O - Oven
- SB - Single Bed
- SC - Shower Compartment
- T - Table
- TP - Television Point
- TS - Table Storage
- W - Wardrobe
- WH - Water Heater
- WL - Wall Lockers

Specifications

Model	Solar 462	Solar 464	Solar 465	Solar 505	Solar 524
Internal Body Length	4.62m / 15'2"	4.62m / 15'2"	4.62m / 15'2"	4.98m / 16'4"	5.28m / 17'3"
Overall Length	6.10m / 20'	6.10m / 20'	6.10m / 20'	6.40m / 21'	6.74m / 22'1"
Internal Body Width	2.03m / 6'8"	2.03m / 6'8"	2.03m / 6'8"	2.03m / 6'8"	2.03m / 6'8"
Overall Width	2.16m / 7'1"	2.16m / 7'1"	2.16m / 7'1"	2.16m / 7'1"	2.16m / 7'1"
Maximum Internal Height	1.90m / 6'3"	1.90m / 6'3"	1.90m / 6'3"	1.90m / 6'3"	1.90m / 6'3"
Overall Height	2.64m / 8'8"	2.64m / 8'8"	2.64m / 8'8"	2.64m / 8'8"	2.64m / 8'8"
Tyre Size	165 R 13 LS25C 6PLY	165 R 13 LS25C 6PLY	165 R 13 LS25C 6PLY	165 R 13 LS25C 6PLY	165 R 13 LS25C 6PLY
Coupling Height	41cm / 16"	41cm / 16"	41cm / 16"	41cm / 16"	41cm / 16"
Weight Ex-works $\pm 3\%$	860kg / 16.9cwt	860kg / 16.9cwt	860kg / 16.9cwt	920kg / 18.2cwt	945kg / 18.7cwt
Caravan Allowable Payload	214kg / 4.2cwt	214kg / 4.2cwt	214kg / 4.2cwt	252kg / 5cwt	227kg / 4.5cwt
Maximum Laden Weight	1100kg / 21.7cwt	1100kg / 21.7cwt	1100kg / 21.7cwt	1200kg / 23.7cwt	1200kg / 23.7cwt
Bed Sizes	Double 2.01m x 1.48m 6'7" x 4'10"	2.01m x 1.43m 6'7" x 4'8"	2.01m x 1.48m 6'7" x 4'10"	2.01m x 1.43m 6'7" x 4'8"	2.01m x 1.43m 6'7" x 4'10"
	or Two 1.88m x 0.69m 6'2" x 2'3"	or Two 1.83m x 0.69m 6' x 2'3"		or Two 1.83m x 0.69m 6' x 2'3"	or Two 1.83m x 0.69m 6' x 2'3"
Single		2.01m x 0.77m 6'7" x 2'6"			1.83m x 0.69m 6' x 2'3"
Double			2.01m x 1.22m 6'7" x 4'	2.01m x 1.13m 6'7" x 3'8"	
Bunk		1.98m x 0.56m 6'6" x 1'10"	1.98m x 0.56m 6'6" x 1'10"	1.98m x 0.56m 6'6" x 1'10"	1.78m x 0.56m 5'10" x 1'10"
Awning - ground to ground	900cm	900cm	900cm	935cm	955cm

Features

- 3 front opening windows
- Carver 3600 flued room heater, with electric fan master heater and ducted blown air
- Blinds and flyscreens to all windows
- 2 mains sockets
- Large fridge
- Gas/electric water heater
- Fitted shower compartment
- 2 bolster cushions
- Fitted cassette toilet
- Status TV aerial
- Oven
- 2x mains reading lights
- 2 scatter cushions
- 2 drawer chest with oull-out coffee table (not 465)
- 2x 12v reading lights
- Domestic style interior sprung base mattresses to front seats
- 4 burner hob with flame failure
- Slatted bed box tops
- Mains electric hook-up with 20 metre cable supplied
- Awning light

The name Lunar is now into its third decade, in all that time our philosophy has remained unchanged. The now famous Lunar crest carrying the Latin for "Our product - Our pride," sums up a philosophy that has produced award winning caravans and innovative features that are the envy of our competitors. An ongoing programme of re-investment in our factory premises and the very latest technology ensures that our reputation for quality products continues.



Lunar Caravans Limited,
Sherdley Road, Lostock Hall,
Preston, Lancashire PR5 5JF

Tel: 01772 337628
Fax: 01772 627722

HIGHBRIDGE CARAVAN CENTRE LTD.
7 BRISTOL ROAD
HIGHBRIDGE, SOMERSET
Tel: 01278 782725
VAT Reg. No. 130 2333 31

1997
they're
here...



The stunning new
LX2000
series...

LUNAR
We put you first



The leaders in
lightweight caravan
technology bring
you the **Lunar**
LX2000 series
at a price that's
truly out of this
world!



the next generation of superb



The superb high specification **LX2000** range features **striking graphics**, **special upholstery**, **natural wood doors** and a host of new features.

Every model has a **Carver 3600** gas and electric room heater with **ducted blown air**, a colour co-ordinated **hob** and **oven** in the kitchen area which also features a **77 litre fridge** with full width freezer, two mains sockets, two reading lights and **blinds** and **flyscreens** to all opening windows and **sprung interior seating** to all base mattresses.

caravans from Lunar

Join the space age in a **Lunar LX2000**... *you'll know* you've arrived!



LX2000

Six Spacious Models



LX2000 402



LX2000 462

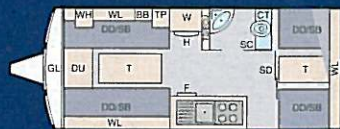

LX2000 505



LX2000 505 L

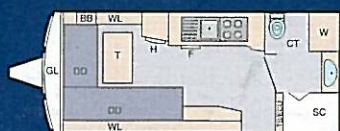

LX2000 502

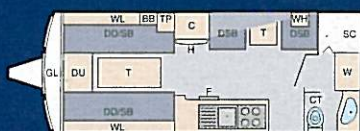

LX2000 524

LX2000 Key

BB Battery Box	DU Drawer Unit	SC Shower Compartment
C Cupboard	ECU Electrical Control Unit	T Table
CL Crockery Locker	F Fridge	TP Television Point
CT Cassette Toilet	GL Gas Bottle Locker	TS Table Storage
DDB Dinette/Double Bed with Bunk Over	H Heater	W Wardrobe
DSB Dinette/Single Bed with Bunk Over	O Oven	WH Water Heater
	SB Single Bed	WL Wall Lockers

The name Lunar is now into its third decade, in all that time our philosophy has remained unchanged. The now famous Lunar crest carrying the Latin for "Our product - Our pride," sums up a philosophy that has produced award winning caravans and innovative features that are the envy of our competitors. An ongoing programme of re-investment in our factory premises and the very latest technology ensures that our reputation for quality products continues.

LX2000 Specifications

Model	LX2000 402	LX2000 462	LX2000 505	LX2000 505 L	LX2000 502	LX2000 524
Internal Body Length	4.02m / 13'2"	4.63m / 15'2"	4.98m / 16'4"	4.98m / 16'4"	4.98m / 16'4"	5.28m / 17'3"
Overall Length	5.76m / 18'10"	6.37m / 20'10"	6.74m / 22'	6.74m / 22'	6.74m / 22'	7.03m / 23'
Internal Body Width	2.03m / 6'8"	2.03m / 6'8"	2.03m / 6'8"	2.03m / 6'8"	2.03m / 6'8"	2.03m / 6'8"
Overall Width	2.16m / 7'1"	2.16m / 7'1"	2.16m / 7'1"	2.16m / 7'1"	2.16m / 7'1"	2.16m / 7'1"
Maximum Internal Height	1.90m / 6'3"	1.90m / 6'3"	1.90m / 6'3"	1.90m / 6'3"	1.90m / 6'3"	1.90m / 6'3"
Overall Height	2.64m / 8'8"	2.64m / 8'8"	2.64m / 8'8"	2.64m / 8'8"	2.64m / 8'8"	2.64m / 8'8"
Tyre Size	165 R 13 LS25C 6PLY	165 R 13 LS25C 6PLY	165 R 13 LS25C 6PLY	165 R 13 LS25C 6PLY	165 R 13 LS25C 6PLY	165 R 13 LS25C 6PLY
Coupling Height	44cm / 17"	44cm / 17"	44cm / 17"	44cm / 17"	44cm / 17"	44cm / 17"
Weight Ex-works ±3%	845kg / 18.7cwt (est.)	880kg / 17.3cwt	965kg / 19cwt	965kg / 19cwt	920kg / 18.1cwt (est.)	970kg / 19.1cwt
Caravan Allowable Payload	330kg / 6.5cwt	294kg / 5.8cwt	206kg / 4cwt	206kg / 4cwt	253kg / 5cwt	201kg / 3.9cwt
Maximum Laden Weight	1200kg / 23.7cwt	1200kg / 23.7cwt	1200kg / 23.7cwt	1200kg / 23.7cwt	1200kg / 23.7cwt	1200kg / 23.7cwt
Bed Sizes	Double 2.01m x 1.48m 6'7" x 4'10"	2.01m x 1.48m 6'7" x 4'10"	2.01m x 1.43m 6'7" x 4'8"	2.01m x 1.43m 6'7" x 4'8"	2.01m x 1.32m 6'7" x 4'4"	2.01m x 1.43m 6'7" x 4'8"
	or	or	or	or		or
Single	Two 1.88m x 0.69m 6'2" x 2'3"	Two 1.88m x 0.69m 6'2" x 2'3"	Two 1.83m x 0.69m 6' x 2'3"	Two 1.83m x 0.69m 6' x 2'3"		Two 1.83m x 0.69m 6' x 2'3"
Single						1.83m x 0.69m 6' x 2'3"
Double			2.01m x 1.13m 6'7" x 3'8"	1.8m x 1.13m 5'11" x 3'8"		
Bunk			1.98m x 0.56m 6'6" x 1'10"	1.98m x 0.56m 6'6" x 1'10"		1.78m x 0.56m 5'10" x 1'10"
Awning - ground to ground	835cm	900cm	935cm	935cm	935cm	965cm

Superb LX2000 Features

- 3 front opening windows.
- Colour keyed Carver 3600 flued room heater, with electric fan master heater and ducted blown air.
- Blinds and flyscreens to all opening windows.
- Flyscreen to exterior door.
- 2 flush mounted mains sockets.
- Large 77 litre fridge with full width freezer.
- Gas/electric water heater.
- Fitted shower compartment.
- Fitted cassette toilet.
- Gas access flap on window sill.
- Stylish Wheel Trims.
- Mudflaps.
- Dedicated washroom Sink Taps.
- Colour keyed Oven.
- Colour keyed 4 burner hob with flame failure device.
- Mains electric hook-up with 20 metre cable supplied.
- 2x mains reading lights.
- 4 scatter cushions.
- 2 drawer chest with pull-out coffee table.
- 2x 12v reading lights.
- Domestic style interior sprung base mattresses to front and rear seats.
- Slatted bed box tops.
- Awning light.
- Down Lighting / Spot Lighting in the Washroom.
- Cocktail Cabinet.
- New rear panel with new style light clusters.
- Gas bottle tray with storage recess for the brace and winder.
- 'Lunar' doormat.
- Doorway footwell with 'sweepity'.



Lunar Caravans Limited,
Sherdley Road, Lostock Hall,
Preston, Lancashire PR5 5JF

Tel: 01772 337628

Fax: 01772 627722