

# Swift 1993



QUALITY WITH STYLE



# DESIGNED TO LAST

From the time the very first Swift model was produced 28 years ago, innovative design and quality of construction have been the hallmark of the company.

Today, the Swift Group is one of the leading companies producing leisure vehicles in Europe.

All Swifts are built to stand the test of time and an excellent resale value is testimony to their ongoing popularity over the years.

The 26 acre production complex at Cottingham in North Humberside bristles with all the latest high technology design and

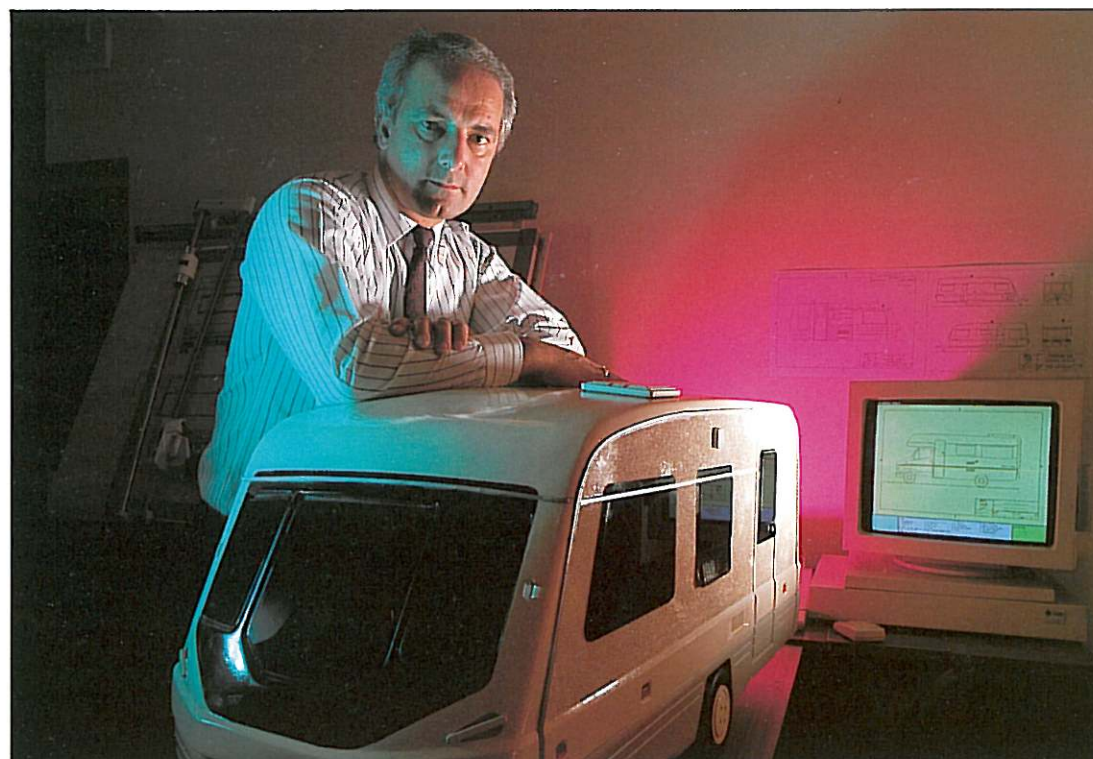

production equipment. The Swift manufacturing process applies the rigorous quality procedures set down in BS5750 Part 1.

This has transformed the way the modern caravan is conceived and manufactured.

Starting at the design stage, a powerful CAD (computer aided design) system produces everything

from initial concepts to final drawings for the production lines. It provides the designers with hundreds of options, many in three dimensions, enabling them to picture the Swift tourers of tomorrow without a panel being built.

Before they go into production, each prototype is put through a series of rigorous 80mph speed tests,

to prove their safety and stability beyond doubt. A stability that has earned Swift countless speed, endurance and rally records over the years.

Some of these tests are unique to Swift, as are many of the new manufacturing processes. Together they help the company to build a better caravan.

# QUALITY BUILT-IN



Years of experience and craftsmanship are built into every new Swift product; experience that has gained the company the reputation for making the best quality touring caravans in Europe.

The best products deserve the best dealers, and Swift's nationwide network are all chosen to ensure the standard of quality built into

each caravan is matched by the standard of service provided by every Swift dealer.

A service that is supported by a factory operated after sales scheme, designed to provide the Swift customer with an after sales service second to none.

Purpose built after sales delivery vehicles provide

dealers with a round the year supply of spare parts.

And with dealer staff attending regular product knowledge and after sales service courses at the company's training centre, every Swift customer can rest assured that they receive the most professional help available.

The 1993 range is the

most comprehensive ever produced by Swift.

31 models from 5 ranges, including new exterior shapes, warmer interiors and several new models, provide every conceivable combination of layout and specification to meet your personal needs, precisely.

From the entry level Rapides to the top of the range twin axle Conquerors, they all have one thing in common. The Swift reputation for unrivalled style and quality.

We leave you to choose your own style and your own level of comfort.





Inside every Swift is a story of craftsmanship, attention to detail and years of experience, supporting the company's reputation for building a better touring caravan.

Many of the more important points are hidden from the eye. Floors that are 44mm thick, walls 24mm thick and a roof 31mm thick,

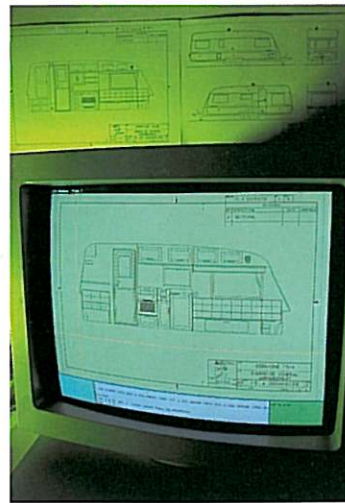

bonded into the laminated walls, providing extremely secure furniture fixings.

Most models are fitted with special ventilation boards behind the seat rests. This feature, together with slatted bed box top construction, eliminates

condensation in these high-risk areas. A lightweight chassis with the latest wide track axle ensures optimum safety and performance.

The Swift production and development procedures have been formulated to meet the exacting standards set down in BS5750 Part 1, and all sections of the business operate using the same centrally generated computerised information.

All Swift products meet national safety standards and all our electrical power packs and wiring conform to international standards ISO 8818, making them suitable for use throughout Europe.

## THE INSIDE STORY

provide superior strength and insulation.

Most Swifts feature solid ash framed furniture doors with stylish profiles, for good looks and a long life, all precision-made on the latest computer-controlled machines.

And all furniture is fitted using the unique Swift system of screwing into steel plates

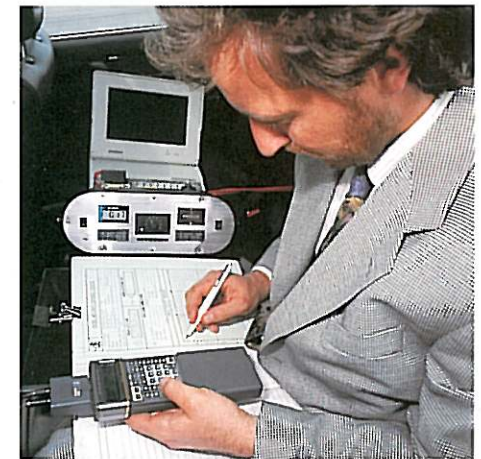



## SAFETY AND STABILITY

Three of the most important things to consider when buying a caravan are safety, stability and security.

When it comes to safety and stability, Swift have a record second to none. Every prototype caravan has to undergo rigorous stability tests carried out at speeds of up to 80mph before they go

into production.

One of the tests includes measuring the nose weight of each prototype while it is actually being towed, using a piece of test equipment that is unique to Swift. Swift is the only manufacturer able to check the aerodynamics and towing stability of their caravans by recording the

nose weight in every possible towing situation.

And when it comes to speed, a standard unstabilised Swift Rapide 380/2 holds the national 24-hour speed record, at an average speed of 97mph over 24 hours, behind a standard Vauxhall Carlton. True testament to the safety and stability of the Swift brand.

The wheels on all Swift models are fitted with the double hump safety feature to reduce the risk of the tyre leaving the wheel rim in the unlikely event of a motorway blowout.



All Swift models have security numbers etched into every window and every number is recorded on a central computer system. The same number is stamped into the 'A' frame of the chassis.







380/440 and 490



400 and 440

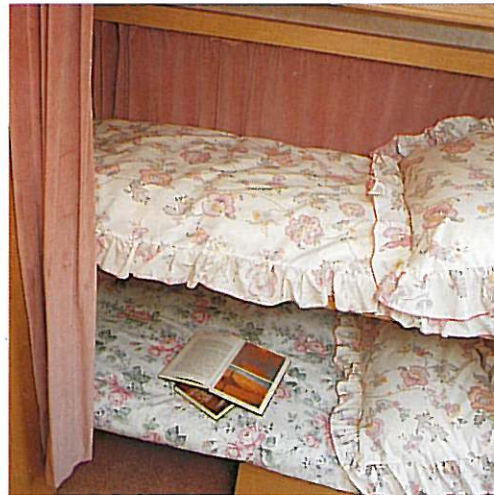

400 and 440



380



All models (optional shower)



440/450 and 490



The new six-model Rapide range sets unrivalled standards in style and value for money. It brings the renowned Swift quality of construction and standard of finish within the range of anyone looking for a new caravan.

For 1993, the Rapides are extra special. A new exterior shape gives the Rapide the style and appeal of Swift models much further up the market.

Inside, the Rapides have new, better quality furniture with stylish framed doors, and a warmer feel with improved soft furnishings.

And the final choice on the internal specification is all your own. Choose from the impressive normal specification or the luxury 'GXL' factory fitted added value pack.

#### MAIN FEATURES

- Front gas bottle and optional spare wheel storage

## THE RAPIDE RANGE



- 20 metre mains electric cable
- Opening front window
- Fully double glazed windows
- Lightweight galvanised steel chassis with wide track axle
- Washroom with vanity unit, deep wash hand basin and shower tray
- Mains electrics with 1 socket
- 12 volt socket
- 60 litre 3 way Electrolux fridge
- 3 burner stainless steel hob and grill unit
- Stainless steel sink unit
- Carver 1.8kw underfloor flued heater
- Free standing table
- Velvet curtains
- Bolt-on wheel trims
- Self-priming submersible water pump
- Roller blind to kitchen window
- Awning light

RAPIDE	Internal Length (At bed box height)	Overall Width	Overall Height	Overall Length	Ex Works Weight +/- 5%	Maximum Authorised Weight	Caravan Allowable Pay Load
380	3.84m/12'7"	2.13m/7'0"	2.51m/8'3"	5.24m/17'2"	675kg/13.3cwt*	850kg/16.7cwt	175kg/3.4cwt*
400	4.00m/13'2"	2.13m/7'0"	2.51m/8'3"	5.40m/17'9"	705kg/13.9cwt*	950kg/18.7cwt	245kg/4.8cwt*
430	4.43m/14'6"	2.13m/7'0"	2.51m/8'3"	5.83m/19'2"	755kg/14.8cwt*	950kg/18.7cwt	195kg/3.9cwt*
440	4.51m/14'9"	2.13m/7'0"	2.51m/8'3"	5.90m/19'5"	770kg/15.2cwt	1000kg/19.7cwt	230kg/4.5cwt
450	4.51m/14'9"	2.13m/7'0"	2.51m/8'3"	5.90m/19'5"	780kg/15.3cwt*	1000kg/19.7cwt	220kg/4.4cwt*
490	4.90m/16'1"	2.13m/7'0"	2.51m/8'3"	6.30m/20'8"	850kg/16.7cwt*	1060kg/20.8cwt	210kg/4.1cwt*

\*Estimated

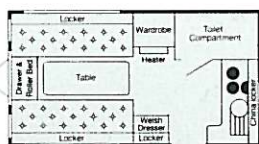

RAPIDE 380

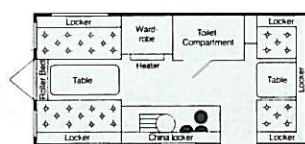

RAPIDE 400

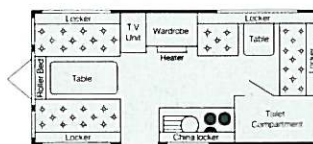

RAPIDE 430

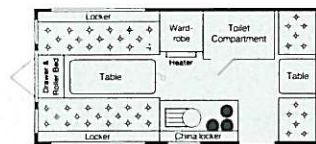

RAPIDE 440

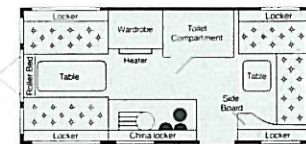

RAPIDE 450

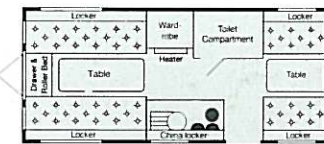

RAPIDE 490

Optional 'GXL' pack with:

Three opening front windows, Cascade water heater, shower, exterior-access battery box and charger, window in door with blind and cassette toilet.



The Swift Diamond range has increased in both size and standard of specification for 1993.

Four new models, the Minuette, Coronette, Doublette and Pirouette mean there are now eight different models and layouts to meet every taste.

Outside, the Swift Diamond has a completely new exterior shape with a flat one-piece roof and stylish new glass fibre front panel incorporating new window profiles with rounded outer corners.

Inside the specification has been upgraded to include a cassette toilet, three opening front windows, blinds and flyscreens to at least three windows, exterior battery box, and an exterior aerial socket, in addition to the already generous specification.

# THE SWIFT DIAMOND RANGE



## MAIN FEATURES

- Mains electrics with 2 sockets
- 20 metre mains electric cable
- 12v socket
- TV aerial socket
- 12v reading lights
- Awning light
- Exterior access battery box (excl. battery)
- 10 amp switch mode charger transformer
- 60 litre 3 way Electrolux fridge
- 3 burner enamelled hob
- Enamelled bowl drainer
- Carver Trumatic 1.8kw underfloor flued heater
- Thetford cassette toilet
- Carver Cascade gas/electric water heater
- Fitted shower
- Blinds and flyscreens to at least 3 windows
- Roof light with night blind and flyscreen (flyscreen only in toilet)
- Exterior door window with blind
- Solid ash framed furniture doors
- New style crockery racks
- Lined velvet curtains

SWIFT DIAMOND	Internal Length (At bed box height)	Overall Width	Overall Height	Overall Length	Ex Works Weight +/- 5%	Maximum Authorised Weight	Caravan Allowable Pay Load
MINUETTE	3.58m/11'10"	2.13m/7'0"	2.51m/8'3"	5.06m/16'7"	680kg/13.4cwt*	900kg/17.7cwt	220kg/4.3cwt*
SILHOUETTE	4.05m/13'3"	2.13m/7'0"	2.51m/8'3"	5.52m/18'2"	745kg/14.7cwt	900kg/17.7cwt	155kg/3.0cwt
CORVETTE	4.57m/15'0"	2.13m/7'0"	2.51m/8'3"	6.04m/19'10"	840kg/16.5cwt	1060kg/20.8cwt	220kg/4.3cwt
DANETTE	4.59m/15'1"	2.13m/7'0"	2.51m/8'3"	6.06m/19'11"	840kg/16.5cwt	1060kg/20.8cwt	220kg/4.3cwt
CORONETTE	4.65m/15'3"	2.13m/7'0"	2.51m/8'3"	6.12m/20'1"	850kg/16.7cwt*	1060kg/20.8cwt	210kg/4.1cwt*
DOUBLETTE	4.65m/15'3"	2.13m/7'0"	2.51m/8'3"	6.12m/20'1"	850kg/16.7cwt*	1060kg/20.8cwt	210kg/4.1cwt*
PIROUETTE	4.76m/15'4"	2.13m/7'0"	2.51m/8'3"	6.23m/20'5"	855kg/16.8cwt*	1060kg/20.8cwt	205kg/4.0cwt*
ALOUETTE	5.15m/16'11"	2.13m/7'0"	2.51m/8'3"	6.62m/21'9"	945kg/18.6cwt	1150kg/22.6cwt	205kg/4.0cwt

\*Estimated

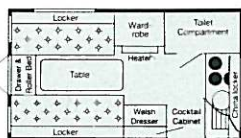

MINUETTE

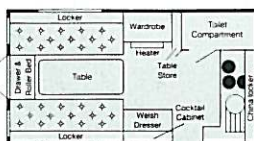

SILHOUETTE

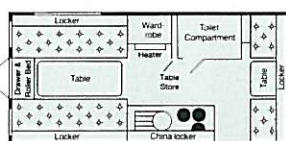

CORVETTE

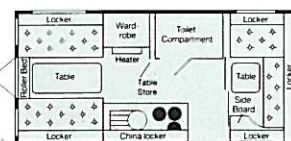

DANETTE

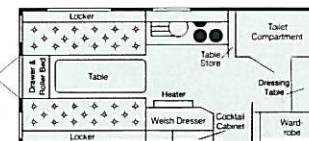

CORONETTE

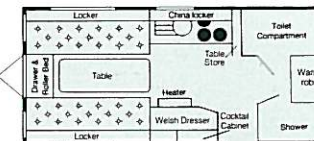

DOUBLETTE

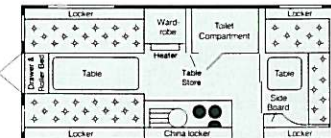

ALOUETTE

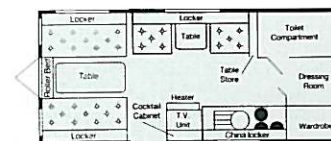

PIROUETTE





All models



Silhouette (optional oven)



Alouette and Corvette



Corvette, Danette and Alouette (optional oven)



Alouette (optional fabric)





360



470/480



510



470



All models



490L



The Challenger 'SE' remains Britain's most popular range of touring caravans, providing a unique blend of modern styling, a wide choice of layouts and a high level of internal comfort.

For 1993, the Swift Challengers have a stylish new exterior, with an eye-catching new graduated burgundy striping with blending burgundy and white mouldings, and glaze panelling.

The choice of layouts increases to nine, with the introduction of a 360 two-berth model, while the 480 has a new layout, still offering a separate toilet and shower.

The interior has been given a new warmer treatment and substantially upgraded specification. A glance at the features shows why Challengers are still leading the pack.

#### MAIN FEATURES

- Mains electrics with 3 sockets
- 20 metre mains electric cable

## THE CHALLENGER 'SE' RANGE



CHALLENGER	Internal Length (At bed box height)	Overall Width	Overall Height	Overall Length	Ex Works Weight +/- 5%	Maximum Authorised Weight	Caravan Allowable Pay Load
360	3.58m/11'10"	2.13m/7'0"	2.51m/8'3"	5.06m/16'7"	710kg/14.0cwt	900kg/17.7cwt	190kg/3.7cwt
400	4.22m/13'10"	2.13m/7'0"	2.51m/8'3"	5.69m/18'8"	855kg/16.8cwt*	1060kg/20.8cwt	205kg/4.0cwt*
440	4.62m/15'2"	2.13m/7'0"	2.51m/8'3"	6.10m/20'0"	900kg/17.7cwt*	1150kg/22.6cwt	250kg/4.9cwt
450	4.59m/15'0"	2.13m/7'0"	2.51m/8'3"	6.06m/19'11"	900kg/17.7cwt*	1150kg/22.6cwt	250kg/4.9cwt*
470	4.65m/15'3"	2.13m/7'0"	2.51m/8'3"	6.13m/20'1"	910kg/17.9cwt	1150kg/22.6cwt	240kg/4.7cwt
480	4.65m/15'3"	2.13m/7'0"	2.51m/8'3"	6.13m/20'1"	920kg/18.1cwt*	1150kg/22.6cwt	230kg/4.5cwt*
490	5.15m/16'11"	2.13m/7'0"	2.51m/8'3"	6.62m/21'9"	960kg/18.9cwt	1200kg/23.6cwt	240kg/4.7cwt
490L	5.15m/16'11"	2.13m/7'0"	2.51m/8'3"	6.62m/21'9"	975kg/19.2cwt	1200kg/23.6cwt	225kg/4.4cwt
510	5.10m/16'9"	2.13m/7'0"	2.51m/8'3"	6.58m/21'7"	950kg/18.7cwt	1200kg/23.6cwt	250kg/4.9cwt

\*Estimated

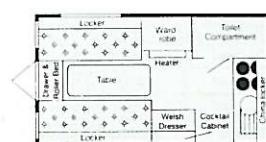

CHALLENGER 360

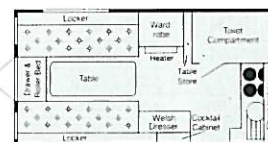

CHALLENGER 400

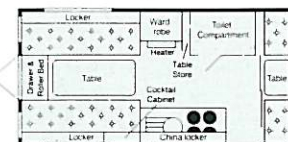

CHALLENGER 440

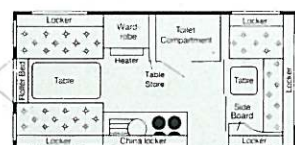

CHALLENGER 450

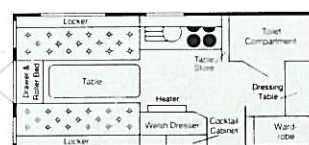

CHALLENGER 470

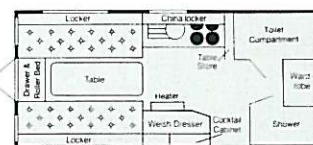

CHALLENGER 480

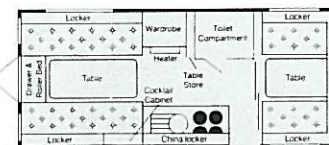

CHALLENGER 490

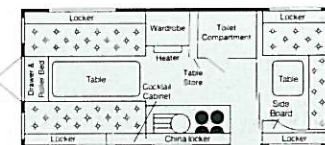

CHALLENGER 490 L

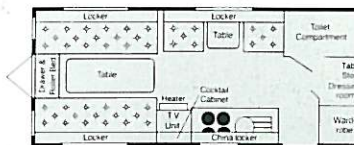

CHALLENGER 510

- 12v socket
- TV aerial socket
- 240v mains reading lights
- 12v reading lights
- Awning light
- Exterior access battery box (excl. battery)
- 10 amp switch mode charger transformer
- 70 litre electronic ignition 3 way Electrolux fridge (77 litre with full-width freezer compartment in the 360)
- Maxol 3000 spark ignition oven
- 4 burner spark ignition enamelled hob
- Enamelled bowl and drainer
- Carver Trumatic 3kw heater with blown air central heating (1.8kw 360)
- Thetford cassette toilet
- Carver Cascade gas/electric water heater
- Fitted shower with riser bar
- Blinds and flyscreens to all opening windows
- Roof light with night blind and flyscreen (flyscreen only in toilet)
- Exterior door window with blind
- Cocktail cabinet (not the 450)
- Solid ash framed furniture doors
- New style crockery racks
- Lined velvet curtains
- Opening window with blind and flyscreen to toilet compartment



# THE CORNICHE RANGE

The Corniche in its all-glace colour has a most distinctive shape and is arguably the most attractive caravan available anywhere in Europe.

It provides the perfect answer for the person seeking a unique blend of individuality and uncompromising style and comfort.

The furniture doors have a new deep lacquered finish, while the soft furnishings are made up in a new style to project the pure quality of the Corniche.

The kitchen now has a cooker hood with extractor fan, activated by a domestic style pull out door, and an insulated underslung fresh water tank feeds the kitchen and shower room.

## MAIN FEATURES

- Mains electrics with 3 sockets
- 20 metre mains electric cable
- 12v socket
- Omnimax Gazelle TV antenna with radio aerial
- 240v mains reading lights



CORNICHE	Internal Length (At bed box height)	Overall Width	Overall Height	Overall Length	Ex Works Weight +/- 5%	Maximum Authorised Weight	Caravan Allowable Pay Load
12/2	3.78m/12'5"	2.13m/7'0"	2.47m/8'1"	5.47m/18'0"	840kg/16.5cwt	1060kg/20.8cwt	220kg/4.3cwt
15/2	4.65m/15'3"	2.13m/7'0"	2.47m/8'1"	6.35m/20'10"	940kg/18.5cwt	1150kg/22.6cwt	210kg/4.1cwt
15/2 E	4.65m/15'3"	2.13m/7'0"	2.47m/8'1"	6.35m/20'10"	930kg/18.3cwt*	1150kg/22.6cwt	220kg/4.3cwt*
15/4	4.65m/15'3"	2.13m/7'0"	2.47m/8'1"	6.35m/20'10"	960kg/18.9cwt*	1150kg/22.6cwt	190kg/3.7cwt*

\*Estimated

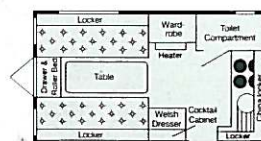

CORNICHE 12/2

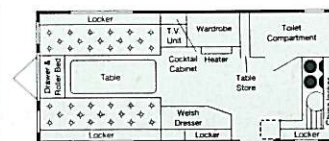

CORNICHE 15/2

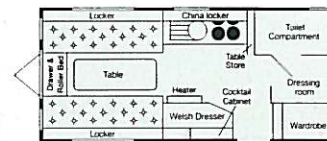

CORNICHE 15/2 E

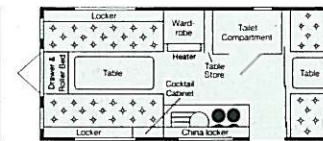

CORNICHE 15/4

- 12v reading lights
- Awning light
- Exterior access battery box (excl. battery)
- 10 amp switch mode charger transformer
- 70 litre electronic ignition 3 way Electrolux fridge
- Maxal 3000 oven with thermostat & spark ignition
- 4 burner spark ignition enamelled hob
- Enamelled bowl and drainer
- Carver Trumatic 3kw heater with blown air central heating
- Thetford cassette toilet
- Carver Cascade gas/electric water heater
- Fitted shower with riser bar
- Insulated underslung fresh water tank (9 gallons)
- Blinds and flyscreens to all opening windows
- Roof light with night blind and flyscreen (flyscreen only in toilet)
- Cocktail cabinet
- Solid ash framed furniture doors
- New style crockery racks
- Spare wheel and tyre
- Scissor jack
- Lined velvet curtains
- Cooker hood and extractor fan





All models



15/2



15/2



15/2 and 15/2E



15/2



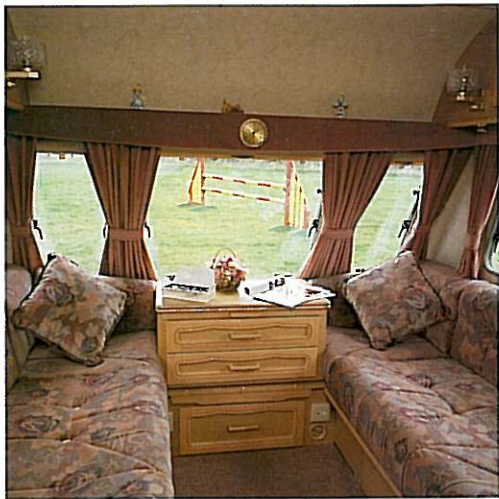

640 Salon



640 Salon



640 Salon



520 Lux



All models





# THE CONQUEROR RANGE

For size, style and comfort, the four-model Conqueror range offers the ultimate touring experience.

A new 520 single axle model, featuring one of Europe's most popular layouts, joins the range for 1993. With its spacious side board on the nearside, it provides an ideal living area, leaving the front dinette to act as a second or permanent bedroom as required.

The three twin axle models also get improvements to the furniture, while the new 550 features the unique ergonomically designed kitchen launched in 640 models last year.

The Conquerors, year-round caravanning in the grandest of style.

## MAIN FEATURES

- Mains electrics with 3 sockets
- 20 metre mains electric cable
- 12v socket
- Gazelle aerial with socket



- 240v mains reading lights
- 12v reading lights
- Awning light
- Exterior access battery box (excl. battery)
- 10 amp switch mode charger transformer
- 70 litre electronic ignition 3 way Electrolux fridge (77 litre 520) with full width freezer compartment
- Maxal 3000 oven with thermostat & spark ignition
- 4 burner spark ignition enamelled hob
- Enamelled bowl drainer
- Carver Trumatic 3kw blown air heating (5kw in 640)
- Theftford cassette toilet
- Carver Cascade gas/electric water heater
- Fitted shower with riser bar
- On-board fresh water tank (9 gallons)
- Blinds and flyscreens to all opening windows
- Roof lights with night blinds and flyscreen (flyscreen only in toilet)
- Cocktail cabinet
- Solid ash framed furniture doors
- New style crockery racks
- Spare wheel and tyre
- Scissor jack
- 2 bolster and scatter cushions (6'+ beds)
- Lined velvet curtains
- Extractor fan over hob

CONQUEROR	Internal Length (At bed box height)	Overall Width	Overall Height	Overall Length	Ex Works Weight +/- 5%	Maximum Authorised Weight	Caravan Allowable Payload
520 LUX	5.25m/17'3"	2.22m/7'3"	2.57m/8'5"	6.73m/22'1"	1050kg/20.7cwt	1300kg/25.6cwt	250kg/4.9cwt
550 LUX	5.50m/18'0"	2.22m/7'3"	2.57m/8'5"	6.97m/22'10"	1150kg/22.6cwt	1600kg/31.5cwt	450kg/8.9cwt
640 LUX	6.35m/20'10"	2.22m/7'3"	2.57m/8'5"	7.84m/25'8"	1235kg/24.3cwt*	1600kg/31.5cwt	365kg/7.2cwt*
640 SALON	6.35m/20'10"	2.22m/7'3"	2.57m/8'5"	7.84m/25'8"	1225kg/24.1cwt	1600kg/31.5cwt	375kg/7.4cwt

\*Estimated

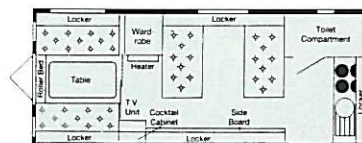

CONQUEROR 520 LUX

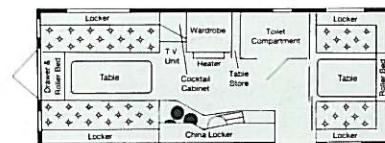

CONQUEROR 550 LUX

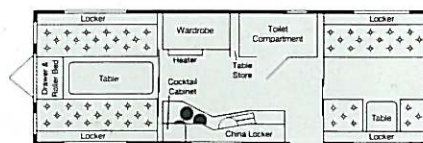

CONQUEROR 640 LUX

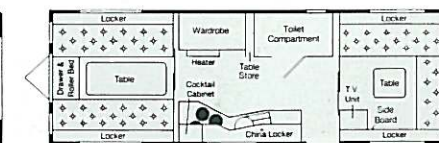

CONQUEROR 640 SALON



# SOFT FURNISHINGS

## THE CHOICE IS YOURS.

To give you the ultimate choice in personalising your new caravan, you can now specify your own fabric and curtain material from the wide range of options shown on these pages.

Your dealer will be able to give you full details of availability and cost.



Venice Velour Fabric



Windsor Velour Fabric



Galaxy Velour Fabric



Palace Velour Fabric



Balmoral Velour Fabric





Norfolk Velour Fabric



Raymaker Pink Velvet



Raymaker Green Velvet



Veltone Terracotta Velvet



Raymaker Plum Velvet

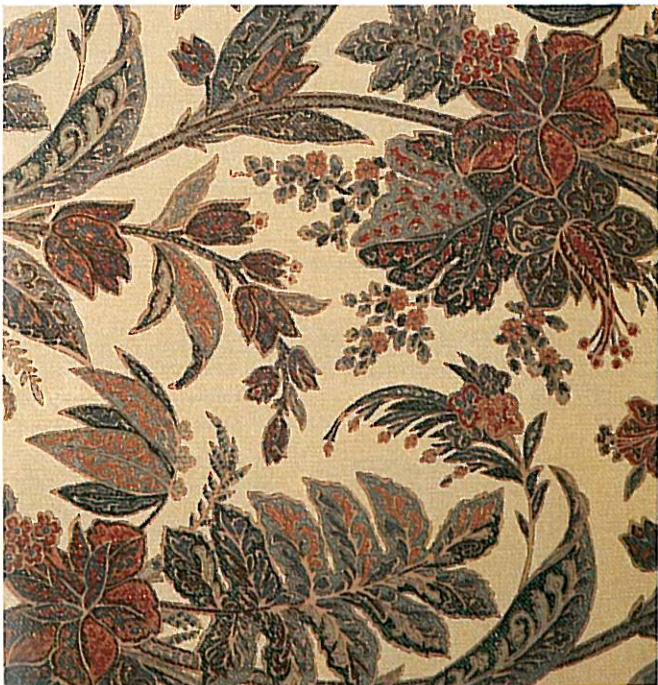

Penhurst Printed Fabric

FABRIC OPTIONS							
	VENICE	WINDSOR	NORFOLK	GALAXY	PALACE	BALMORAL	PENHURST
RAPIDE	STD	Opt	Opt	N/A	N/A	N/A	N/A
SWIFT DIAMOND	Opt	STD	Opt	Opt	Opt	Opt	N/A
CHALLENGER	Opt	Opt	Opt	STD	Opt	Opt	Opt
CORNICHE	Opt	Opt	Opt	Opt	STD	Opt	Opt
CONQUEROR	Opt	Opt	Opt	Opt	Opt	STD	Opt

FABRIC/CURTAIN COMBINATIONS	
FABRIC	CURTAINS
Venice	Raymaker Pink Velvet
Windsor	Raymaker Pink Velvet
Norfolk	Raymaker Pink Velvet
Galaxy	Raymaker Pink Velvet
Palace	Raymaker Green Velvet
Balmoral	Veltone Terracotta Velvet
Penhurst	Raymaker Plum Velvet





## FEATURES

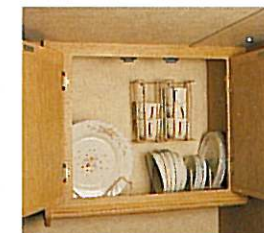

1	2	3	3	3	SPECIFICATION	1	2	3	3	3	SPECIFICATION
1	1	1	1	2	Mains electrics with sockets	opt	●	●	●	●	Carver Cascade gas/electric water heater
	1	1	1	2	12v sockets (1 on 520 & 550 Conq)	opt	●	●	●	●	Fitted shower with riser bar (no riser in Rapide/Swift Diamond)
		●	●	●	Aerial sockets (1 on 520 & 550 Conq)	●	●	●	●	●	Fitted shower tray
		●	●	●	240v mains reading lights	●	●	●	●	●	Fitted vanity unit with fixed basin
●	●	●	●	●	12v reading lights	●	●	●	●	●	In board water pipes
●	●	●	●	●	Fluorescent lights		●	●	●	●	Fresh water tank
	●	●	●	●	Awning lights		●	●	●	●	Vanity unit lower storage locker
	●	●	●	●	Side repeater flashers	●	●	●	●	●	Double glazed window (with night latch vents)
●	●	●	●	●	Reversing lights		opt	●	●	●	3 opening front windows
●	●	●	●	●	Front and side reflectors	opt	●	●	●	●	Part cassette blind kit
●	●	●	●	●	Front and side marker lights	opt	opt	●	●	●	Full cassette blind kit
opt	●	●	●	●	Exterior access battery box (Exc batt)		●	●	●	●	Roof lights with blinds and flyscreens
opt	●	●	●	●	10amp switch mode charger transformer	opt	●	●	●	●	Exterior door window with blind
●	●	●	●	●	60 litre Electrolux fridge		●	●	●	●	Door mat tray with brush out facility
		●	●	●	70 litre elec ignition Electrolux fridge		●	●	●	●	Draw pack with occasional table (6'+ beds only)
		■	●	◆	77 litre elec ignition Electrolux fridge ■ = 360 only/510 opt ◆ = 520 only	●	●	●	●	●	Pull out roller slatted beds
opt	opt	●	●	●	Maxol 3000 oven		●	●	●	●	Cocktail cabinets (except Danette, Corvette, Alouette, Challenger 450)
		●	●	●	Maxol 3000 spark ignition oven	●	●	●	●	●	Counter balance hinges to hob covers
		●	●	●	Maxol 3000 thermostatic spark ignition oven		●	●	●	●	Solid ash frame furniture doors
●	●	●	●	●	3 burner stainless steel hob		●	●	●	●	Table storage locker (except 360, 12/2, 520)
	●	●	●	●	3 burner enamelled hob	●	●	●	●	●	Free standing table
	●	●	●	●	4 burner spark ignition enamelled hob	●	●	●	●	●	Designer crockery holders
●	●	●	●	●	Stainless steel bowl drainer		●	●	●	●	Quartz clock
	●	●	●	●	Enamelled bowl drainer	opt	opt	opt	●	●	Spare wheel
●	●	▼	●	●	Carver Trumatic 1800 heater ▼ = 360 only		●	●	●	●	Scissor jack
	●	●	●	●	Carver Trumatic 3000 heater (not 360)		●	●	●	●	2 bolster and scatter cushions (6'+ beds)
	●	●	●	★	Carver Trumatic 5000 heater ★ = 640 only		●	●	●	●	Lined velvet curtains
	●	●	●	●	Blown air system		●	●	●	●	Extractor fan over hob
●	●	●	●	●	Thetford cassette toilet		●	●	●	●	Cooker hood with extractor fan



## BED SIZES

**RAPIDE 380:** 2 Berth: Front double 201cm x 152cm (6'7" x 5'0") or singles 191cm x 69cm (6'3" x 2'3").

**RAPIDE 400:** 4 Berth: Front double 201cm x 135cm (6'7" x 4'5"), single 201cm x 76cm (6'7" x 2'6"), bunk 201cm x 76cm (6'7" x 2'6").

**RAPIDE 430:** 4 Berth: Front double 201cm x 135cm (6'7" x 4'5"), single 187cm x 60cm (6'1" x 2'0"), bunk 173cm x 60cm (5'9" x 2'0").

**RAPIDE 440:** 4 Berth: Front double 201cm x 152cm (6'7" x 5'0") or singles 191cm x 76cm (6'3" x 2'3"), single 201cm x 76cm (6'7" x 2'6"), bunk 201cm x 76cm (6'7" x 2'6").

**RAPIDE 450:** 5 Berth: Front double 201cm x 135cm (6'7" x 4'5"), rear double 183cm x 115cm (6'0" x 3'8 1/2"), bunk 201cm x 69cm (6'7" x 2'3").

**RAPIDE 490:** 5 Berth: Front double 201cm x 152cm (6'7" x 5'0") or singles 191cm x 69cm (6'3" x 2'3"), rear double 201cm x 115cm (6'7" x 3'8 1/2"), bunk 201cm x 69cm (6'7" x 2'3").

**SWIFT DIAMOND MINUETTE:** 2 Berth: Front double 201cm x 142cm (6'7" x 4'8") or singles 191cm x 69cm (6'3" x 2'3") and 183cm x 69cm (6'0" x 2'3").

**SWIFT DIAMOND SILHOUETTE:** 2 Berth: Front double 201cm x 152cm (6'7" x 5'0") or singles 191cm x 69cm (6'3" x 2'3").

**SWIFT DIAMOND CORVETTE:** 4 Berth: Front double 201cm x 152cm (6'7" x 5'0") or singles 191cm x 69cm (6'3" x 2'3"), single 201cm x 76cm (6'7" x 2'3"), bunk 201cm x 76cm (6'7" x 2'3").

**SWIFT DIAMOND DANETTE:** 5 Berth: Front double 201cm x 135cm (6'7" x 4'5"), rear double 183cm x 115cm (6'0" x 3'8 1/2") or single 183cm x 69cm (6'0" x 2'3"), bunk 201cm x 69cm (6'7" x 2'3").

**SWIFT DIAMOND CORONETTE:** 2 Berth: Front double 201cm x 152cm (6'7" x 5'0") or singles 191cm x 69cm (6'3" x 2'3").

**SWIFT DIAMOND DOUBLETTE:** 2 Berth: Front double 201cm x 152cm (6'7" x 5'0") or singles 191cm x 69cm (6'3" x 2'3").

**SWIFT DIAMOND PIROUETTE:** 4 Berth: Front double 201cm x 135cm (6'7" x 4'5") or singles 180cm x 58cm (5'11" x 1'11"), bunk 180cm x 58cm (5'11" x 1'11").

**SWIFT DIAMOND ALOUETTE:** 5 Berth: Front double 201cm x 152cm (6'7" x 5'0"), single 191cm x 69cm (6'3" x 2'3"), rear double 183cm x 115cm (6'0" x 3'8 1/2") or single 183cm x 69cm (6'0" x 2'3"), bunk 201cm x 69cm (6'7" x 2'3").

**CHALLENGER 360:** 2 Berth: Front double 197cm x 142cm (6'5 1/2" x 4'8") or singles 191cm x 66cm (6'3" x 2'2") and 183cm x 66cm (6'0" x 2'2").

**CHALLENGER 400:** 2 Berth: Front double 197cm x 152cm (6'5 1/2" x 4'11") or singles 191cm x 66cm (6'3" x 2'2").

**CHALLENGER 440:** 4 Berth: Front double 197cm x 152cm (6'5 1/2" x 4'11") or singles 191cm x 66cm (6'3" x 2'2"), single 197cm x 76cm (6'5 1/2" x 2'6"), bunk 201cm x 76cm (6'7" x 2'6").

**CHALLENGER 450:** 5 Berth: Front double 197cm x 135cm (6'5 1/2" x 4'5"), rear double 180cm x 115cm (5'11" x 3'8 1/2") or single 180cm x 69cm (5'11" x 2'3"), bunk 201cm x 69cm (6'7" x 2'3").

**CHALLENGER 470:** 2 Berth: Front double 197cm x 152cm (6'5 1/2" x 4'11") or singles 191cm x 66cm (6'3" x 2'2").

**CHALLENGER 480:** 2 Berth: Front double 197cm x 152cm (6'5 1/2" x 4'11") or singles 191cm x 66cm (6'3" x 2'2").

**CHALLENGER 490:** 5 Berth: Front double 197cm x 152cm (6'5 1/2" x 4'11") or singles 191cm x 66cm (6'3" x 2'2"), rear double 197cm x 115cm (6'5 1/2" x 3'9 1/2"), bunk 201cm x 69cm (6'7" x 2'3").

**CHALLENGER 490 L:** 5 Berth: Front double 197cm x 152cm (6'5 1/2" x 4'11") or singles 191cm x 66cm (6'3" x 2'2"), rear double 180cm x 116cm (5'11" x 3'9") or single 180cm x 69cm (5'11" x 2'3"), bunk 201cm x 69cm (6'7" x 2'3").

**CHALLENGER 510:** 4 Berth: Front double 197cm x 152cm (6'5 1/2" x 4'11") or singles 191cm x 66cm (6'3" x 2'2"), single 180cm x 60cm (5'11" x 2'0"), bunk 180cm x 60cm (5'11" x 2'0").

**CORNICHE 12/2:** 2 Berth: Front double 197cm x 142cm (6'5 1/2" x 4'8") or singles 183cm x 66cm (6'0" x 2'2").

**CORNICHE 15/2:** 2 Berth: Front double 197cm x 152cm (6'5 1/2" x 4'11") or singles 191cm x 66cm (6'3" x 2'2").

**CORNICHE 15/2 E:** 2 Berth: Front double 197cm x 152cm (6'5 1/2" x 4'11") or singles 191cm x 66cm (6'3" x 2'2").

**CORNICHE 15/4:** 4 Berth: Front double 197cm x 152cm (6'5 1/2" x 4'11") or singles 191cm x 66cm (6'3" x 2'2"), single 197cm x 76cm (6'5 1/2" x 2'6"), bunk 201cm x 76cm (6'7" x 2'6").

**CONQUEROR 520 LUX:** 4 Berth: Front double 206cm x 135cm (6'9" x 4'5"), rear double 190cm x 123cm (6'2 1/2" x 4'0").

**CONQUEROR 550 LUX:** 5 Berth: Front double 206cm x 152cm (6'9" x 4'11") or singles 191cm x 66cm (6'3" x 2'2"), rear double 206cm x 115cm (6'9" x 3'9 1/2"), bunk 210cm x 69cm (6'10 1/2" x 2'3").

**CONQUEROR 640 LUX:** 5 Berth: Front double 206cm x 152cm (6'9" x 4'11") or singles 191cm x 66cm (6'3" x 2'2"), singles 180cm x 66cm (5'11" x 2'2") and 180cm x 60cm (5'11" x 2'0"), bunk 180cm x 60cm (5'11" x 2'0").

**CONQUEROR 640 SALON:** 4 Berth: Front double 206cm x 152cm (6'9" x 4'11") or singles 191cm x 66cm (6'3" x 2'2"), rear double 191cm x 140cm (6'3" x 4'7") or single 191cm x 68cm (6'3" x 2'3").

## AWNING SIZES (GROUND TO GROUND)

MODEL	SIZE
Rapide 380	8.00m/26'3"
Rapide 400	8.16m/26'9"
Rapide 430	8.59m/28'2"
Rapide 440	8.66m/28'5"
Rapide 450	8.66m/28'5"
Rapide 490	9.06m/29'9"
Swift Diamond Minuette	7.60m/24'11"
Swift Diamond Silhouette	8.06m/26'5"
Swift Diamond Corvette	8.60m/28'3"
Swift Diamond Danette	8.60m/28'3"
Swift Diamond Coronette	8.66m/28'5"
Swift Diamond Doublette	8.66m/28'5"
Swift Diamond Pirouette	8.69m/28'6"
Swift Diamond Alouette	9.16m/30'0"
Challenger 360	7.60m/24'11"
Challenger 400	8.23m/27'1"
Challenger 440	8.65m/28'5"
Challenger 450	8.60m/28'3"
Challenger 470	8.66m/28'5"
Challenger 480	8.66m/28'5"
Challenger 490	9.16m/30'0"
Challenger 490 L	9.16m/30'0"
Challenger 510	9.13m/29'11"
Corniche 12/2	7.61m/25'0"
Corniche 15/2	8.34m/27'4"
Corniche 15/2 E	8.34m/27'4"
Corniche 15/4	8.34m/27'4"
Conqueror 520 Lux	9.27m/30'5"
Conqueror 550 Lux	9.52m/31'3"
Conqueror 640 Lux	10.37m/34'0"
Conqueror 640 Salon	10.37m/34'0"

## TYRE SIZES

MODEL	SIZE	MODEL	SIZE
Rapide 380	155 R 13	Challenger 400	165 R 13 Reinforced
Rapide 400, 430	155 R 13 Reinforced	Challenger 440, 450, 470, 480	175 R 13 Reinforced
Rapide 440, 450, 490	165 R 13 Reinforced	Challenger 490, 490 L, 510	175 R 13 6 Ply
Swift Diamond Minuette, Silhouette	155 R 13 Reinforced	Corniche 12/2	165 R 13 Reinforced
Swift Diamond Corvette, Danette, Coronette, Doublette, Pirouette	165 R 13 Reinforced	Corniche 15/2, 15/2 E, 15/4	175 R 13 Reinforced
Swift Diamond Alouette	175 R 13 Reinforced	Conqueror 520 Lux	175 R 13 6 Ply
Challenger 360	155 R 13 Reinforced	Conqueror 550 Lux, 640 Lux, 640 Salon	155 R 13

Tyre rating is based on the maximum payload for sustained speeds not exceeding 130kph (80mph). Hitch heights are 415mm +/- 30mm on all models.





TATES CARAVANS  
HORN BROOK PARK  
A281, BRIGHTON ROAD  
HORSHAM, WEST SUSSEX. RH13 6QA  
Telephone: Horsham (0403) 55453



All caravans are manufactured for towing behind normal road cars and are not suitable for towing behind commercial vehicles other than passenger car derivatives. If in doubt, please consult Swift Caravans.

All caravans in this brochure conform to the British Standards for Touring Caravans: BS4626 and BS6765. This brochure does not constitute an offer by the Company. As part of our policy of continuous development the Swift Group Limited reserve the right to alter specifications and prices as materials and conditions demand.

### SWIFT GROUP LIMITED

Dunswell Road, Cottingham, North Humberside, HU16 4JX.

Tel: 0482 847332. Fax: 0482 841042.