



THE 1997
SWIFT
RANGE



QUALITY BEGINS WITH GOOD DESIGN



OVER THIRTY YEARS OF QUALITY AND INNOVATION has earned Swift Caravans a host of press and consumer awards and the distinction of being

revered as the thoroughbred of the touring caravan world.

Throughout the Conqueror, Corniche, Challenger and Classic ranges, 1997 brings a host of improvements on

all 22 Swift models. Redevelopment of washroom and changing areas gives you an even wider choice and the opportunity to select a layout that meets your needs precisely.

Investment in state-of-the-art computer technology ensures all models are produced to the highest quality standard. Innovative changes utilise Computer Aided Design techniques which allows Swift designers to consider

every possible improvement option before a prototype is even built.

This technology automatically checks safety and stability variances at the design stage. Even with all this technology, well over 200 rigorous manual tests are carried out to ensure absolute perfection. This commitment to quality has earned Swift the enviable ISO9001 certificate for the standard of quality manufacturing systems operated by the company.

The finest attention to detail, including carefully sourced propriety fixtures like Stoves ovens and Electrolux fridges, top quality raw materials and numerous safety features, are central to the Swift popularity and success. Traditional skills blended with the best of advanced technology has earned the company a reputation for producing the best quality touring caravans in Europe.

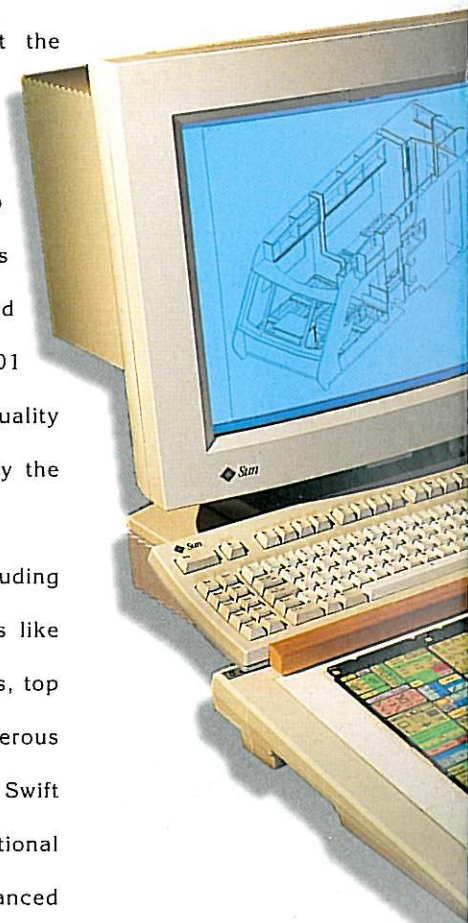

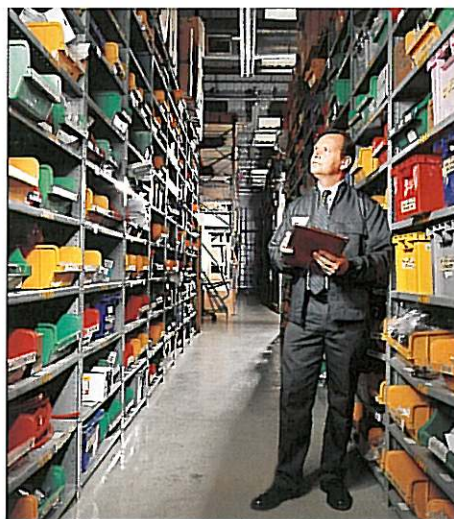

TOTAL CUSTOMER SATISFACTION is top priority at the Swift Group, and the quality ethos extends through to authorised Swift dealers who are carefully chosen for their outstanding level of service.

Swift maintains a team of specialists who operate Swift Supercare, a highly sophisticated after sales operation that utilises a national computer system linking dealers directly to the manufacturing site. Supercare provides professional help and advice to dealers as well as efficient handling of all parts ordering and supply, to keep you on the road to happy holidays.

All owners of new Swift caravans also benefit from a comprehensive three

year warranty scheme called Swift SuperSure. The warranty is operated by Swift for the first year and administered by the highly reputable Warranty Holdings in subsequent years. For a competitive single premium, Swift SuperSure can be extended for a further two years, giving a full five years' peace of mind. Warranty maintenance simply involves an annual service by an authorised Swift dealer.

Swift dealers offer a range of financial services via leading finance houses, comprehensive caravan insurance through specialist insurers and can also supply a host of useful accessories, all designed to make sure you have everything you need for the perfect holiday, the Swift way.

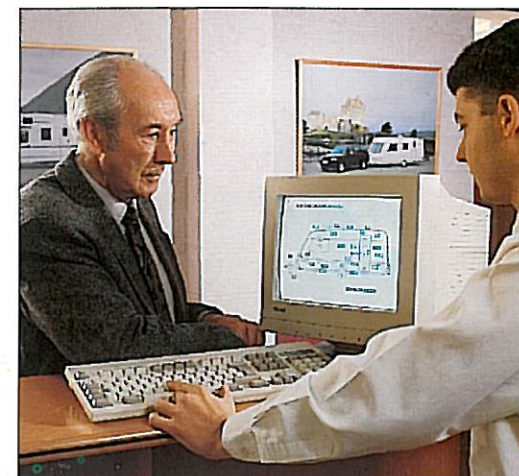

To reserve your place on a factory tour to see Swift products being produced in one of Europe's most sophisticated factories, simply call the number on the back of the brochure.

SUPERCARE AND SUPERSURE
FOR TOTAL PEACE OF MIND

CORNICHE RANGE

WITH ITS UNIQUE EXTERIOR SHAPE, created through the skilled use of Glass Reinforced Plastic, and its striking all white colour scheme with markings in gold and burgundy and large gold trimmed windows, the award winning Corniche is as impressive in appearance as it is luxurious in specification.

Add a much wider choice of washroom layouts for 1997 and the Corniche is the range that provides everything you will ever need for true luxury touring at any time of the year.





Wall to wall luxury and the finest soft furnishings with the best Belgian fabrics.

15/2E L option



15/2E



All models



15/2E



15/2



15/2E

Right 15/2
(L option)

WITH A CHOICE OF PARALLEL OR L SHAPED FRONT SEATING IN ALL MODELS, and the option of two different washroom styles in the Corniche 15/2E and 16/3, you have maximum opportunity to tailor make your own layout in five star luxury.

Both these models feature the latest domestic style swivel toilet, and have a separate shower room, dressing area with wardrobe and vanity unit. Blown air heating is via the latest Carver 3600 electronic ignition heater, and the large 77 litre fridge with full width freezer compartment is concealed behind a matching wooden door. The finest attention to detail wherever you look.



CONQUEROR RANGE



640

RENOWNED FOR ITS IMPRESSIVE STYLE AND HIGH STANDARD OF COMFORT, the Conqueror range offers three spacious models, including a new 580 model which is available with two luxury washroom options.

Kitchens have been upgraded with the latest flush fitting Stoves oven, heating features the Carver 3600 with Fanmaster element, there is a new dedicated TV station, and a new infrared alarm system tops a list of other security features to protect your holiday investment.



580

Right 640
(L option)
with optional
air conditioning.





640



640

CHALLENGER RANGE



440

Right 530

FOR YEARS, THE CHALLENGER HAS BEEN THE FIRM FAVOURITE WITH THE COMMITTED CARAVANNER, offering the perfect combination of style, specification and level of sophistication essential for those who see their caravan as an extension to their everyday life.

For 1997, the Challenger provides three different washroom options, detailed on the washrooms page, and a series of major improvements in specification, many of which they share with the more expensive Corniche and Conqueror ranges, making them clear leaders in their class.





All models have L shape front option. 490 featured has L shaped rear seating and optional parallel seating.



490

Re-styled furniture and new flush fitting Stoves oven.



490



530

CLASSIC RANGE

FOR LEVEL OF SPECIFICATION, value for money and choice of both two berth and family layouts, there can be little to beat the 1997 Classic range. With three new layouts, and the choice of five different washrooms, three of which have separate changing area with vanity unit, wardrobe, toilet and separate shower compartment, this introduction into the Swift model range has never been so affordable, giving you no reason to compromise.



Alouette





Solid ash framed furniture doors add the perfect finishing touch.

Pirouette



Silhouette

Classic Swift styling gives a distinctive prestige appearance.



Left Doublette

Doublette

WASHROOMS

A major redevelopment of the washroom and changing areas in all four Swift ranges has provided the widest ever choice of layouts for 1997. No fewer than five designs are featured offering the greatest possible combination of options in this key area.



NT Layout



EV Layout

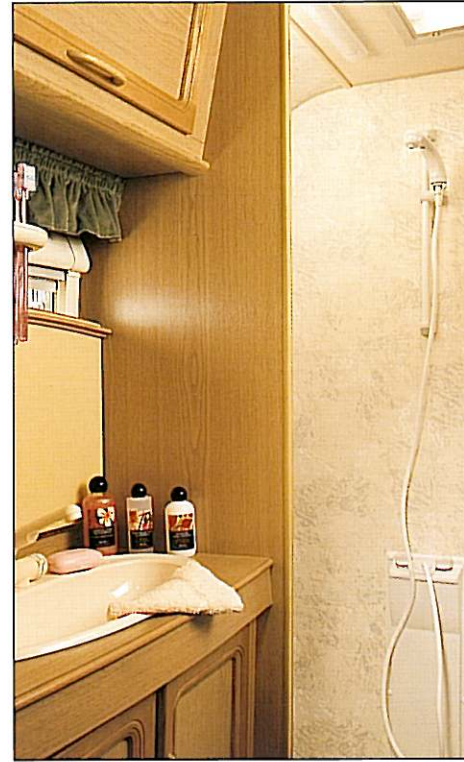

RT Layout

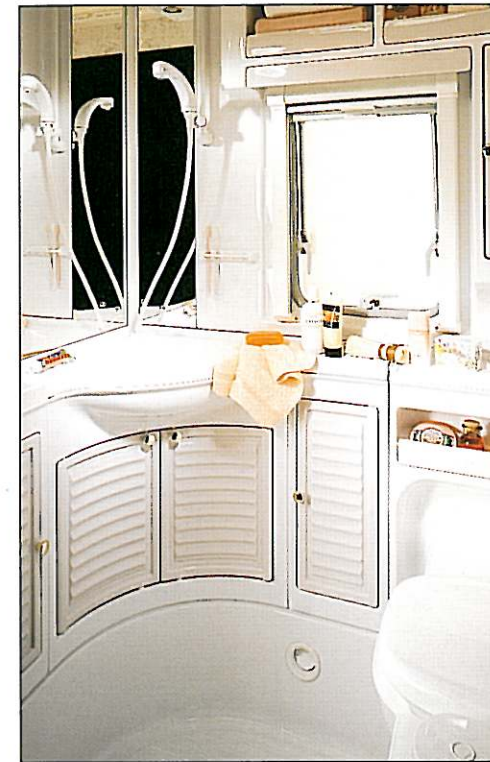

Centre Layout

NEARSIDE TOILET WASHROOM (NT) LAYOUT IS AVAILABLE IN THE FOLLOWING MODELS:

DUETTE,
BARONETTE,
CHALLENGER 470
CHALLENGER 520
CORNICHE 15/2E
CORNICHE 16/3
CONQUEROR 580



END VANITY (EV) IS AVAILABLE IN THE FOLLOWING MODEL:

PIROUETTE

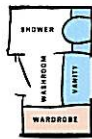

REAR FACING TOILET WASHROOM (RT) LAYOUT IS AVAILABLE IN THE FOLLOWING MODELS:

DOUBLETTE
CHALLENGER 480
CHALLENGER 530

OPTIONAL IN:

CORNICHE 15/2E
CORNICHE 16/3
CONQUEROR 580



CENTRE LAYOUT IS AVAILABLE IN THE FOLLOWING MODELS:

SILHOUETTE
CORVETTE
ALOUETTE
CHALLENGER 400
CHALLENGER 440
CHALLENGER 490
CORNICHE 13/2
CORNICHE 15/2
CONQUEROR 550
CONQUEROR 640



END SHOWER (ES) IS AVAILABLE IN THE FOLLOWING MODEL:

CORONETTE



NOTE: TOILET WINDOW POSITIONS VARY BETWEEN MODEL RANGES

FEATURES

Features will vary depending on model range concerned. Please refer to individual specification sheets for each range.



Flyscreen door.



Electrical control console.



Ash framed furniture with soft shut seal.

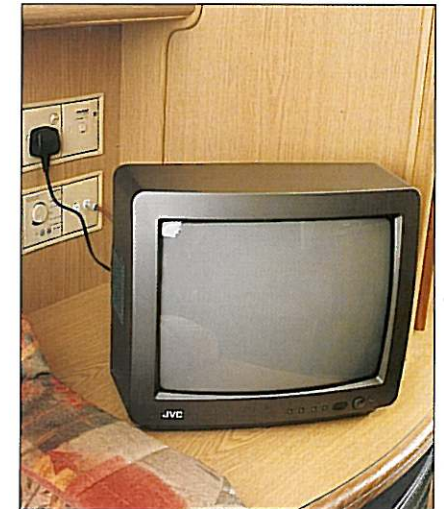

Dedicated Television unit.



Easy access gas bottle storage.



12v exterior plug socket.



Vegetable rack.

CORNICHE RANGE

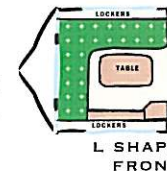
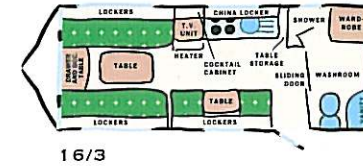
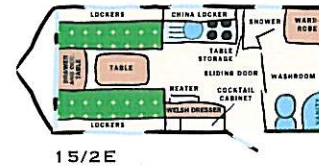
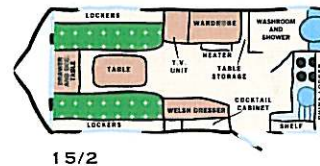
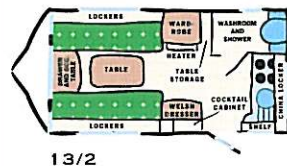

• All models have L shaped front option.

New for 1997

- Corniche 16/3 revised layout
- Revised bathroom layouts for Corniche 15/2E

EXTERIOR

- Light weight Al-Ko galvanised steel chassis with Euro-Axle
- Exterior door with window and window blind
- Three opening front windows
- Exterior access battery box (excluding battery)
- Easy access cantilever gas bottle locker door
- High level tail and brake lights
- Awning light
- Reversing lights
- Side direction indicator lights
- Status TV aerial and booster

LOUNGE DINING AREA

- Free standing ash edged table with dedicated storage
- Drawer unit with occasional table
- Fitted cocktail cabinet
- Domestic quality interior sprung bedding and backrests
- Lined velvet curtains
- Upholstered armrests and scatter cushions

New for 1997

- New design for curtains and upholstery

KITCHEN

- High impact polycarbonate bowl/drain in green
- Pull out extractor hood over hob

New for 1997

- New domestic style flush fitting Stoves green, four burner hob, oven and grill with FFD and electronic ignition
- Electrolux 77 litre electric ignition fridge with full width freezer compartment with solid ash framed cloaking door

HEATING & PLUMBING

- Carver 3600 space heater with Fanmaster electric heating
- Blown air central heating
- Inboard rigid piped pressurised water system

- Insulated fresh water tank
- Luxury bathroom suite with built-in wall mirrors, matching shower and vanity unit with integral storage (layout varies depending on model)
- Thetford cassette toilet with exterior filler pump

New for 1997

- New Improved bathroom layouts
- Carver 3600 space heater with electronic ignition and Fanmaster electric heating
- Carver rapid gas/electric powered water heater

ELECTRICAL

- Mains electrics with four 230v sockets (including one exterior socket)
- TV Station with 230v/12v/aerial connection point
- Low level interior lighting
- 230v and 12v reading lights
- Switch mode charger/transformer
- 25 metre mains hook up cable

New for 1997

- PMS 2000 sophisticated central electrical control panel

FITTINGS & EQUIPMENT

- Double glazing with night latch ventilation
- Full window blinds and flyscreens to all opening windows
- Cassette flyscreen to exterior door
- Roof lights with night blinds and flyscreens (to main compartment)
- Pull out roller slatted bed
- Vent boards to back rests
- Solid ash framed furniture doors
- Concealed metal wall plates for secure furniture fixing
- Quartz clock
- Spare wheel and tyre
- Scissor jack

New for 1997

- Philips stereo radio/cassette

SECURITY

- Passive infrared security alarm
- Single key high security locks
- Identity number etched to windows and stamped on chassis
- Locking rear corner steadies

| MODEL | 13/2 | 15/2 | 15/2E | 16/3 |
|---|----------------|----------------|----------------|-----------------|
| BERTHS | 2 | 2 | 2 | 2 - 3 |
| INTERNAL LENGTH (AT BED BOX HEIGHT) | 3.99m/13'1" | 4.65m/15'3" | 4.65m/15'3" | 5.30m/17'4" |
| OVERALL WIDTH | 2.13m/7'0" | 2.13m/7'0" | 2.13m/7'0" | 2.13m/7'0" |
| OVERALL HEIGHT | 2.71m/8'11" | 2.71m/8'11" | 2.71m/8'11" | 2.71m/8'11" |
| OVERALL LENGTH | 5.59m/18'4" | 6.25m/20'6" | 6.25m/20'6" | 6.90m/22'7" |
| EX-WORKS WEIGHT (SEE NOTE) | 940kg/18.4cwt | 1035kg/20.3cwt | 1020kg/20cwt | 1150kg/22.6cwt* |
| MAXIMUM AUTHORISED WEIGHT | 1175kg/23cwt | 1300kg/25.6cwt | 1300kg/25.6cwt | 1425kg/28cwt |
| CARAVAN ALLOWABLE PAYLOAD | 205kg/4.0cwt | 230kg/4.5cwt | 250kg/4.9cwt | 240kg/4.7cwt* |
| MAXIMUM TECHNICAL PERMISSIBLE WEIGHT | 1300kg/25.6cwt | 1300kg/25.6cwt | 1300kg/25.6cwt | 1460kg/28.7cwt |
| AWNING SIZE GROUND TO GROUND | 7.93m/26'0" | 8.60m/28'3" | 8.60m/28'3" | 9.25m/30'4" |
| TYRE SIZES | 175 R13 6 ply | 175 R13 6 ply | 175 R13 6 ply | 185 R13 6 ply |

Note: A tolerance of 3% in the ex-works weight has been allowed for in the calculation of payload margins (i.e. Maximum Authorised Weight = Payload + Ex-works weight plus 3%).

* Estimated

BED SIZES

| | 13/2 | 15/2 | 15/2E | 16/3 |
|-----------|-------------|-----------------------|-----------------------|--------------------------|
| Singles | 6'2" x 2'2" | Singles 6'2" x 2'2" | Singles 6'2" x 2'2" | Singles 6'2" x 2'2" |
| or double | 6'6" x 6'2" | or double 6'6" x 6'2" | or double 6'6" x 6'2" | and 6'0" x 2'2" |
| | | | | or double 6'6" x 6'0" |
| | | | | Side single 5'11" x 2'2" |

Note: Payloads on all 1997 Swift Caravans (all ranges). Maximum Authorised weight (MAW) - is the maximum weight all caravans are plated to by the manufacturer to include a normal payload. Maximum Technical Permissible Weight (MTPW) - if you require extra payload, in some cases it may be possible to increase the MAW to the MTPW. To do this, you must contact your dealer who will arrange to have a new weight plate supplied by the manufacturer for a charge. If you exceed the Maximum Authorised Weight plated on your Swift tourer you could be liable to prosecution.

CONQUEROR RANGE

New for 1997

- Conqueror 580
- Revised layout in Conqueror 640
- New bathroom in Conqueror 580

EXTERIOR

- Stylish exterior shape with roof spoiler incorporating tail lights
- Light weight Al-Ko galvanised steel chassis with Euro-Axle
- Exterior door with window and window blind
- Three opening front windows
- Exterior access battery box (excluding battery)
- Easy access gas bottle storage with gas strut
- Bolt on wheel trims
- Awning light
- Reversing lights
- Side direction indicator lights
- Status TV aerial and booster

LOUNGE DINING AREA

- Free standing ash edged table with dedicated storage
- Drawer unit with occasional table
- Fitted cocktail cabinet
- Domestic quality interior sprung bedding and backrests
- Lined velvet curtains
- Shaped armrests and scatter cushions

New for 1997

- 640 standard as five berth
- New profile to solid ash framed furniture doors

KITCHEN

- Electrolux 77 litre electric ignition fridge with full width freezer compartment
- High impact polycarbonate bowl/drain in green

New for 1997

- New domestic style flush fitting Stoves green four burner hob, grill and oven with FFD and electronic ignition

HEATING & PLUMBING

- Carver 3600 space heater with Fanmaster electric heating
- Blown air central heating
- Inboard rigid piped pressurised water system

- Insulated fresh water tank
- Luxury bathroom suite with built-in wall mirrors, matching shower and vanity unit with integral storage (layout varies depending on model)
- Thetford cassette toilet with exterior filler pump

New for 1997

- Carver 3600 space heater with electronic ignition and Fanmaster electric heating
- Carver rapid gas/electric powered water heater

ELECTRICAL

- Mains electrics with three 230v sockets
- 230v and 12v reading lights
- TV Station with 230v/12v/aerial connection point
- Switch mode charger/transformer
- 25 metre mains hook up cable

New for 1997

- PMS 2000 sophisticated central electrical control panel
- Dedicated radio/cassette storage facility (excluding radio)

FITTINGS & EQUIPMENT

- Double glazing with night latch ventilation
- Full window blinds and flyscreens to all opening windows
- Cassette flyscreen to exterior door
- Roof lights with night blinds and fly-screens (to main compartment)
- Pull out roller slatted bed
- Vent boards to back rests
- Solid ash framed furniture doors
- Concealed metal wall plates for secure furniture fixing
- Quartz clock
- Spare wheel and tyre
- Scissor jack
- Omnivent 12v fan and skylight
- Door mat with brush out facility

SECURITY

- Passive infrared security alarm
- Single key high security locks
- Identity number etched to windows and stamped on chassis

New for 1997

- New alarm system
- Locking rear corner steadies

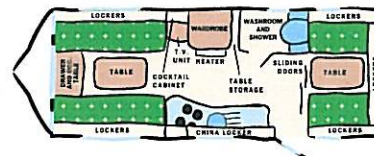

550

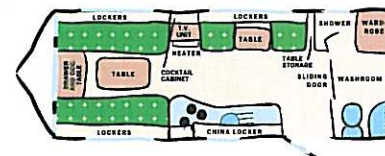

580



640

- All models have L shaped front option.

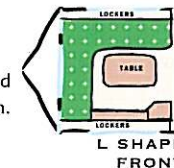

| MODEL | 550 | 580 | 640 |
|---|----------------|----------------|----------------|
| BERTHS | 2-5 | 2-4 | 2-5 |
| INTERNAL LENGTH (AT BED BOX HEIGHT) | 5.50m/18'0" | 5.80m/19'0" | 6.35m/20'10" |
| OVERALL WIDTH | 2.22m/7'3" | 2.22m/7'3" | 2.22m/7'3" |
| OVERALL HEIGHT | 2.71m/8'11" | 2.71m/8'11" | 2.71m/8'11" |
| OVERALL LENGTH | 6.97m/22'10" | 7.27m/23'10" | 7.82m/25'8" |
| EX-WORKS WEIGHT | 1220kg/23.9cwt | 1190kg/23.3cwt | 1305kg/25.6cwt |
| MAXIMUM AUTHORISED WEIGHT | 1600kg/31.4cwt | 1600kg/31.4cwt | 1600kg/31.4cwt |
| CARAVAN ALLOWABLE PAYLOAD | 340kg/6.7cwt* | 375kg/7.4cwt | 255kg/5.6cwt |
| MAXIMUM TECHNICAL PERMISSIBLE WEIGHT | 1600kg/31.4cwt | 1600kg/31.4cwt | 1600kg/31.4cwt |
| AWNING SIZE GROUND TO GROUND | 9.63m/31'7" | 9.93m/32'7" | 10.48m/34'5" |
| TYRE SIZES | 155 R13 4 ply | 155 R13 4 ply | 155 R13 4 ply |

Note: A tolerance of 3% in the ex-works weight has been allowed for in the calculation of payload margins (i.e. Maximum Authorised Weight = Payload + Ex-works weight plus 3%).

* Estimated

BED SIZES

550 LUX

| | |
|---------------|--------------|
| Front singles | 6'2" x 2'2" |
| or double | 6'9" x 6'2" |
| Rear double | 6'9" x 3'10" |
| Bunk | 6'11" x 2'0" |

580 SALON

| | |
|---------------|------------------|
| Front singles | 6'4" x 2'2" |
| or double | 6'9" x 6'4" |
| Side single | 5'11" x 2'0 1/2" |
| Bunk | 5'11" x 1'11" |

640 SALON

| | |
|---------------|---------------|
| Front singles | 6'4" x 2'2" |
| or double | 6'9" x 6'4" |
| Rear double | 6'9" x 4'7" |
| Bunk | 6'11" x 1'11" |

CHALLENGER SE RANGE

New for 1997

- Revised bathroom layouts for Challenger 470, 480, 520 and 530 models

EXTERIOR

- Light weight Al-Ko galvanised steel chassis with Euro-Axle
- Exterior door with window and window blind
- Three opening front windows
- Exterior access battery box (excluding battery)
- Easy access gas bottle storage with gas strut
- Bolt on wheel trims
- Awning light
- Reversing lights
- Status TV aerial and booster
- Roof spoiler incorporating high level tail lights

New for 1997

- Even larger window area
- Exterior graphics and badging

LOUNGE DINING AREA

- Free standing ash edged table with dedicated storage
- Drawer unit with occasional table
- Fitted cocktail cabinet
- Domestic quality interior sprung bedding & backrests
- Lined velvet curtains
- 2 bolster cushions and scatter cushions

New for 1997

- New design for carpets, curtains and upholstery

KITCHEN

- Electrolux 77 litre electric ignition fridge with full width freezer compartment
- High impact polycarbonate bowl/drain
- Pull out chopping board in centre kitchens

New for 1997

- New domestic style flush fitting Stoves sandstone - four burner hob, oven and grill with FFD and electronic ignition

HEATING & PLUMBING

- Blown air central heating
- Luxury bathroom suite with built-in wall mirrors, matching shower and vanity unit with integral storage (layout varies depending on model)
- Thetford cassette toilet

New for 1997

- Carver 3600 space heater with electronic ignition and Fanmaster electric heating
- Carver rapid gas/electric powered water heater

ELECTRICAL

- Mains electrics with three 230v sockets
- 12v socket
- 230v and 12v reading lights
- Switch mode charger/transformer
- 25 metre mains hook up cable

New for 1997

- Dedicated TV Station with 230v/12v/aerial connection point
- PMS 2000 sophisticated central electrical control panel with ELCB

FITTINGS & EQUIPMENT

- Double glazing with night latch ventilation
- Full window blinds and flyscreens to all opening windows
- Full length cassette flyscreen to exterior door
- Roof lights with night blinds and flyscreens (to main compartment)
- Pull out roller slatted bed
- Fully slatted bed box tops
- Vent boards to back rests
- Concealed metal wall plates for secure furniture fixing
- Quartz clock
- Door mat with brush out facility

New for 1997

- New look solid ash framed furniture doors

SECURITY

- Single key high security locks
- Identity number etched to windows and stamped on chassis
- Exterior road lighting isolator

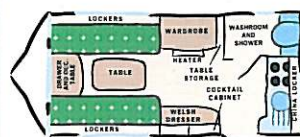

400

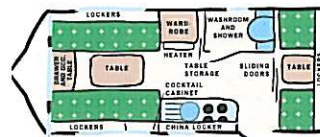

440

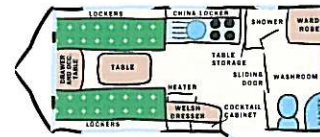

470

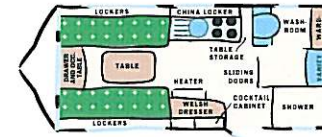

480



490

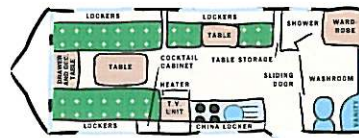

520

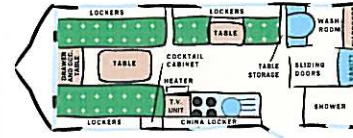

530

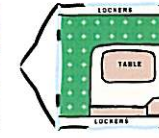

L SHAPE
FRONT



PARALLEL
REAR (490)

- All models have L shaped front option.

- Challenger 490 has parallel rear option.

| MODEL | 400 | 440 | 470 | 480 | 490 | 520 | 530 |
|---|----------------|----------------|----------------|----------------|----------------|----------------|----------------|
| BERTHS | 2 | 2-4 | 2 | 2 | 2-5 | 2-5 | 2-5 |
| INTERNAL LENGTH (AT BED BOX HEIGHT) | 4.27m/14'0" | 4.70m/15'5" | 4.70/15'5" | 4.70m/15'5" | 5.23m/17'2" | 5.30m/17'5" | 5.30m/17'5" |
| OVERALL WIDTH | 2.13m/7'0" | 2.13m/7'0" | 2.13m/7'0" | 2.13m/7'0" | 2.13m/7'0" | 2.13m/7'0" | 2.13m/7'0" |
| OVERALL HEIGHT | 2.71m/8'11" | 2.71m/8'11" | 2.71m/8'11" | 2.71m/8'11" | 2.71m/8'11" | 2.71m/8'11" | 2.71m/8'11" |
| OVERALL LENGTH | 5.74m/18'10" | 6.17m/20'3" | 6.17m/20'3" | 6.17m/20'3" | 6.70m/22'0" | 6.77m/22'3" | 6.77m/22'3" |
| EX-WORKS WEIGHT | 865kg/17cwt | 930kg/18.3cwt | 925kg/18.2cwt* | 950kg/18.6cwt* | 1015kg/19.9cwt | 1040kg/20.5cwt | 1030kg/20.3cwt |
| MAXIMUM AUTHORISED WEIGHT | 1100kg/21.6cwt | 1200kg/23.6cwt | 1200kg/23.6cwt | 1200kg/23.6cwt | 1250kg/24.6cwt | 1300kg/25.6cwt | 1300kg/25.6cwt |
| CARAVAN ALLOWABLE PAYLOAD | 205kg/4cwt | 240kg/4.7cwt | 245kg/4.8cwt* | 220kg/4.3cwt* | 205kg/4cwt | 230kg/4.5cwt* | 270kg/5.3cwt |
| MAXIMUM TECHNICAL PERMISSIBLE WEIGHT | 1300kg/25.6cwt | 1300kg/25.6cwt | 1300kg/25.6cwt | 1300kg/25.6cwt | 1300kg/25.6cwt | 1300kg/25.6cwt | 1300kg/25.6cwt |
| AWNING SIZE GROUND TO GROUND | 8.45m/27'9" | 8.90m/29'2" | 8.90m/29'2" | 8.90m/29'2" | 9.37m/30'9" | 9.44m/31'10" | 9.44m/31'10" |
| TYRE SIZES | 175 R13 6 ply | 175 R13 6 ply | 175 R13 6 ply | 175 R13 6 ply | 175 R13 6 ply | 175 R13 6 ply | 175 R13 6 ply |

Note: A tolerance of 3% in the ex-works weight has been allowed for in the calculation of payload margins (i.e. Maximum Authorised Weight = Payload + Ex-works weight plus 3%).

* Estimated

BED SIZES

| | 400 | 470 | 480 | 440 | 490 | 520 | 530 |
|--------------|-------------|-------------|-------------|--------------|--------------|------------------|------------------|
| Front single | 6'2" x 2'2" | 6'2" x 2'2" | 6'2" x 2'2" | 6'2" x 2'2" | 6'6" x 2'2" | 6'2" x 2'2" | 6'2" x 2'2" |
| or double | 6'6" x 6'2" | 6'6" x 6'2" | 6'6" x 6'2" | 6'6" x 6'2" | 6'6" x 6'2" | 6'6" x 6'0" | 6'0" x 2'2" |
| Rear single | | | | 6'7" x 1'11" | 6'0" x 3'11" | 5'11" x 2'0 1/2" | 6'6" x 6'0" |
| Bunk | | | | | 6'0" x 2'3" | 5'11" x 1'11" | 5'11" x 2'0 1/2" |
| | | | | | 6'0" x 1'11" | | 5'11" x 1'11" |

CLASSIC RANGE

New for 1997

- New models - Duette, Corvette and Doublette
- Revised bathroom layouts for Coronette and Baronette

EXTERIOR

- Stylish exterior shape
- Light weight Al-Ko galvanised steel chassis with Euro-Axle
- Exterior door with window and window blind
- Three opening front windows
- Exterior access battery box (excluding battery)
- Easy access gas bottle storage with gas strut
- Bolt on wheel trims
- Awning light
- Reversing lights
- Status TV aerial & booster

New for 1997

- Larger window area

LOUNGE DINING AREA

- Free standing table with dedicated storage
- Drawer unit with occasional table (excluding Pirouette)
- Lined velvet curtains
- 2 bolster cushions and scatter cushions
- Domestic quality interior sprung bedding and backrests (except bunks and side dinettes)

New for 1997

- New fabrics for carpets, curtains and upholstery

KITCHEN

- Electrolux 70 litre Piezo ignition fridge
- 4 burner enamel hob with FFD and grill
- Stoves thermostatic manual oven
- High impact polycarbonate bowl/drain
- Chinchilla worktop cutting surface

IMPERIAL BED SIZES CONVERSION CHART

| | | | |
|-----------------|---------------|---------------|---------------|
| 1'11" = 59cm | 2'7" = 80cm | 5'11" = 180cm | 6'7" = 201cm |
| 2'1 1/2" = 65cm | 3'10" = 116cm | 6'0" = 182cm | 6'9" = 206cm |
| 2'2 1/2" = 67cm | 3'11" = 119cm | 6'2" = 189cm | 6'11" = 210cm |
| 2'3" = 69cm | 4'7" = 140cm | 6'4" = 192cm | |
| 2'6" = 75cm | 5'10" = 178cm | 6'6" = 197cm | |

HEATING & PLUMBING

- Carver 1800 Space Heater (Silhouette, Coronette, Corvette, Duette, Pirouette)
- Carver 3600 space heater (Alouette, Baronette, Doublette)
- Fanmaster and ducted blown air
- Inboard rigid piped pressurised water system
- Fitted shower and vanity unit
- Thetford cassette toilet

New for 1997

- 3600 Space Heater with electronic ignition (Alouette, Baronette and Doublette)
- Carver rapid gas/electric powered water heater

ELECTRICAL

- Mains electrics with two 230v sockets
- TV Station with 230v/12v/aerial connection point
- 12v and 230v reading lights
- Switch mode charger/transformer
- 25 metre mains hook up cable

New for 1997

- Modular electrical control console with ELCB

FITTINGS & EQUIPMENT

- Double glazing with night latch ventilation
- Full window blinds and flyscreens to all opening windows
- Roof lights with night blinds and flyscreens (to main compartment)
- Pull out roller slatted bed
- Concealed metal wall plates for secure furniture fixing

New for 1997

- Solid ash framed furniture doors

SECURITY

- Single key high security locks
- Identity number etched to windows and stamped on chassis

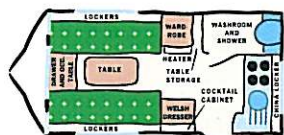

SILHOUETTE

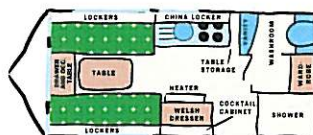

CORONETTE

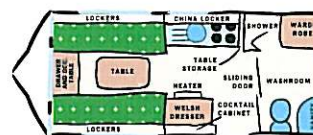

DUETTE

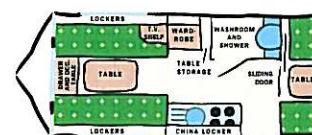

CORVETTE

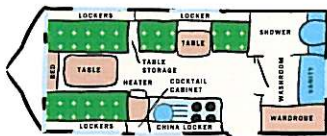

PIROUETTE



ALOUETTE

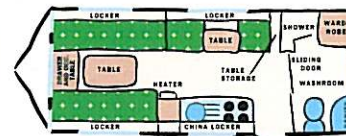

BARONETTE

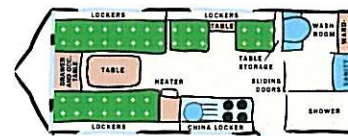

DOUBLETTE

Note:

- All models have L shaped front option except Pirouette.
- Alouette has L shaped back option.

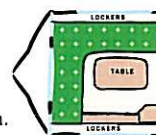

L SHAPE FRONT

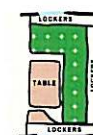

L SHAPE BACK

| MODEL | SILHOUETTE | CORONETTE | DUETTE | CORVETTE | PIROUETTE | ALOUETTE | BARONETTE | DOUBLETTE |
|--------------------------------------|----------------|----------------|----------------|----------------|----------------|----------------|----------------|----------------|
| BERTHS | 2 | 2 | 2 | 2-4 | 2-4 | 2-5 | 2-4 | 2-4 |
| INTERNAL LENGTH (AT BED BOX HEIGHT) | 3.94m/12'11" | 4.52/14'10" | 4.62m/15'2" | 4.62m/15'2" | 4.70m/15'5" | 5.03m/16'6" | 5.23m/17'2" | 5.23m/17'2" |
| OVERALL WIDTH | 2.13m/7'0" | 2.13m/7'0" | 2.13m/7'0" | 2.13m/7'0" | 2.13m/7'0" | 2.13m/7'0" | 2.13m/7'0" | 2.13m/7'0" |
| OVERALL HEIGHT | 2.71m/8'11" | 2.71m/8'11" | 2.71m/8'11" | 2.71m/8'11" | 2.71m/8'11" | 2.71m/8'11" | 2.71m/8'11" | 2.71m/8'11" |
| OVERALL LENGTH | 5.34m/17'6" | 5.92m/19'5" | 6.02m/19'9" | 6.02m/19'9" | 6.10m/19'9" | 6.43m/21'1" | 6.63m/21'9" | 6.63m/21'9" |
| EX-WORKS WEIGHT (SEE NOTE) | 760kg/14.9cwt | 840kg/16.5cwt | 850kg/16.7cwt* | 875kg/17.2cwt* | 865kg/17cwt | 940kg/18.4cwt | 950kg/18.7cwt* | 960kg/18.9cwt* |
| MAXIMUM AUTHORISED WEIGHT | 950kg/18.7cwt | 1060kg/20.8cwt | 1060kg/20.8cwt | 1100kg/21.6cwt | 1100kg/21.7cwt | 1160kg/22.8cwt | 1200kg/23.6cwt | 1200kg/23.6cwt |
| CARAVAN ALLOWABLE PAYLOAD | 165kg/3.2cwt | 195kg/3.8cwt | 185kg/3.6cwt | 195kg/3.8cwt | 210kg/4.1cwt | 190kg/3.7cwt | 220kg/4.3cwt | 210kg/4.1cwt |
| MAXIMUM TECHNICAL PERMISSIBLE WEIGHT | 1060kg/20.8cwt | 1060kg/20.8cwt | 1300kg/25.6cwt | 1300kg/25.6cwt | 1300kg/25.6cwt | 1300kg/25.6cwt | 1300kg/25.6cwt | 1300kg/25.6cwt |
| AWNING SIZE GROUND TO GROUND | 8.15m/26'8" | 8.73m/28'8" | 8.8m/28'11" | 8.8m/28'11" | 8.9m/29'2" | 9.25m/30'4" | 9.45m/31'0" | 9.45m/31'0" |
| TYRE SIZES | 175 R13 4 ply | 175 R13 4 ply | 175 R13 6 ply | 175 R13 6 ply | 175 R13 6 ply | 175 R13 6 ply | 175 R13 6 ply | 175 R13 6 ply |

Note: A tolerance of 3% in the ex-works weight has been allowed for in the calculation of payload margins (i.e. Maximum Authorised Weight = Payload + Ex-works weight plus 3%).

* Estimated

BED SIZES

SILHOUETTE

| | |
|-----------|-----------------|
| Singles | 6'4" x 2'0 1/2" |
| or double | 6'7" x 6'4" |

CORONETTE

| | |
|-----------|-----------------|
| Singles | 6'4" x 2'0 1/2" |
| and | 6'0" x 2'0 1/2" |
| or double | 6'7" x 6'0" |

DUETTE

| | |
|-----------|-----------------|
| Singles | 6'4" x 2'0 1/2" |
| and | 6'0" x 2'0 1/2" |
| or double | 6'7" x 6'0" |

CORVETTE

| | |
|--------------|-----------------|
| Front single | 6'4" x 2'0 1/2" |
| or double | 6'7" x 2'0 1/2" |
| Rear single | 6'7" x 2'6" |
| Bunk | 6'7" x 1'11" |

PIROUETTE

| | |
|--------------|------------------|
| Front double | 6'7" x 4'7" |
| Side single | 5'11" x 2'2 1/2" |
| Bunk | 5'10" x 1'11" |

ALOUETTE

| | |
|--------------|------------------|
| Front single | 6'4" x 2'0 1/2" |
| or double | 6'7" x 6'4" |
| Rear double | 6'7" x 3'11" |
| Bunk | 6'6 1/2" x 1'11" |

BARONETTE/DOUBLETTE

| | |
|--------------|------------------|
| Front single | 6'4" x 2'0 1/2" |
| and | 6'0" x 2'0 1/2" |
| or double | 6'7" x 6'0" |
| Side single | 5'11" x 2'2 1/2" |
| Bunk | 5'10" x 1'11" |



YOUR LOCAL DEALER

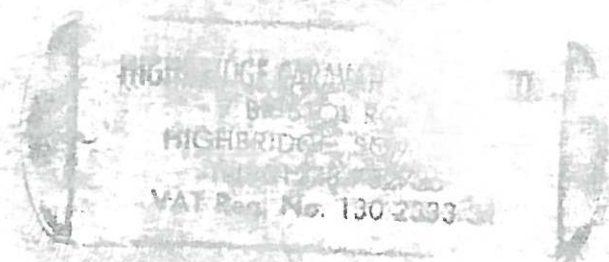

INVESTOR IN PEOPLE



SWIFT CARAVANS, DUNSWELL ROAD, COTTINGHAM, EAST YORKSHIRE HU16 4JX. TEL: 01482 847332 FAX: 01482 841042

This brochure does not constitute an offer by Swift Group Limited (Swift). Swift reserves the right to alter specifications and prices at any time as materials and conditions demand. Distributors and dealers sell Swift products on their own account and not as agents of Swift. Accordingly, they have no authority to bind Swift or to make any representation or undertaking whatsoever on behalf of Swift.

The touring caravans described in this brochure are designated by their model year. The model year runs from 1 September to 31 August and the despatch of 1997 models will have commenced on or after 1 September 1996.

Cars supplied by Vauxhall Motors. Props supplied by Hammonds, part of the House of Fraser.
Our thanks to the West of Scotland Water Authority for the use of the land surrounding Loch Katrine in the Trossachs,
the Authority's major water catchment for the Glasgow area.